

INDEX FOR P.L. 94-171 COUNTY BLOCK MAP (CENSUS 2000)

INDEX MAP LEGEND

SYMBOL	NAME STYLE
*****	INTERNATIONAL
-----	AIR (FEDERAL)
-----	Trust Land/HLL
-----	OTSA/ANVSA/TDSA
-----	TRIBAL SUBDIVISION
-----	AIR (State)
-----	SDA/SA
-----	ANRC
#####	STATE
#####	COUNTY
#####	MINOR CIVIL DIV. ¹
#####	Consolidated City
#####	Incorporated Place ¹
#####	Census Designated Place ¹
[Inset]	Inset
[Out Area]	Out Area

Abbreviation Reference: AIR - American Indian Reservation; Trust Land - Off-Reservation Trust Land; ANRC - Alaska Native Regional Corporation; TDS - Tribal Designated Statistical Area; FRTSA - Federal Reservation Trust Land; SDA/SA - State Designated American Indian Statistical Area; ANVSA - Alaska Native Village Statistical Area; OTSA - Oklahoma Tribal Statistical Area; American Indian Tribal Subdivision - American Indian Tribal Subdivision; ANRC - Alaska Native Regional Corporation

¹ A "*" following a place name indicates that the place is coextensive with a MCD. A "C" indicates that the place is also a false MCD. In both cases, the MCD name is shown only when it differs from the place name.

P.L. 94-171 COUNTY BLOCK MAP LEGEND (CENSUS 2000)

SYMBOL DESCRIPTION	SYMBOL	NAME STYLE
International	*****	CANADA
American Indian Reservation (Federal)	*****	L'ANSE RES (1880)
Off-Reservation Trust Land, Hawaiian Home Land	*****	T1880
Oklahoma Tribal Statistical Area, Alaska Native Village Statistical Area, Tribal Designated Statistical Area	*****	KAW OTSA (5340)
American Indian Tribal Subdivision	*****	SHONTO (620)
American Indian Reservation (State)	*****	Tama Res (4125)
State Designated American Indian Statistical Area	*****	Lumbee (9815)
Alaska Native Regional Corporation	*****	NANA ANRC 52120
State or Statistically Equivalent Entity	*****	NEW YORK 36
County or Statistically Equivalent Entity	*****	ERIE 029
Minor Civil Division (MCD) ¹	*****	PIKE TWP 59742
Census County Division (CCD)	*****	KULA CCD 91890
Consolidated City	*****	Milford 47500
Incorporated Place ¹	*****	Rome 63418
Census Designated Place (CDP) ¹	*****	Zena 84187
Corporate Offset Boundary	*****	
Voting District (VTD) ²	*****	023*
Census Tract	*****	5702.01
Block ³	*****	1320

FEATURE	SYMBOL	FEATURE	SYMBOL
Interstate or Other Highway	-----	Perennial Stream or Shoreline	Tumling Cr.
Secondary Road	-----	Intermittent Stream or Shoreline	Flow Cr.
Leap Trail, Walkway, Stairway, or Ferry	-----	Large River or Lake	Winnipeg Lake
Railroad	-----	Glacier	Bering Glacier
Pipelining or Power Line	-----	Military Installation	Fort Belvoir
Ridge, Fence, or Other Physical Feature	-----	Inset Area	A
Property Line or Fence Line	-----	Outside Subject Area	
Nonvisible Boundary or Feature Not Elsewhere Classified	-----		

Where international, state, and/or county boundaries coincide, the map shows the boundary symbol for only the highest-ranking of these boundaries.

¹ A "*" following a place name indicates that the place is coextensive with a MCD. A "C" following an incorporated place name indicates that the place is also a false MCD. In both cases, the MCD name is shown only when it differs from the place name.

² A "*" following a VTD code indicates an actual voting district. Its absence indicates that the VTD is a pseudo voting district or no information is available as to its status.

³ A "*" following a block number indicates that the block number is repeated elsewhere in the block.

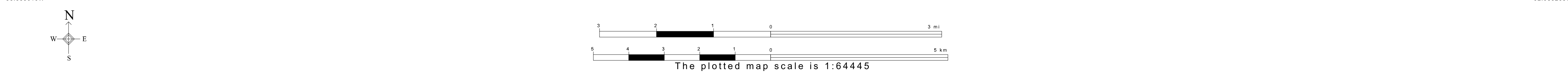
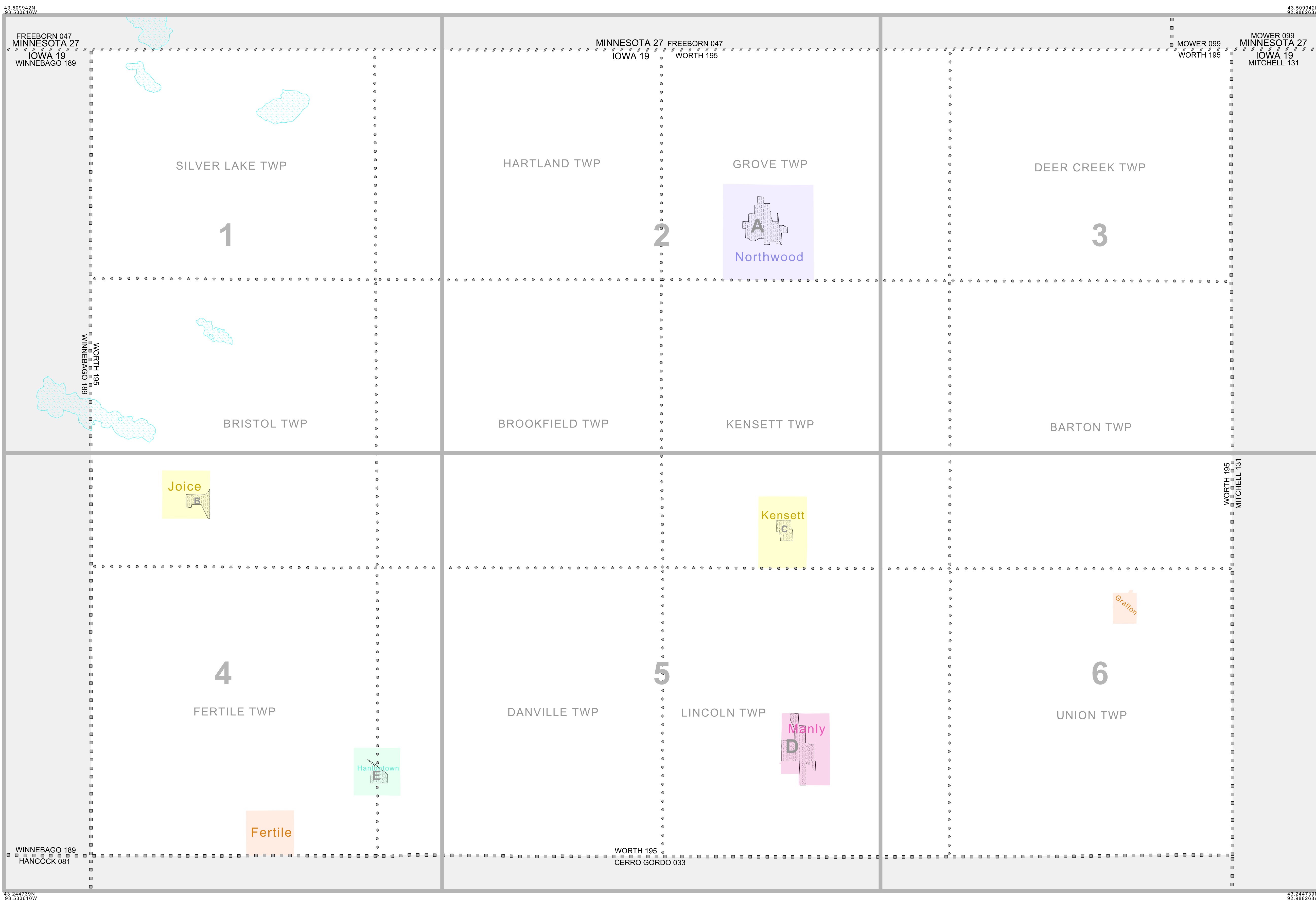

All legal boundaries and names are as of January 1, 2000. The boundaries shown on this map are for Census Bureau statistical data collection and tabulation purposes only; their depiction and designation for statistical purposes does not constitute a determination of jurisdictional authority or rights of ownership or entitlement. U.S. DEPARTMENT OF COMMERCE Economics and Statistics Administration U.S. Census Bureau

ST: Iowa (19)
 COU: Worth (195)
 INDEX MAP (TOTAL PARENT SHEETS 6 TOTAL INSET SHEETS 5)



P.L. 94-171 COUNTY BLOCK MAP LEGEND (CENSUS 2000)

<u>SYMBOL DESCRIPTION</u>	<u>SYMBOL</u>	<u>NAME STYLE</u>
International	☆☆☆☆☆☆	CANADA
American Indian Reservation (Federal)	☆☆☆☆☆☆	L'ANSE RES (1880)
Off-Reservation Trust Land, Hawaiian Home Land	☆☆☆☆☆☆	T1880
Oklahoma Tribal Statistical Area, Alaska Native Village Statistical Area, Tribal Designated Statistical Area	◆◆◆◆◆◆◆	KAW OTSA (5340)
American Indian Tribal Subdivision	◆◆◆◆◆◆◆	SHONTO (620)
American Indian Reservation (State)	// // // // // //	Tama Res (4125)
State Designated American Indian Statistical Area	◇◇◇◇◇◇◇	Lumbee (9815)
Alaska Native Regional Corporation	▽ ▲ ▽ ▲ ▽ ▲ ▽	NANA ANRC 52120
State or Statistically Equivalent Entity	// // // // // //	NEW YORK 36
County or Statistically Equivalent Entity	■ ■ ■ ■ ■ ■ ■	ERIE 029
Minor Civil Division (MCD) ¹	⬢ ⬢ ⬢ ⬢ ⬢ ⬢ ⬢	PIKE TWP 59742
Census County Division (CCD)	⬢ ⬢ ⬢ ⬢ ⬢ ⬢ ⬢	KULA CCD 91890
Consolidated City	○ ○ ○ ○ ○ ○ ○	Milford 47500
Incorporated Place ¹		Rome 63418
Census Designated Place (CDP) ¹		Zena 84187
Corporate Offset Boundary	
Voting District (VTD) ²	● ● ● ● ● ● ●	023*
Census Tract		5702.01
Block ³		1326

<u>FEATURE</u>	<u>SYMBOL</u>	<u>FEATURE</u>	<u>SYMBOL</u>
Interstate or Other Highway		Perennial Stream or Shoreline	
Secondary Road		Intermittent Stream or Shoreline	
Jeep Trail, Walkway, Stairway, or Ferry		Large River or Lake	
Railroad		Glacier	
Pipeline or Power Line		Military Installation	
Ridge, Fence, or Other Physical Feature		Inset Area	
Property Line or Fence Line		Outside Subject Area	
Nonvisible Boundary or Feature Not Elsewhere Classified			

Where international, state, and/or county boundaries coincide, the map shows the boundary symbol for only the highest-ranking of these boundaries.

¹ A ' * ' following a place name indicates that the place is coextensive with a MCD. A ' ° ' following an incorporated place name indicates that the place is also a false MCD. In both cases, the MCD name is shown only when it differs from the place name.

² A ' * ' following a VTD code indicates an actual voting district. Its absence indicates that the VTD is a pseudo voting district or no information is available as to its status.

³ A ' * ' following a block number indicates that the block number is repeated elsewhere in the block.

P. L. 94-171 COUNTY BLOCK MAP (CENSUS 2000)

43 509944N
93 533810W

43 509944N
93 531828W

FREEBORN 047 MINNESOTA 27
WINNEBAGO 189 IOWA 19

MINNESOTA 27 FREEBORN 047
IOWA 19 WORTH 195

GEOGRAPHIC AREAS LEGEND

SYMBOL	NAME STYLE
*****	INTERNATIONAL
*****	AIR (FEDERAL)
*****	Trust Land
*****	STATE
*****	COUNTY
*****	MINOR CIVIL DIV.
*****	Incorporated Place ¹
*****	Census Designated Place ¹
*****	Corporate Offset Boundary
*****	Voting District ²
*****	Census Tract
*****	BLOCK ³

Military Inset Out Area

Abbreviation Reference: AIR = American Indian Reservation; Trust Land = Off-Reservation Trust Land

1 A "*" following a place name indicates that the place is coextensive with a MCD. A "-" indicates that the place differs from the place name.
 2 A "*" following a VTD code indicates an actual voting district. Its absence indicates that the VTD is a pseudo voting district or no information is available as to its status.
 3 A "*" following a block number indicates that the block number is repeated elsewhere in the block.

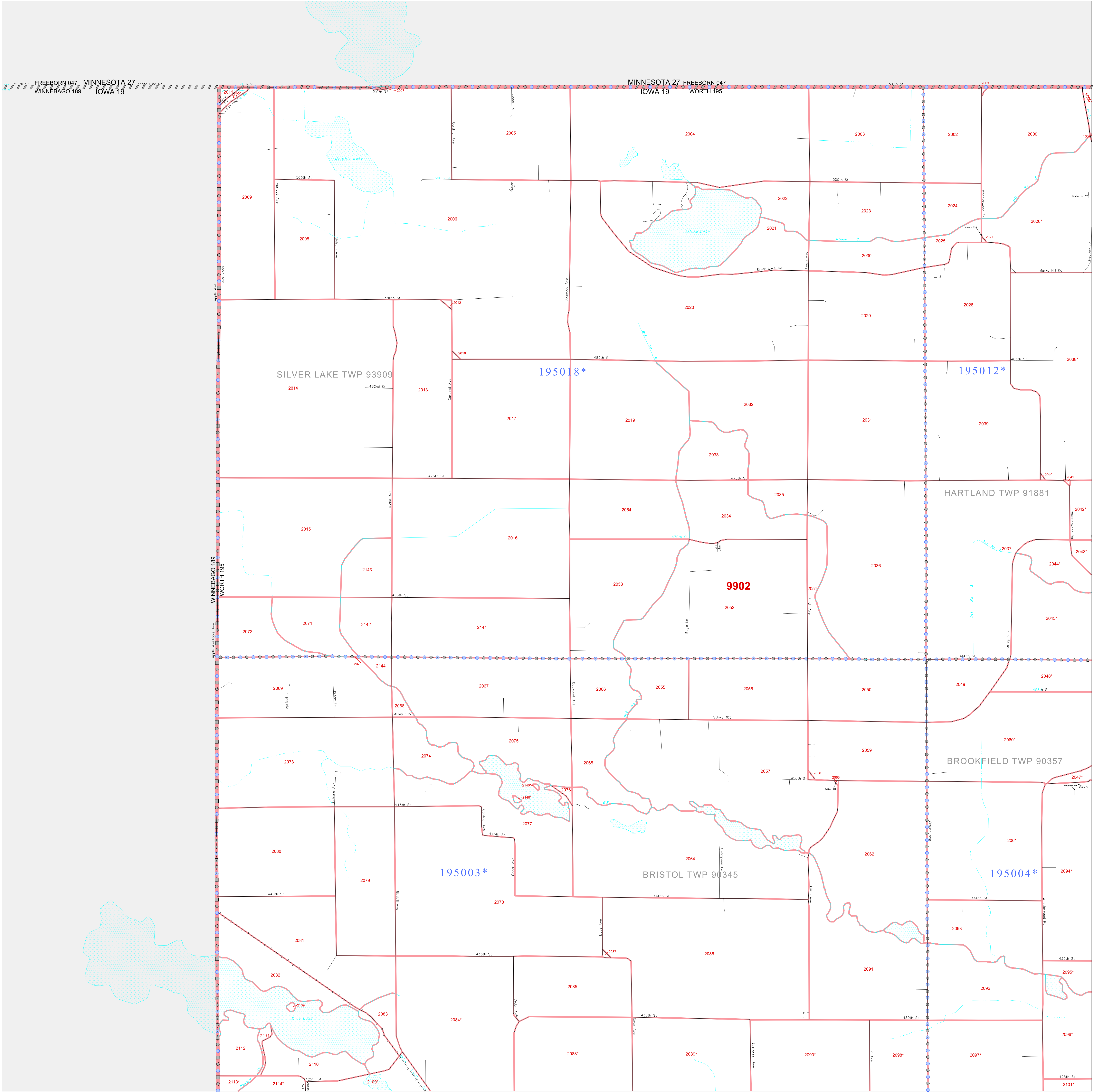

43 377341N
93 533810W

43 377341N
93 531828W

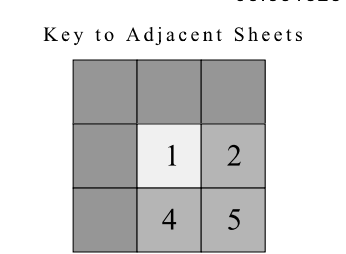
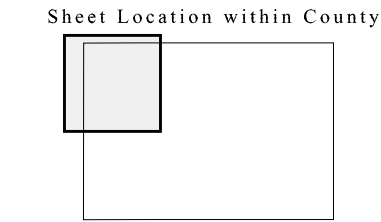
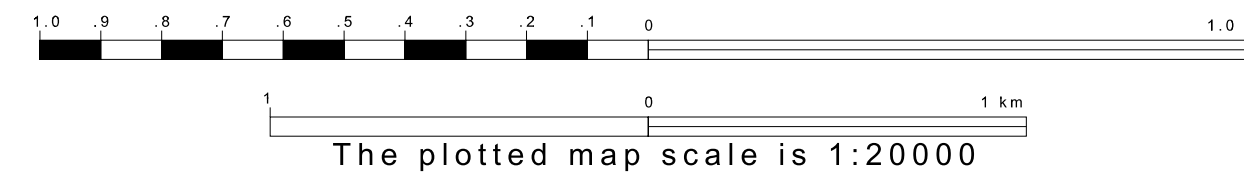
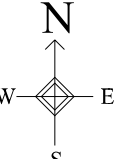

ST: Iowa (19)
COU: Worth (195)
SHEET 1 OF 6 PARENT SHEETS

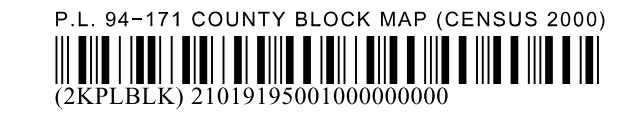

All legal boundaries and names are as of January 1, 2000. The boundaries shown on this map are for Census Bureau statistical data collection and tabulation purposes only; their depiction and designation for statistical purposes does not constitute a determination of jurisdictional authority or rights of ownership or entitlement. U.S. DEPARTMENT OF COMMERCE Economics and Statistics Administration U.S. Census Bureau

P. L. 94-171 COUNTY BLOCK MAP (CENSUS 2000)

43 377341N
93 533810W

43 377341N
93 531828W

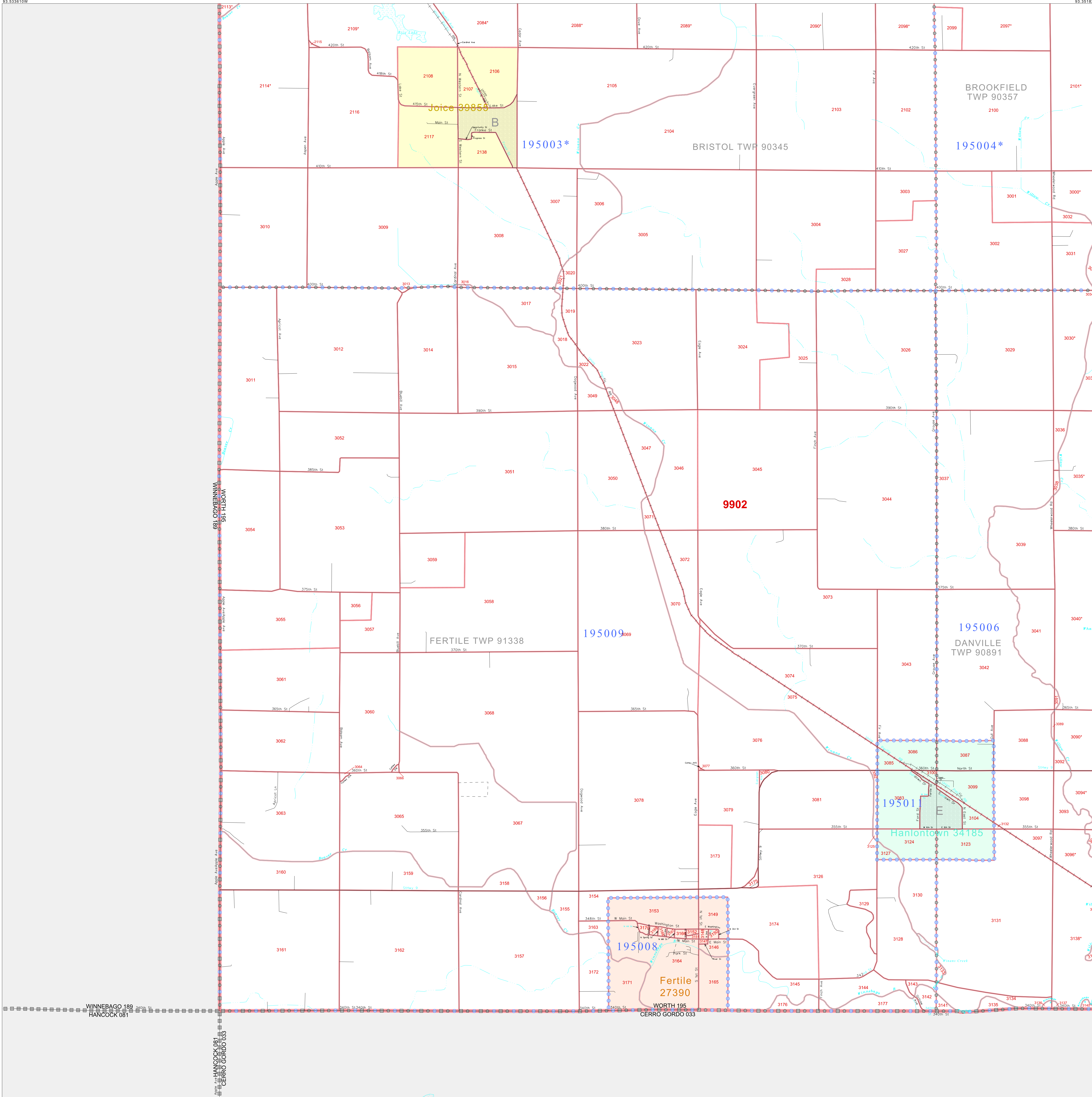

GEOGRAPHIC AREAS LEGEND

SYMBOL	NAME STYLE
*****	INTERNATIONAL
*****	AIR (FEDERAL)
*****	Trust Land
*****	Trust Land
*****	STATE
*****	COUNTY
*****	MINOR CIVIL DIV.
*****	Incorporated Place ¹
*****	Census Designated Place ¹
*****	Corporate Offset Boundary
*****	Voting District ²
*****	Census Tract
*****	BLOCK ³

Military Inset Out Area

Abbreviation Reference: AIR = American Indian Reservation; Trust Land = Off-Reservation Trust Land

1 A "*" following a place name indicates that the place is coterminous with a MCD. A "-" indicates that the place differs from the MCD. In both cases, the MCD name is shown only when it differs from the place name.
 2 A "*" following a VTD code indicates an actual voting district. Its absence indicates that the VTD is a pseudo voting district or no information is available as to its status.
 3 A "*" following a block number indicates that the block number is repeated elsewhere in the block.

43 244738N
93 533610W

43 244738N
93 531828W

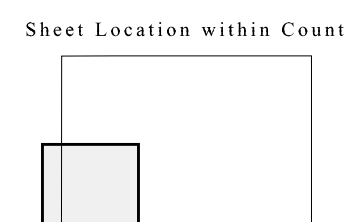
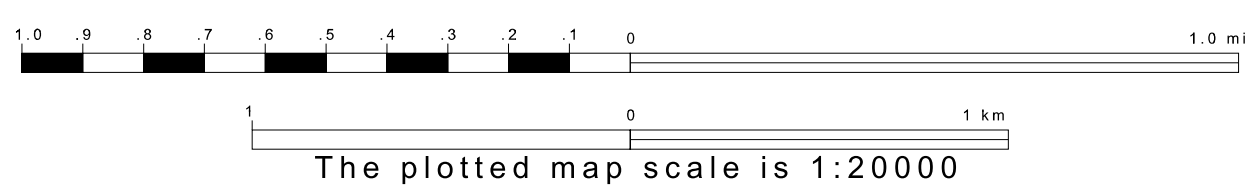
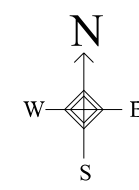

Key to Adjacent Sheets

1	2
4	5

ST: Iowa (19)
COU: Worth (195)
SHEET 4 OF 6 PARENT SHEETS

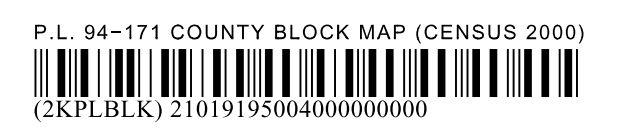

All legal boundaries and names are as of January 1, 2000. The boundaries shown on this map are for Census Bureau statistical data collection and tabulation purposes only; their depiction and designation for statistical purposes does not constitute a determination of jurisdictional authority or rights of ownership or entitlement. U.S. DEPARTMENT OF COMMERCE Economics and Statistics Administration U.S. Census Bureau

P. L. 94-171 COUNTY BLOCK MAP (CENSUS 2000)

43 377341N
93 170047W

43 377341N
92 982266W

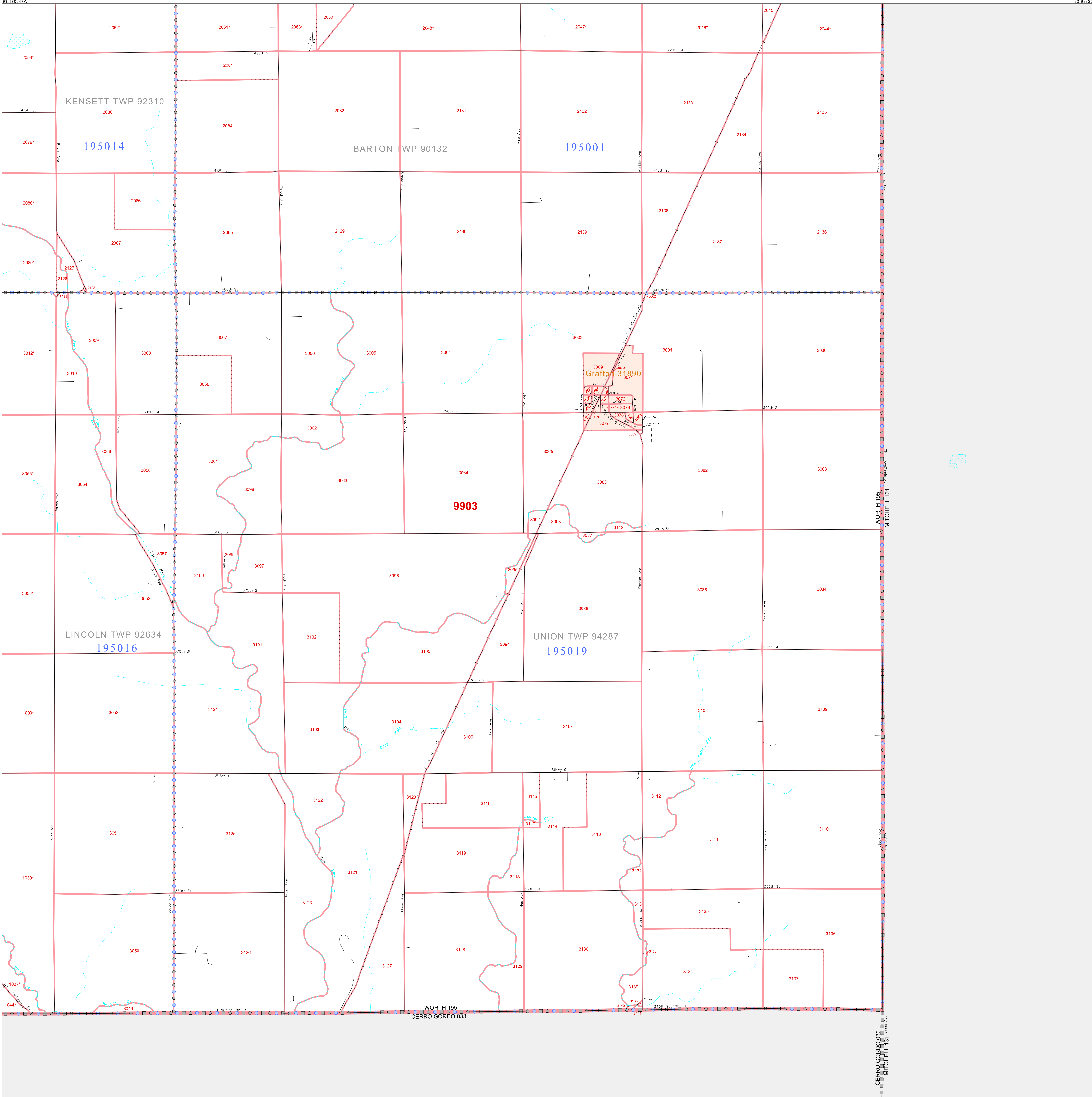

GEOGRAPHIC AREAS LEGEND

SYMBOL	NAME STYLE
*****	INTERNATIONAL
*****	AIR (FEDERAL)
*****	Trust Land
*****	STATE
*****	COUNTY
*****	MINOR CIVIL DIV.
*****	Incorporated Place ¹
*****	Census Designated Place ¹
*****	Corporate Offset Boundary
*****	Voting District ²
*****	Census Tract
*****	BLOCK ³

Abbreviation Reference: AIR = American Indian Reservation; Trust Land = Off-Reservation Trust Land

1 A "*" following a place name indicates that the place is coterminous with a MCD. A "-" indicates that the place differs from the MCD. In both cases, the MCD name is shown only when it differs from the place name.

2 A "*" following a VTD code indicates an actual voting district. Its absence indicates that the VTD is a pseudo voting district or no information is available as to its status.

3 A "*" following a block number indicates that the block number is repeated elsewhere in the block.

Inset Out Area

43 244738N
93 170047W

43 244738N
92 982266W

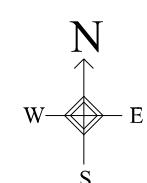

The plotted map scale is 1:20000

Sheet Location within County

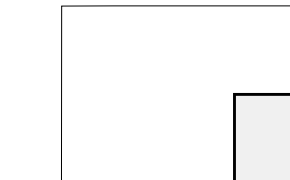

Key to Adjacent Sheets

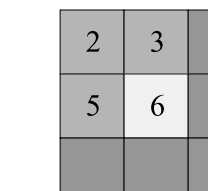

ST: Iowa (19)
COU: Worth (195)
SHEET 6 OF 6 PARENT SHEETS



P. L. 94-171 COUNTY BLOCK MAP (CENSUS 2000)

GEOGRAPHIC AREAS LEGEND

SYMBOL	NAME STYLE
*****	INTERNATIONAL
*****	AIR (FEDERAL)
*****	Trust Land
///////	STATE
	COUNTY
o-o-o-o-o	MINOR CIVIL DIV¹
Yellow	Incorporated Place¹
Light Green	Census Designated Place¹
Red Dotted	Corporate Offset Boundary
Blue Dotted	Voting District²
Red Solid	Census Tract
Red Dashed	BLOCK³

Military Inset Out Area

Abbreviation Reference: AIR = American Indian Reservation; Trust Land = Off-Reservation Trust Land

1 A "*" following a place name indicates that the place is coterminous with a MCD. A "-" indicates that the place differs from the MCD. In both cases, the MCD name is shown only when it differs from the place name.

2 A "*" following a VTD code indicates an actual voting district. Its absence indicates that the VTD is a pseudo voting district or no information is available as to its status.

3 A "*" following a block number indicates that the block number is repeated elsewhere in the block.

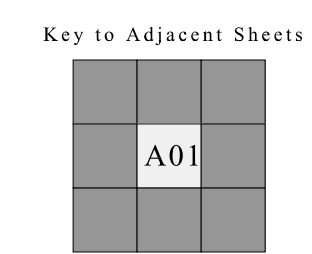
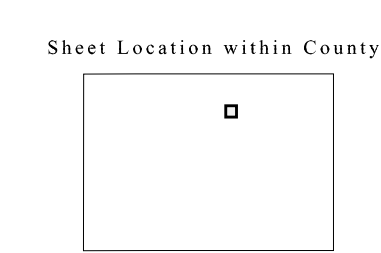
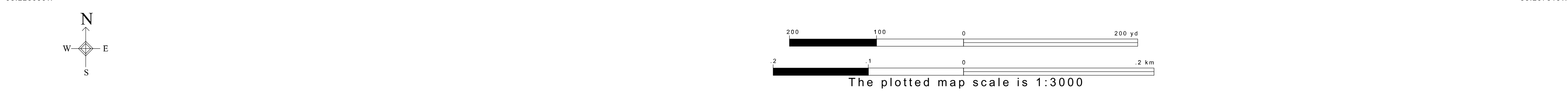
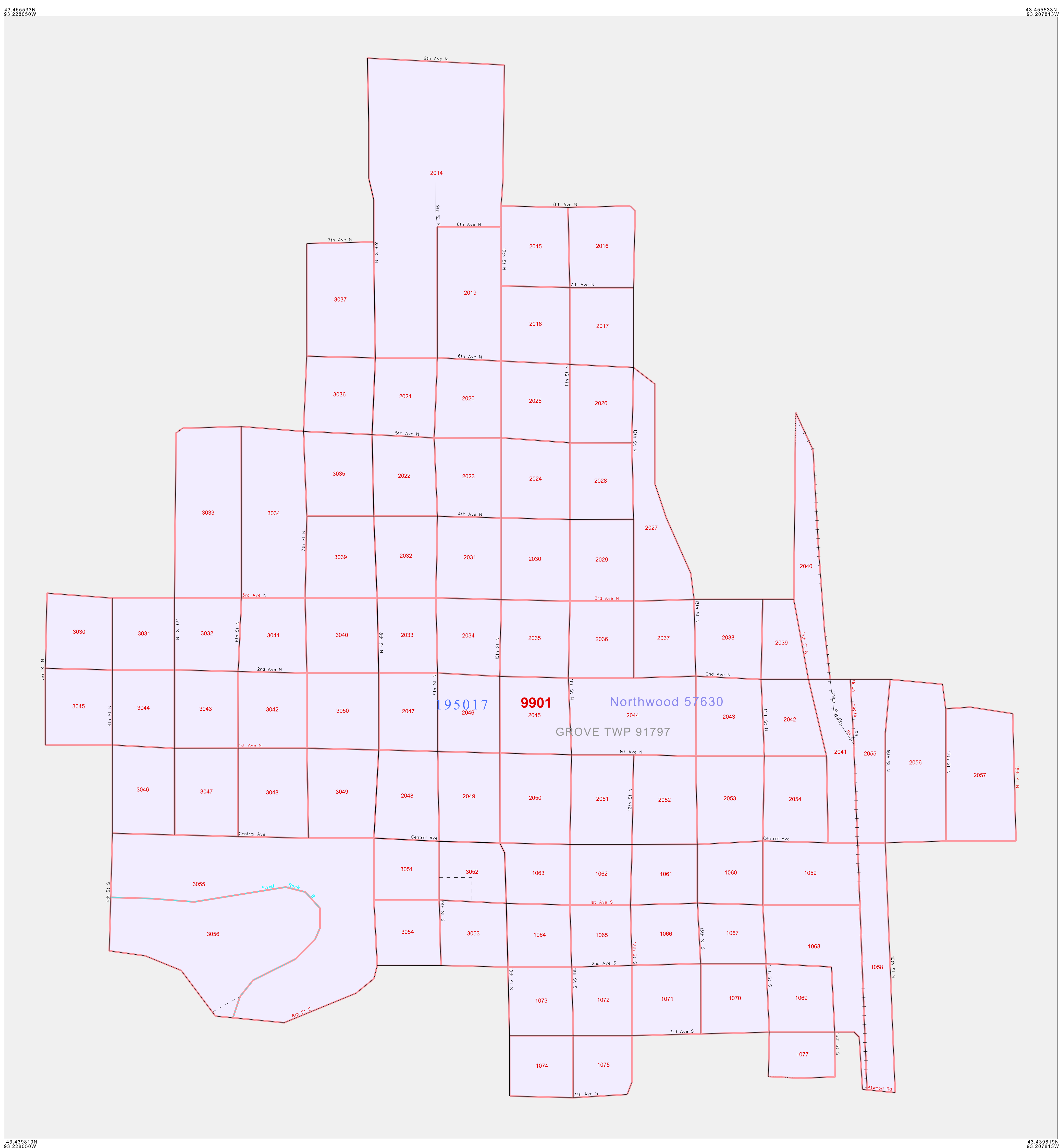

ST: Iowa (19)
 COU: Worth (195)
 INSET SHEET A01



All legal boundaries and names are as of January 1, 2000. The boundaries shown on this map are for Census Bureau statistical data collection and tabulation purposes only; their depiction and designation for statistical purposes does not constitute a determination of jurisdictional authority or rights of ownership or entitlement. U.S. DEPARTMENT OF COMMERCE Economics and Statistics Administration U.S. Census Bureau

P. L. 94-171 COUNTY BLOCK MAP (CENSUS 2000)

GEOGRAPHIC AREAS LEGEND

SYMBOL	NAME STYLE
*****	INTERNATIONAL
*****	AIR (FEDERAL)
*****	Trust Land
///////	STATE
	COUNTY
○○○○○	MINOR CIVIL DIV. ¹
■■■■■	Incorporated Place ¹
■■■■■	Census Designated Place ¹
.....	Corporate Offset Boundary
●●●●●	Voting District ²
————	Census Tract
————	BLOCK ³

Military Inset Out Area

Abbreviation Reference: AIR = American Indian Reservation; Trust Land = Gift/Reservation Trust Land

1 A "*" following a place name indicates that the place is coterminous with a MCD. A "-" indicates that the place differs from the MCD. In both cases, the MCD name is shown only when it differs from the place name.

2 A "*" following a VTD code indicates an actual voting district. Its absence indicates that the VTD is a pseudo voting district or no information is available as to its status.

3 A "*" following a block number indicates that the block number is repeated elsewhere in the block.

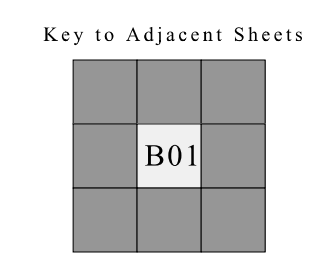
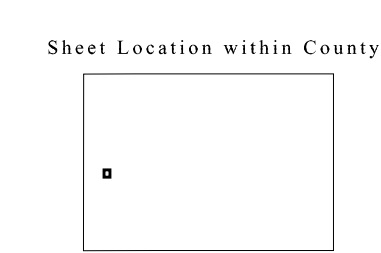
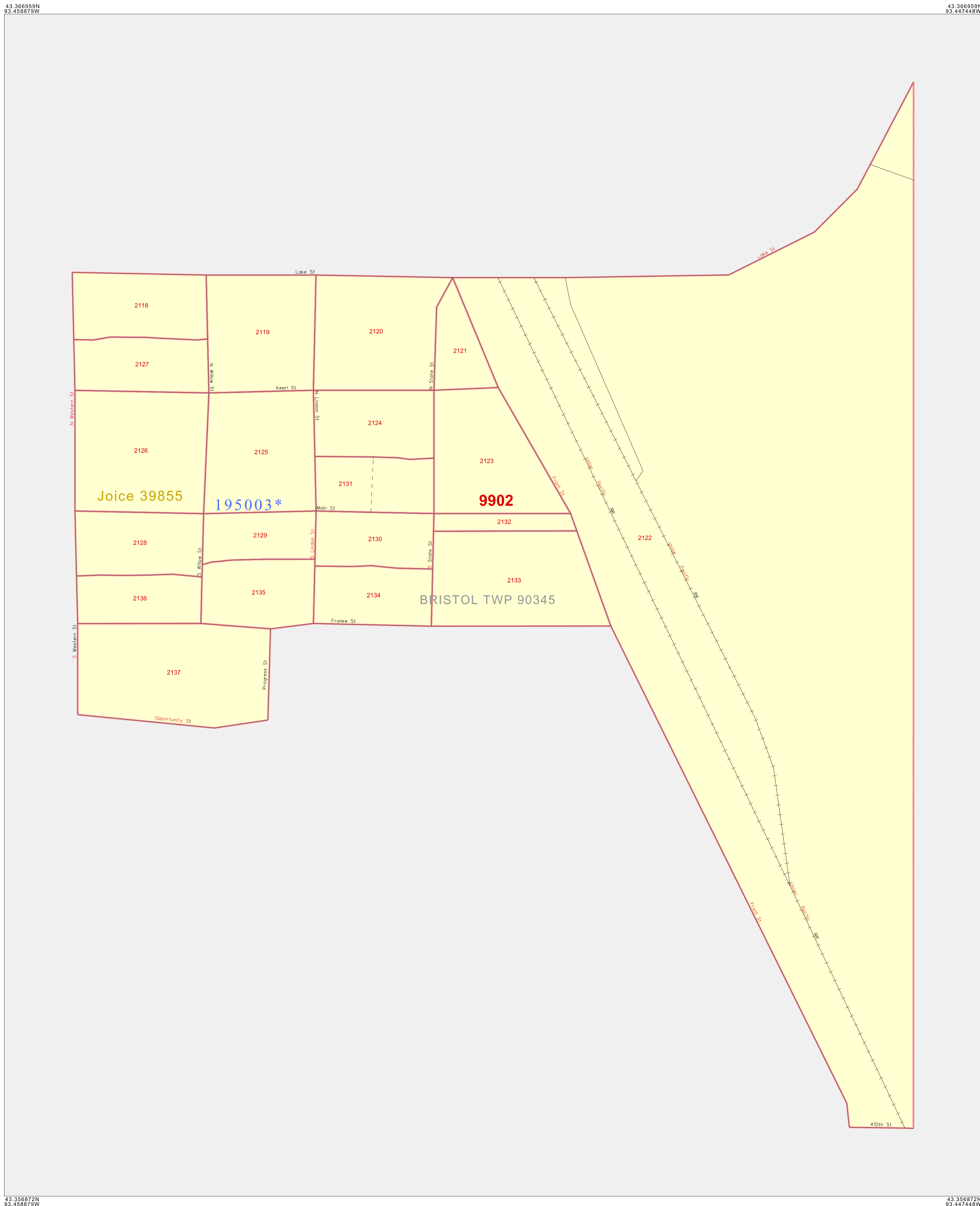

ST: Iowa (19)
 COU: Worth (195)
 INSET SHEET B01



All legal boundaries and names are as of January 1, 2000. The boundaries shown on this map are for Census Bureau statistical data collection and tabulation purposes only; their depiction and designation for statistical purposes does not constitute a determination of jurisdictional authority or rights of ownership or entitlement. U.S. DEPARTMENT OF COMMERCE Economics and Statistics Administration U.S. Census Bureau

P. L. 94-171 COUNTY BLOCK MAP (CENSUS 2000)

GEOGRAPHIC AREAS LEGEND

SYMBOL	NAME STYLE
*****	INTERNATIONAL
*****	AIR (FEDERAL)
*****	Trust Land
//////	STATE
	COUNTY
o-o-o-o	MINOR CIVIL DIV. ¹
Yellow	Incorporated Place ¹
Light Green	Census Designated Place ¹
Red Dashed	Corporate Offset Boundary
Blue Dotted	Voting District ²
Red Solid	Census Tract
Red Solid	BLOCK ³

Military Inset Out Area

Abbreviation Reference: AIR = American Indian Reservation; Trust Land = Off-Reservation Trust Land

1 A "*" following a place name indicates that the place is coterminous with a MCD. A "-" indicates that the place differs from the MCD. In both cases, the MCD name is shown only when it differs from the place name.
 2 A "*" following a VTD code indicates an actual voting district. Its absence indicates that the VTD is a pseudo voting district or no information is available as to its status.
 3 A "*" following a block number indicates that the block number is repeated elsewhere in the block.

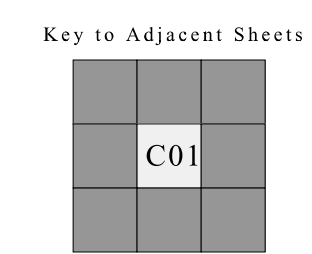
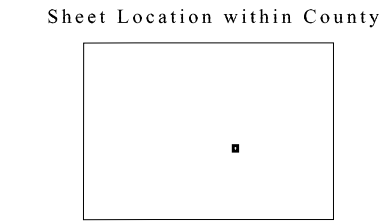
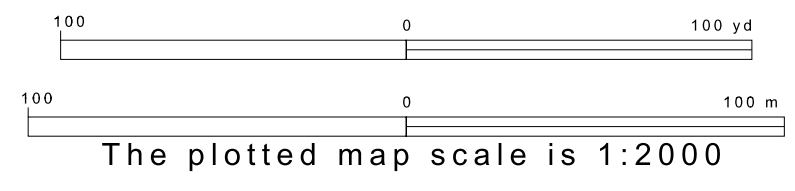
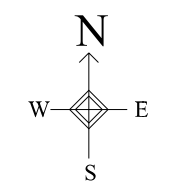
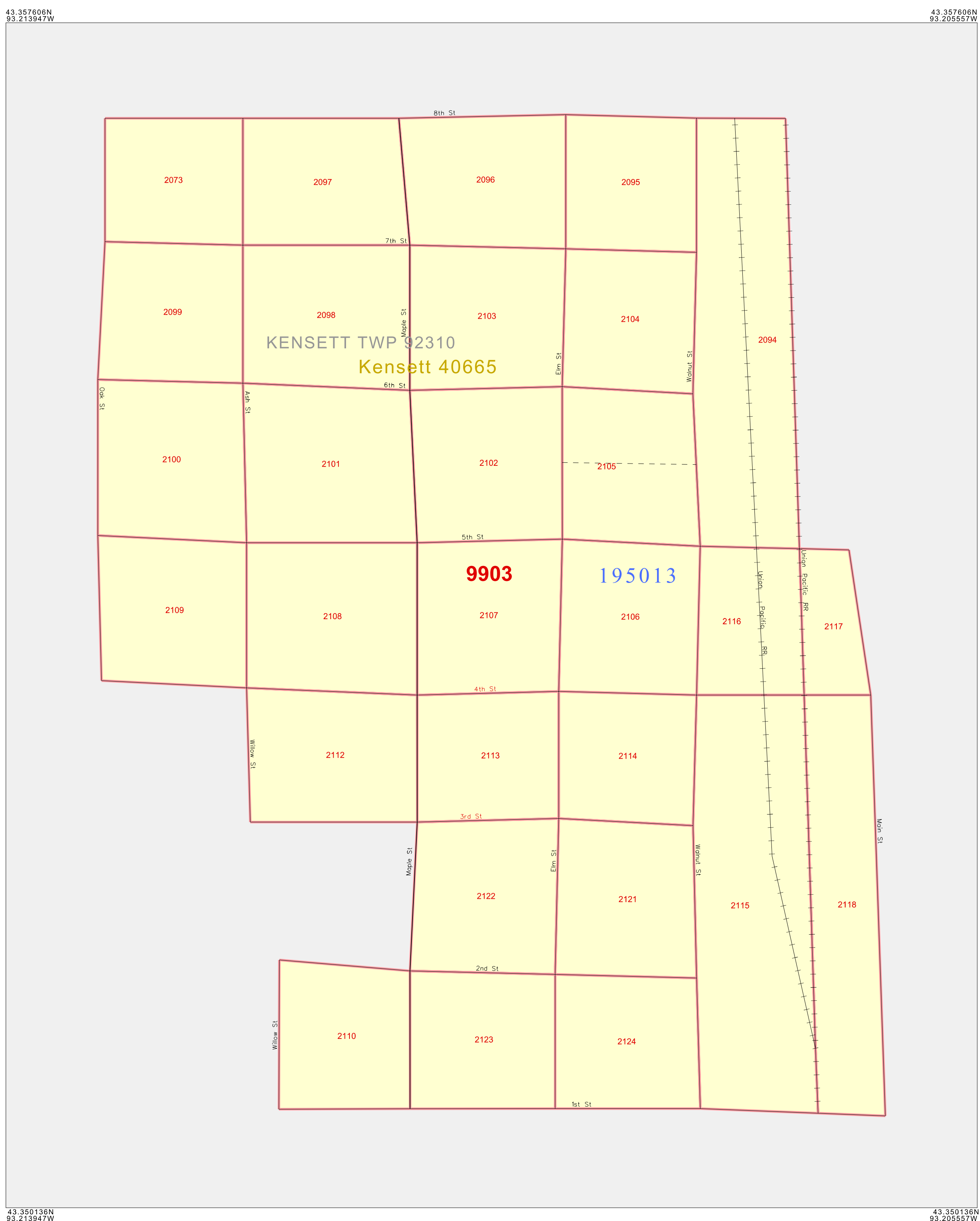

ST: Iowa (19)
 COU: Worth (195)
 INSET SHEET C01

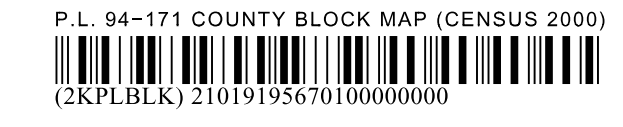

All legal boundaries and names are as of January 1, 2000.
 The boundaries shown on this map are for Census Bureau statistical data collection and tabulation purposes only; their depiction and designation for statistical purposes does not constitute a determination of jurisdictional authority or rights of ownership or entitlement.
 U.S. DEPARTMENT OF COMMERCE Economics and Statistics Administration U.S. Census Bureau

P. L. 94-171 COUNTY BLOCK MAP (CENSUS 2000)

GEOGRAPHIC AREAS LEGEND

SYMBOL	NAME STYLE
*****	INTERNATIONAL
*****	AIR (FEDERAL)
*****	Trust Land
//////	STATE
	COUNTY
o-o-o-o-o	MINOR CIVIL DIV. ¹
Yellow	Incorporated Place ¹
Light Green	Census Designated Place ¹
Red Dashed	Corporate Offset Boundary
Blue Dashed	Voting District ²
Red Solid	Census Tract
Blue Dashed	Military
Grey	Inset
White	Out Area

Abbreviation Reference: AIR = American Indian Reservation; Trust Land = Off-Reservation Trust Land

1 A "*" following a place name indicates that the place is coterminous with a MCD. A "-" indicates that the place differs from the MCD. In both cases, the MCD name is shown only when it differs from the place name.

2 A "*" following a VTD code indicates an actual voting district. Its absence indicates that the VTD is a pseudo voting district or no information is available as to its status.

3 A "*" following a block number indicates that the block number is repeated elsewhere in the block.

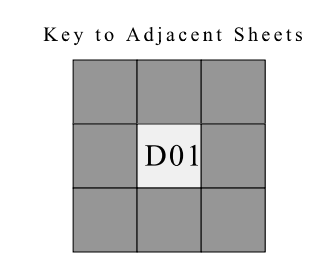
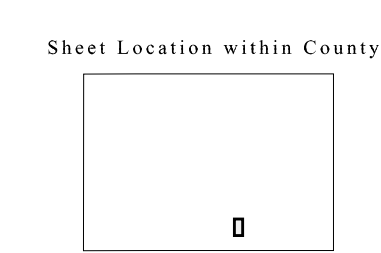
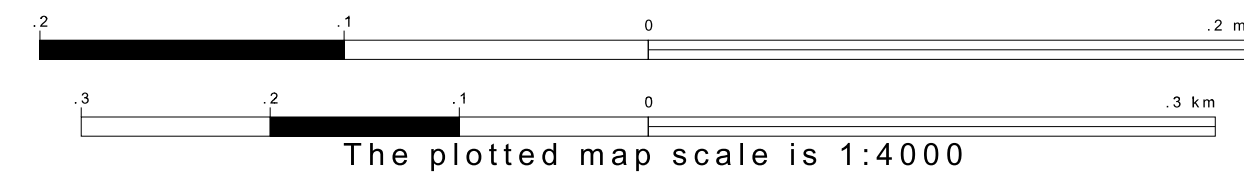
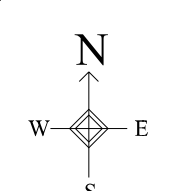
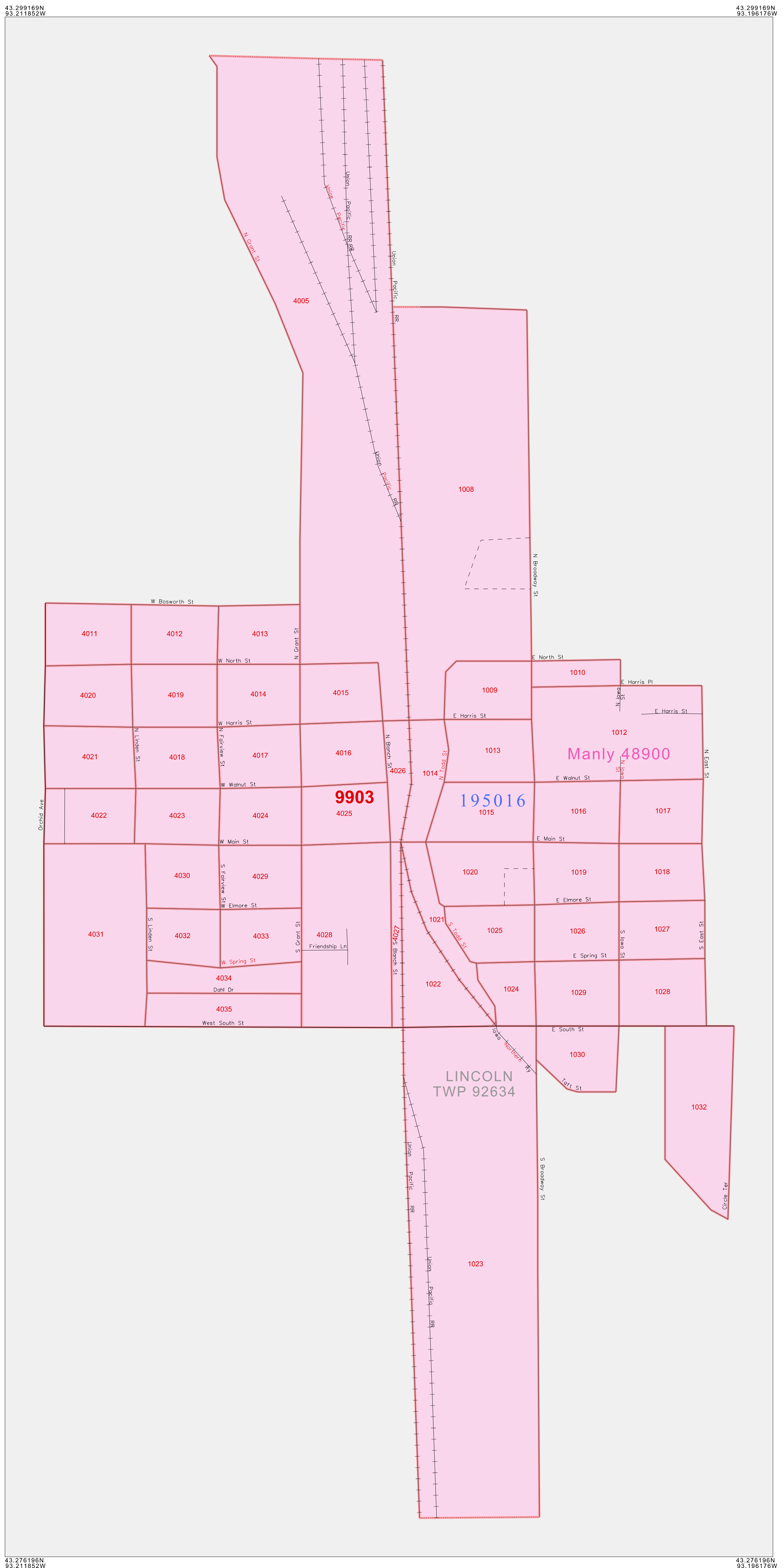

ST: Iowa (19)
 COU: Worth (195)
 INSET SHEET D01



All legal boundaries and names are as of January 1, 2000. The boundaries shown on this map are for Census Bureau statistical data collection and tabulation purposes only; their depiction and designation for statistical purposes does not constitute a determination of jurisdictional authority or rights of ownership or entitlement. U.S. DEPARTMENT OF COMMERCE Economics and Statistics Administration U.S. Census Bureau

P. L. 94-171 COUNTY BLOCK MAP (CENSUS 2000)

GEOGRAPHIC AREAS LEGEND

SYMBOL	NAME STYLE
*****	INTERNATIONAL
*****	AIR (FEDERAL)
*****	Trust Land
///////	STATE
	COUNTY
○○○○○	MINOR CIVIL DIV. ¹
■■■■■	Incorporated Place ¹
■■■■■	Census Designated Place ¹
.....	Corporate Offset Boundary
●●●●●	Voting District ²
————	Census Tract
————	BLOCK ³

Military Inset Out Area

Abbreviation Reference: AIR = American Indian Reservation; Trust Land = Off-Reservation Trust Land

1 A "*" following a place name indicates that the place is coterminous with a MCD. A "-" indicates that the place differs from the MCD. In both cases, the MCD name is shown only when it differs from the place name.
 2 A "*" following a VTD code indicates an actual voting district. Its absence indicates that the VTD is a pseudo voting district or no information is available as to its status.
 3 A "*" following a block number indicates that the block number is repeated elsewhere in the block.

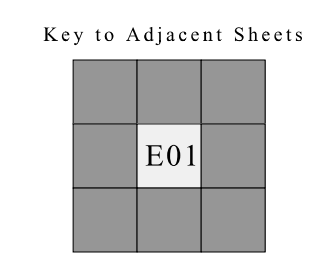
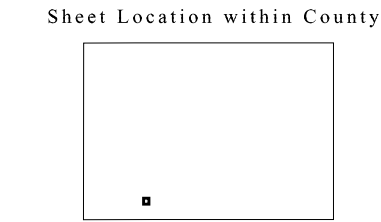
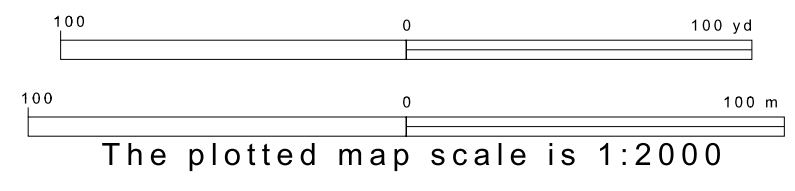
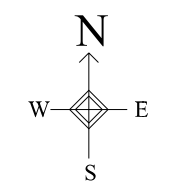
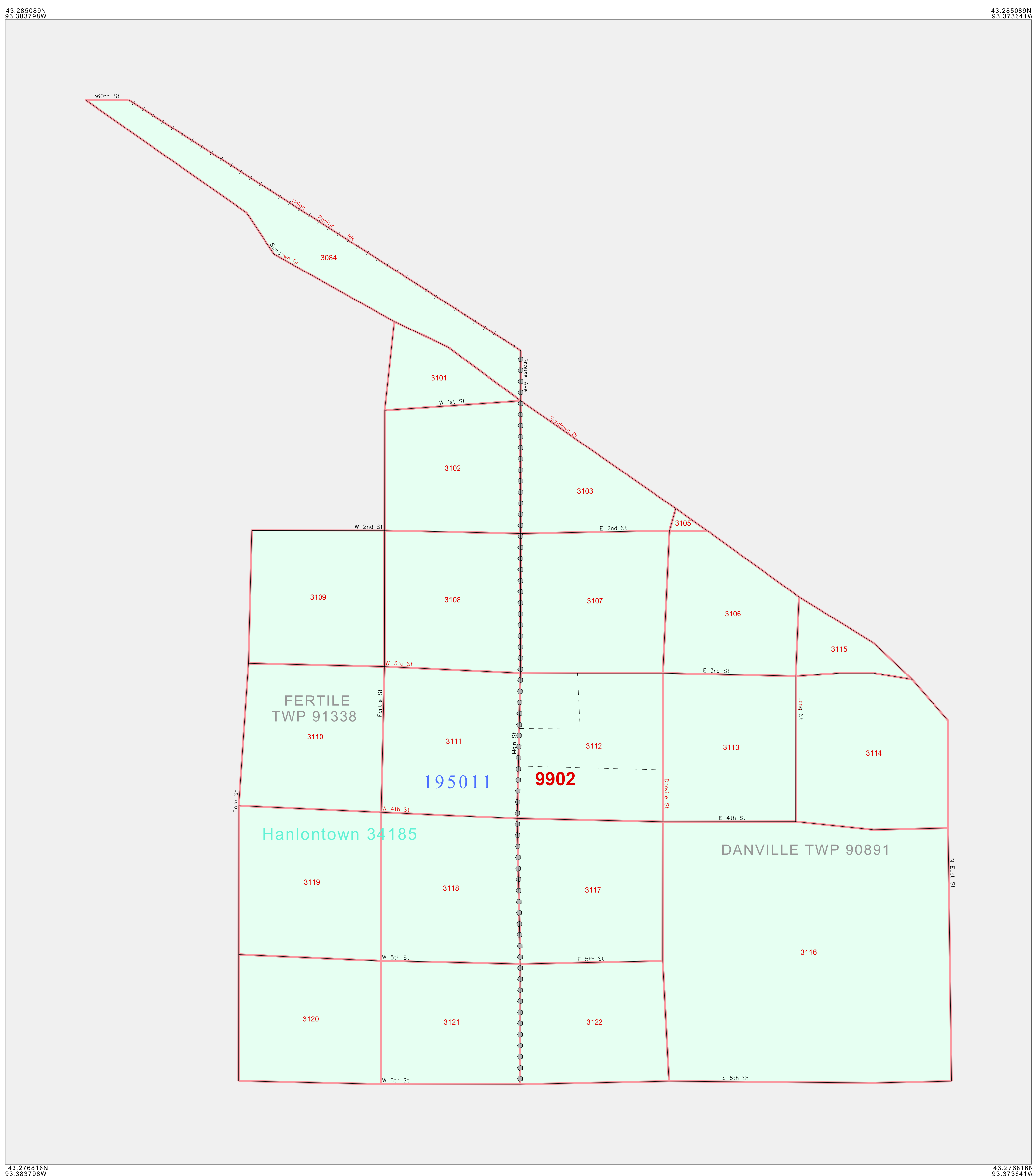

ST: Iowa (19)
 COU: Worth (195)
 INSET SHEET E01

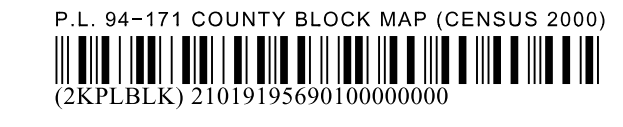

All legal boundaries and names are as of January 1, 2000. The boundaries shown on this map are for Census Bureau statistical data collection and tabulation purposes only; their depiction and designation for statistical purposes does not constitute a determination of jurisdictional authority or rights of ownership or entitlement. U.S. DEPARTMENT OF COMMERCE Economics and Statistics Administration U.S. Census Bureau