

INDEX FOR P.L. 94-171 COUNTY BLOCK MAP (CENSUS 2000)

SYMBOL	NAME STYLE
*****	INTERNATIONAL
-----	AIR (FEDERAL)
-----	Trust Land/HLL
-----	OTSA/ANVSA/TDSA
-----	TRIBAL SUBDIVISION
-----	AIR (State)
-----	SDA/ISA
-----	ANRC
#####	STATE
#####	COUNTY
#####	MINOR CIVIL DIV.¹
#####	Consolidated City
#####	Incorporated Place¹
#####	Census Designated Place¹
[Inset]	Inset
[Out Area]	Out Area

Abbreviation Reference: AIR = American Indian Reservation; Trust Land = Off-Reservation Trust Land; ANRC = Alaska Native Regional Corporation; TDS = Tribal Designated Statistical Area; Tribal Subdivision = American Indian Tribal Subdivision; SDA/ISA = State Designated American Indian Statistical Area; ANRC = Alaska Native Regional Corporation

¹ A " " following a place name indicates that the place is coextensive with a MCD. A " " indicates that the place is also a false MCD. In both cases, the MCD name is shown only when it differs from the place name.

SYMBOL DESCRIPTION	SYMBOL	NAME STYLE	
International	*****	CANADA	
American Indian Reservation (Federal)	*****	L'ANSE RES (1880)	
Off-Reservation Trust Land, Hawaiian Home Land	*****	T1880	
Oklahoma Tribal Statistical Area, Alaska Native Village Statistical Area, Tribal Designated Statistical Area	*****	KAW OTSA (5340)	
American Indian Tribal Subdivision	*****	SHONTO (620)	
American Indian Reservation (State)	*****	Tama Res (4125)	
State Designated American Indian Statistical Area	*****	Lumbee (9815)	
Alaska Native Regional Corporation	*****	NANA ANRC 52120	
State or Statistically Equivalent Entity	#####	NEW YORK 36	
County or Statistically Equivalent Entity	#####	ERIE 029	
Minor Civil Division (MCD)¹	#####	PIKE TWP 59742	
Census County Division (CCD)	#####	KULA CCD 91890	
Consolidated City	#####	Milford 47500	
Incorporated Place¹	#####	Rome 63418	
Census Designated Place (CDP)¹	#####	Zena 84187	
Corporate Offset Boundary	-----		
Voting District (VTD)²	023*	
Census Tract	5702.01	
Block³	1320	
FEATURE	SYMBOL	FEATURE	SYMBOL
Interstate or Other Highway	-----	Perennial Stream or Shoreline	Tumling Cr.
Secondary Road	-----	Intermittent Stream or Shoreline	Flow Cr.
Leap Trail, Walkway, Stairway, or Ferry	-----	Large River or Lake	Piscataway Lake
Railroad	-----	Glacier	Bering Glacier
Pipelining or Power Line	-----	Military Installation	Fort Belvoir
Ridge, Fence, or Other Physical Feature	-----	Inset Area	A
Property Line or Fence Line	-----	Outside Subject Area	
Nonvisible Boundary or Feature Not Elsewhere Classified	-----		

Where international, state, and/or county boundaries coincide, the map shows the boundary symbol for only the highest-ranking of these boundaries.

¹ A " " following a place name indicates that the place is coextensive with a MCD. A " " following an incorporated place name indicates that the place is also a false MCD. In both cases, the MCD name is shown only when it differs from the place name.

² A " " following a VTD code indicates an actual voting district. Its absence indicates that the VTD is a pseudo voting district or no information is available as to its status.

³ A " " following a block number indicates that the block number is repeated elsewhere in the block.

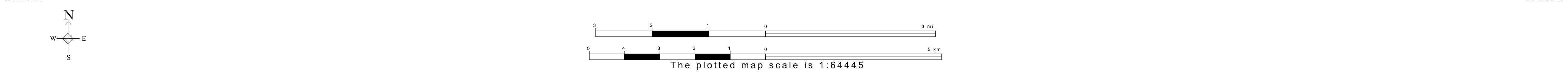
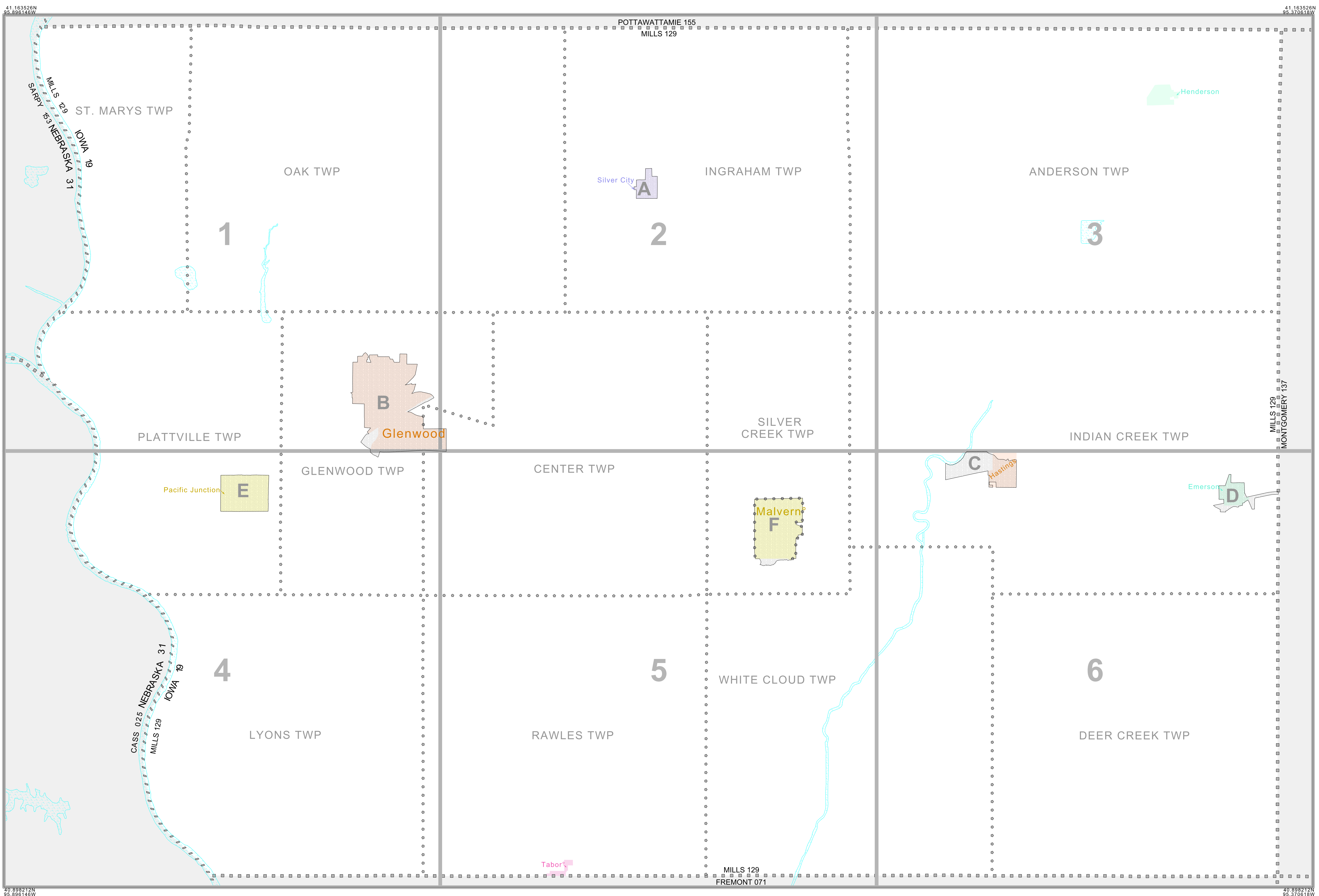

All legal boundaries and names are as of January 1, 2000. The boundaries shown on this map are for Census Bureau statistical data collection and tabulation purposes only; their depiction and designation for statistical purposes does not constitute a determination of jurisdictional authority or rights of ownership or entitlement. U.S. DEPARTMENT OF COMMERCE Economics and Statistics Administration U.S. Census Bureau

ST: Iowa (19)
 COU: Mills (129)
 INDEX MAP (TOTAL PARENT SHEETS 6 TOTAL INSET SHEETS 6)

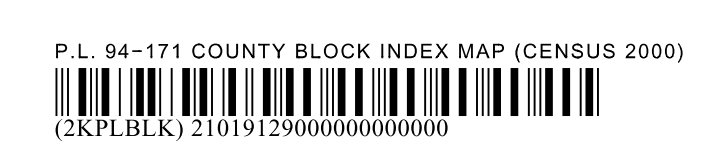

P.L. 94-171 COUNTY BLOCK MAP LEGEND (CENSUS 2000)

<u>SYMBOL DESCRIPTION</u>	<u>SYMBOL</u>	<u>NAME STYLE</u>
International	☆☆☆☆☆☆	CANADA
American Indian Reservation (Federal)	☆☆☆☆☆☆	L'ANSE RES (1880)
Off-Reservation Trust Land, Hawaiian Home Land	☆☆☆☆☆☆	T1880
Oklahoma Tribal Statistical Area, Alaska Native Village Statistical Area, Tribal Designated Statistical Area	◆◆◆◆◆◆◆	KAW OTSA (5340)
American Indian Tribal Subdivision	◆◆◆◆◆◆◆	SHONTO (620)
American Indian Reservation (State)	// // // // // //	Tama Res (4125)
State Designated American Indian Statistical Area	◇◇◇◇◇◇◇	Lumbee (9815)
Alaska Native Regional Corporation	▽ ▲ ▽ ▲ ▽ ▲ ▽	NANA ANRC 52120
State or Statistically Equivalent Entity	// // // // // //	NEW YORK 36
County or Statistically Equivalent Entity	■ ■ ■ ■ ■ ■ ■	ERIE 029
Minor Civil Division (MCD) ¹	◡ ◡ ◡ ◡ ◡ ◡ ◡	PIKE TWP 59742
Census County Division (CCD)	◡ ◡ ◡ ◡ ◡ ◡ ◡	KULA CCD 91890
Consolidated City	○ ○ ○ ○ ○ ○ ○	Milford 47500
Incorporated Place ¹		Rome 63418
Census Designated Place (CDP) ¹		Zena 84187
Corporate Offset Boundary	
Voting District (VTD) ²	● ● ● ● ● ● ●	023*
Census Tract		5702.01
Block ³		1326

<u>FEATURE</u>	<u>SYMBOL</u>	<u>FEATURE</u>	<u>SYMBOL</u>
Interstate or Other Highway		Perennial Stream or Shoreline	
Secondary Road		Intermittent Stream or Shoreline	
Jeep Trail, Walkway, Stairway, or Ferry		Large River or Lake	
Railroad		Glacier	
Pipeline or Power Line		Military Installation	
Ridge, Fence, or Other Physical Feature		Inset Area	
Property Line or Fence Line		Outside Subject Area	
Nonvisible Boundary or Feature Not Elsewhere Classified			

Where international, state, and/or county boundaries coincide, the map shows the boundary symbol for only the highest-ranking of these boundaries.

¹ A ' * ' following a place name indicates that the place is coextensive with a MCD. A ' ° ' following an incorporated place name indicates that the place is also a false MCD. In both cases, the MCD name is shown only when it differs from the place name.

² A ' * ' following a VTD code indicates an actual voting district. Its absence indicates that the VTD is a pseudo voting district or no information is available as to its status.

³ A ' * ' following a block number indicates that the block number is repeated elsewhere in the block.

P. L. 94-171 COUNTY BLOCK MAP (CENSUS 2000)

41 163527N
93.896146W

41 163527N
93.720899W

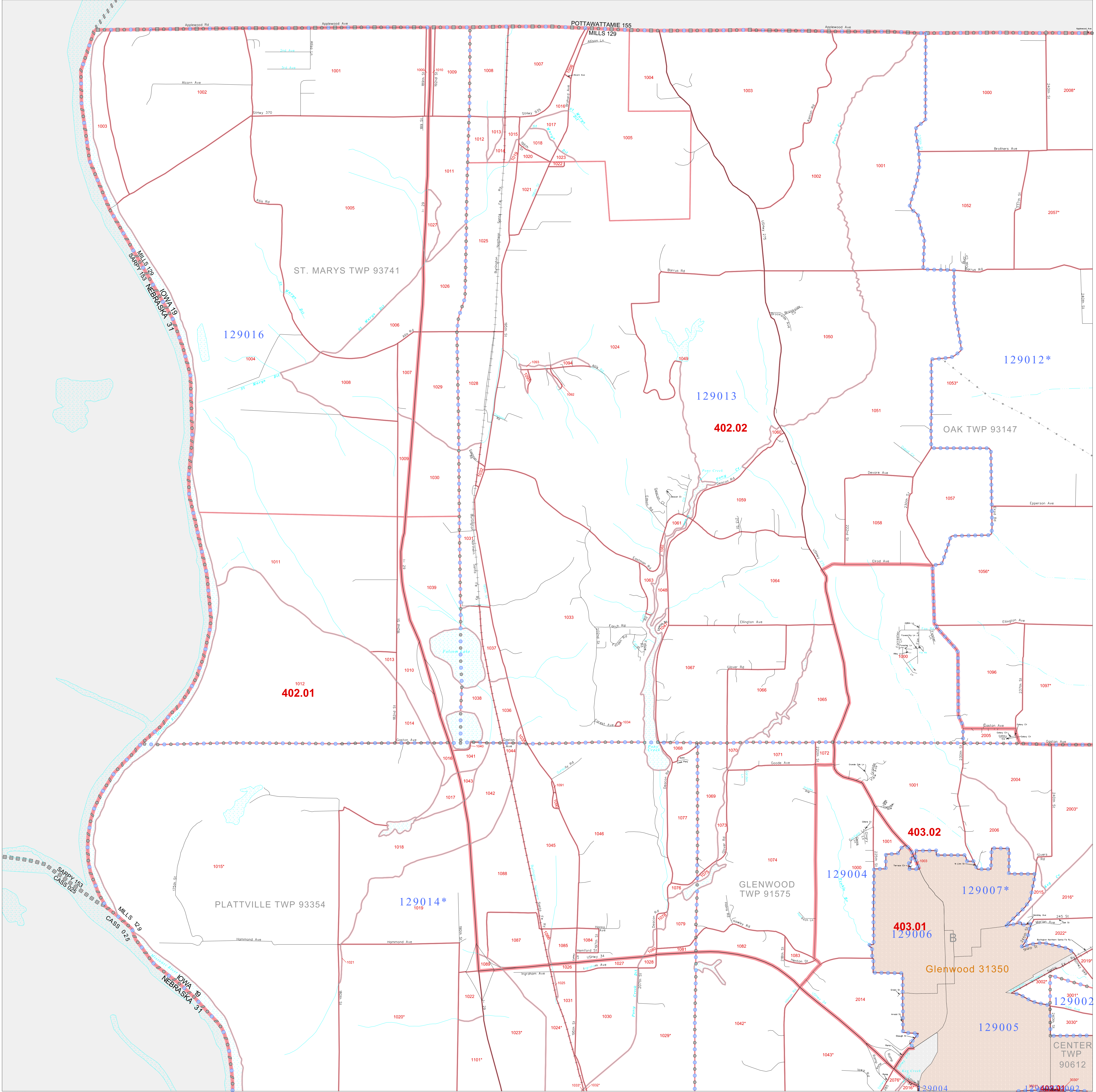

GEOGRAPHIC AREAS LEGEND

SYMBOL	NAME STYLE
*****	INTERNATIONAL
*****	AIR (FEDERAL)
*****	Trust Land
*****	STATE
*****	COUNTY
*****	MINOR CIVIL DIV.
*****	Incorporated Place ¹
*****	Census Designated Place ¹
*****	Corporate Offset Boundary
*****	Voting District ²
*****	Census Tract
*****	BLOCK ³

Military Inset Out Area

Abbreviation Reference: AIR = American Indian Reservation; Trust Land = Gift/Reservation Trust Land

1 A "*" following a place name indicates that the place is coterminous with a MCD. A "-" indicates that the place differs from the place name.
 2 A "*" following a VTD code indicates an actual voting district. Its absence indicates that the VTD is a pseudo voting district or no information is available as to its status.
 3 A "*" following a block number indicates that the block number is repeated elsewhere in the block.

41 030860N
93.896146W

41 030860N
93.720899W



Sheet Location within County

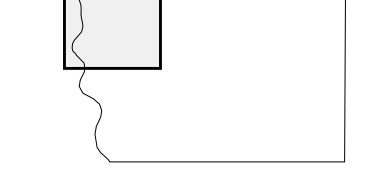

Key to Adjacent Sheets

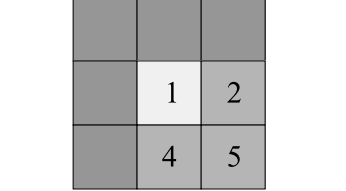

ST: Iowa (19)
 COU: Mills (129)
 SHEET 1 OF 6 PARENT SHEETS

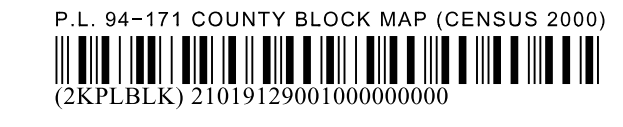

All legal boundaries and names are as of January 1, 2000. The boundaries shown on this map are for Census Bureau statistical data collection and tabulation purposes only; their depiction and designation for statistical purposes does not constitute a determination of jurisdictional authority or rights of ownership or entitlement. U.S. DEPARTMENT OF COMMERCE Economics and Statistics Administration U.S. Census Bureau

P. L. 94-171 COUNTY BLOCK MAP (CENSUS 2000)

41.163527N
95.720889W

41.163527N
95.548793W

GEOGRAPHIC AREAS LEGEND

SYMBOL	NAME STYLE
*****	INTERNATIONAL
*****	AIR (FEDERAL)
*****	Trust Land
*****	STATE
*****	COUNTY
*****	MINOR CIVIL DIV.
*****	Incorporated Place ¹
*****	Census Designated Place ²
*****	Corporate Offset Boundary
*****	Voting District ³
*****	Census Tract
*****	BLOCK ³

Military Inset Out Area
 Abbreviation Reference: AIR = American Indian Reservation; Trust Land = Off-Reservation Trust Land

¹ A "*" following a place name indicates that the place is coextensive with a MCD. A "-" indicates that the place is also a false MCD. In both cases, the MCD name is shown only when it differs from the place name.
² A "*" following a VTD code indicates an actual voting district. Its absence indicates that the VTD is a pseudo voting district or no information is available as to its status.
³ A "*" following a block number indicates that the block number is repeated elsewhere in the block.

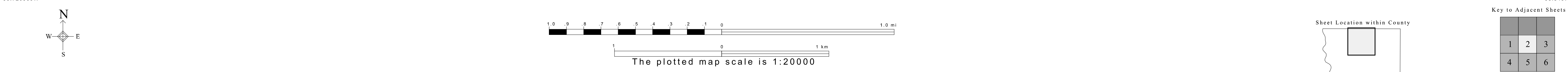
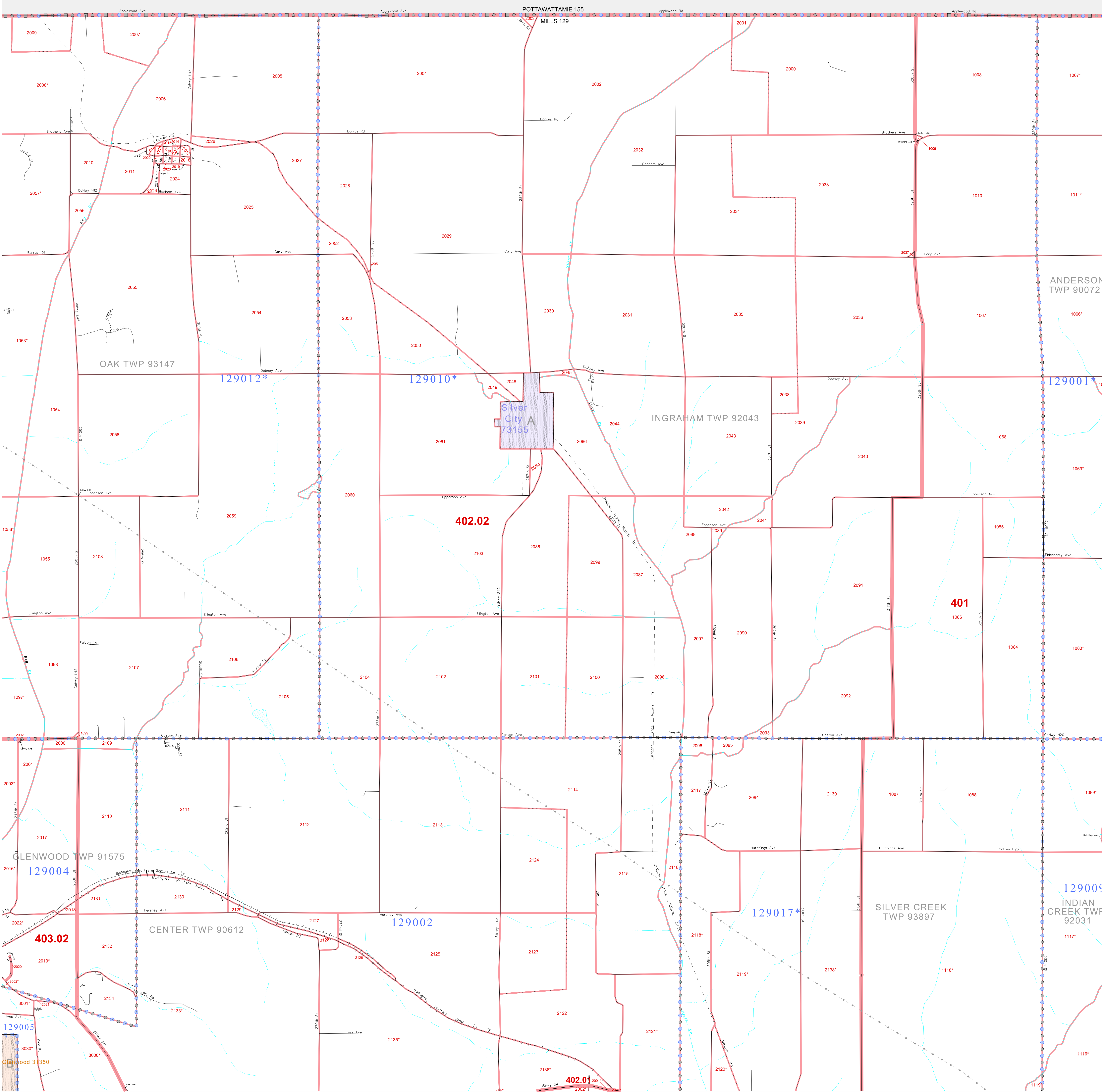

All legal boundaries and names are as of January 1, 2000. The boundaries shown on this map are for Census Bureau statistical data collection and tabulation purposes only; their depiction and designation for statistical purposes does not constitute a determination of jurisdictional authority or rights of ownership or entitlement. U.S. DEPARTMENT OF COMMERCE Economics and Statistics Administration U.S. Census Bureau

P. L. 94-171 COUNTY BLOCK MAP (CENSUS 2000)

41 163527N
95.545793W

41 163527N
95.376617W

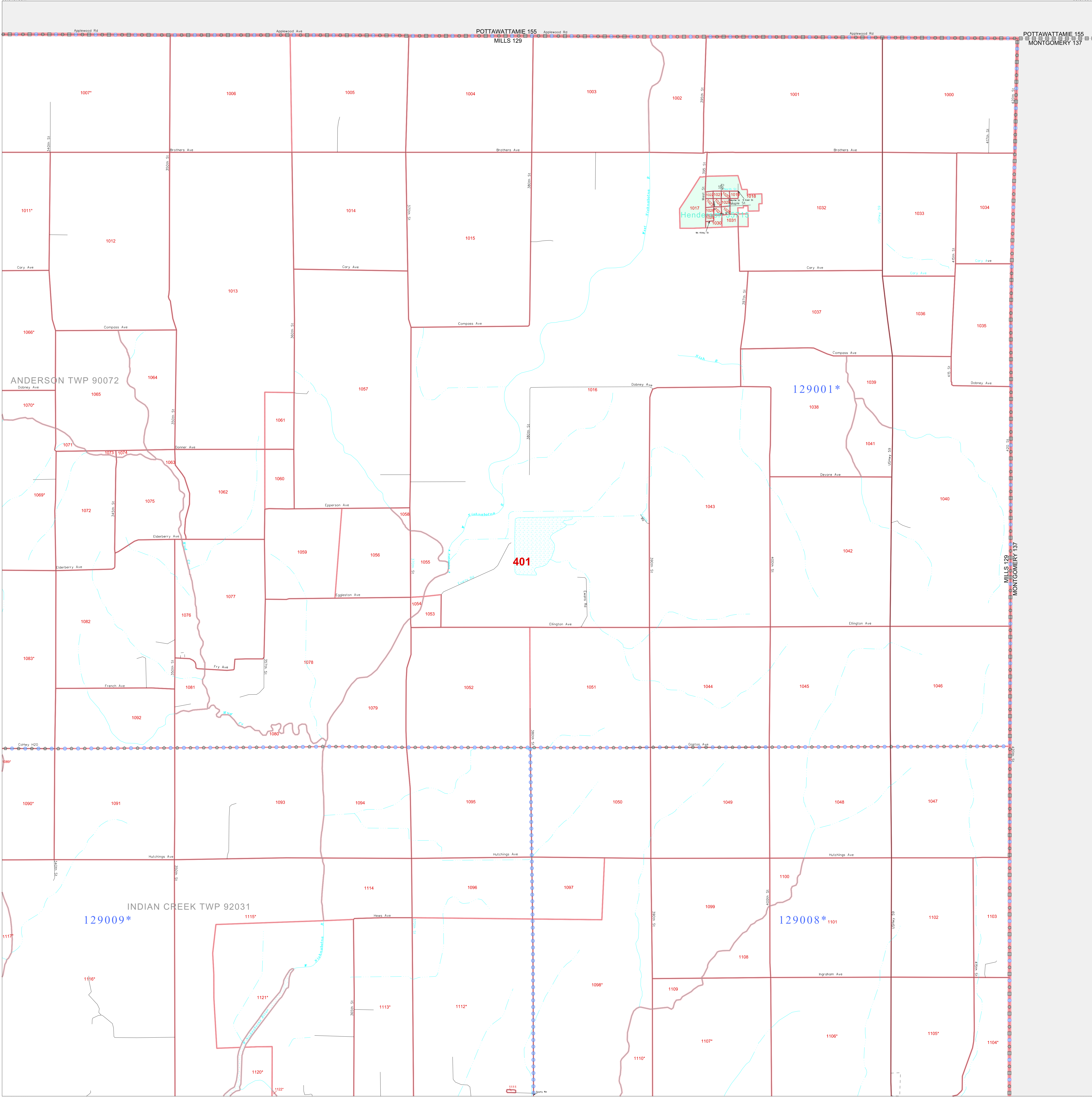

GEOGRAPHIC AREAS LEGEND

SYMBOL	NAME STYLE
*****	INTERNATIONAL
*****	AIR (FEDERAL)
*****	Trust Land
*****	STATE
*****	COUNTY
*****	MINOR CIVIL DIV.
*****	Incorporated Place¹
*****	Census Designated Place¹
*****	Corporate Offset Boundary
*****	Voting District²
*****	Census Tract
*****	BLOCK³

Military Inset Out Area

Abbreviation Reference: AIR = American Indian Reservation; Trust Land = Off-Reservation Trust Land

1 A "*" following a place name indicates that the place is coterminous with a MCD. A "-" indicates that the place differs from the MCD. In both cases, the MCD name is shown only when it differs from the place name.
 2 A "*" following a VTD code indicates an actual voting district. Its absence indicates that the VTD is a pseudo voting district or no information is available as to its status.
 3 A "*" following a block number indicates that the block number is repeated elsewhere in the block.

41 030869N
95.545793W

41 030869N
95.376617W

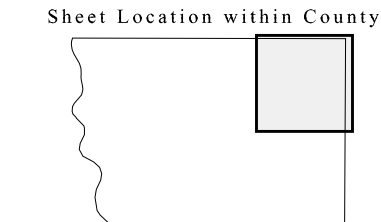
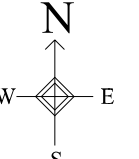

Key to Adjacent Sheets

2	3
5	6

ST: Iowa (19)
COU: Mills (129)
SHEET 3 OF 6 PARENT SHEETS

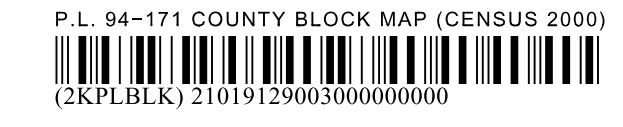

All legal boundaries and names are as of January 1, 2000. The boundaries shown on this map are for Census Bureau statistical data collection and tabulation purposes only; their depiction and designation for statistical purposes does not constitute a determination of jurisdictional authority or rights of ownership or entitlement. U.S. DEPARTMENT OF COMMERCE Economics and Statistics Administration U.S. Census Bureau

P. L. 94-171 COUNTY BLOCK MAP (CENSUS 2000)

41 030860N
95.856146W

41 030860N
95.720969W

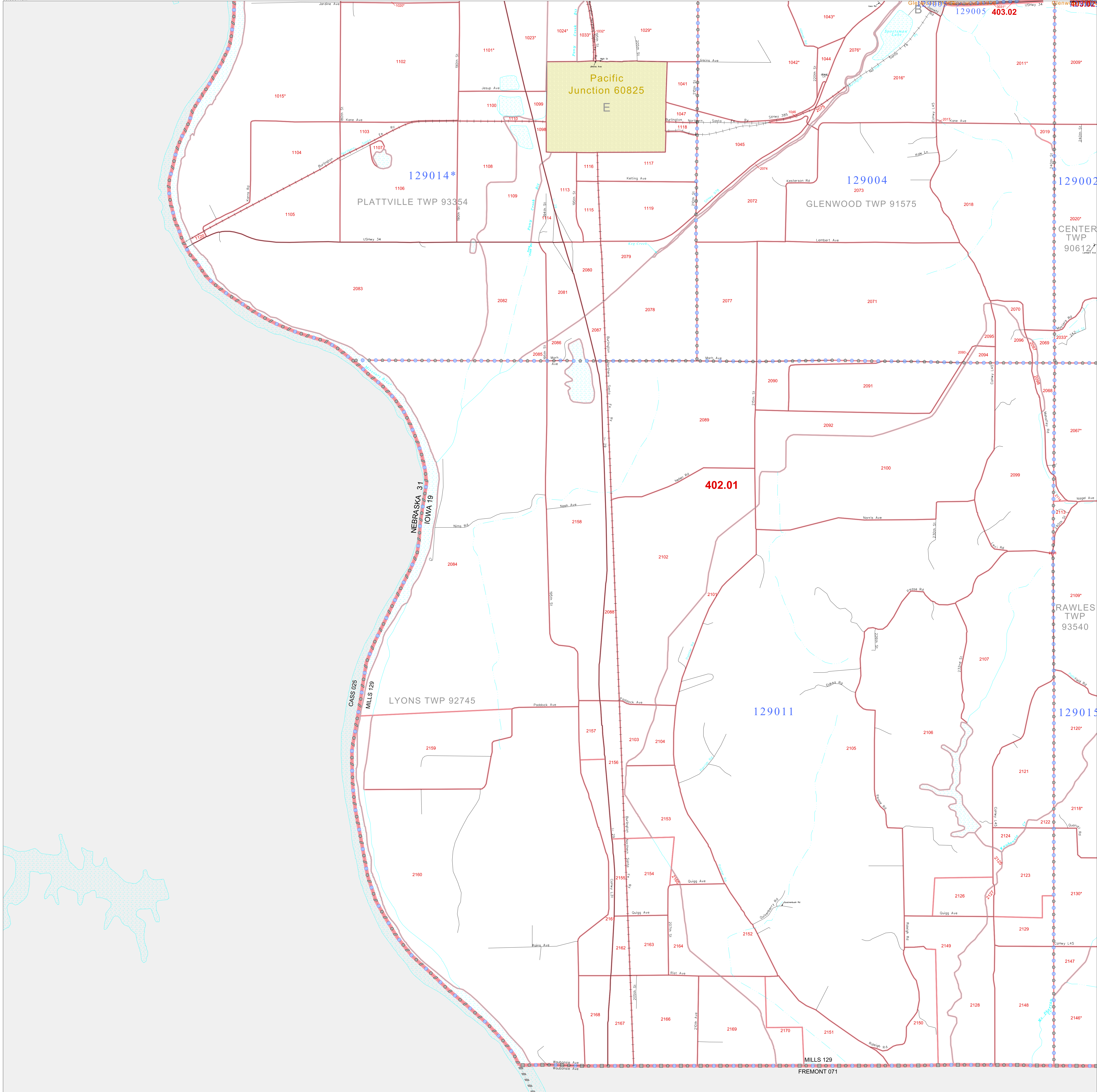

GEOGRAPHIC AREAS LEGEND

SYMBOL	NAME STYLE
*****	INTERNATIONAL
*****	AIR (FEDERAL)
*****	Trust Land
*****	Trust Land
*****	STATE
*****	COUNTY
*****	MINOR CIVIL DIV.
*****	Incorporated Place*
*****	Census Designated Place*
*****	Corporate Offset Boundary
*****	Voting District*
*****	Census Tract
*****	BLOCK*

Abbreviation Reference: AIR = American Indian Reservation; Trust Land = Off-Reservation Trust Land

1 A * * following a place name indicates that the place is consecutive with a MCD. A * * indicates that the place differs from the place name.

2 A * * following a VTD code indicates an actual voting district. Its absence indicates that the VTD is a pseudo voting district or no information is available as to its status.

3 A * * following a block number indicates that the block number is repeated elsewhere in the block.

Inset Out Area

40 898212N
95.896146W

40 898212N
95.720969W

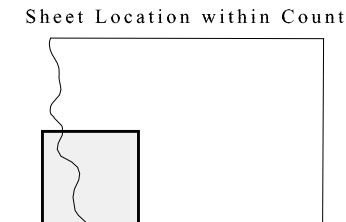
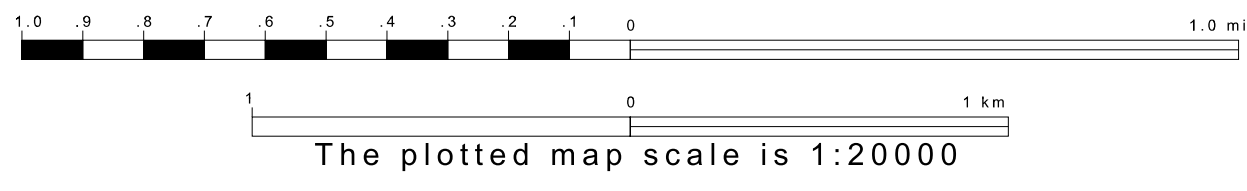
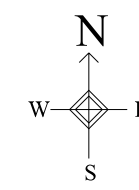

Key to Adjacent Sheets

1	2
4	5

ST: Iowa (19)
COU: Mills (129)
SHEET 4 OF 6 PARENT SHEETS

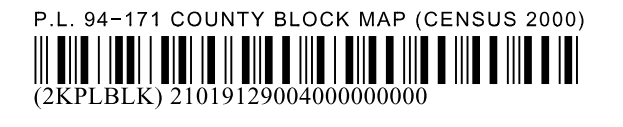

All legal boundaries and names are as of January 1, 2000. The boundaries shown on this map are for Census Bureau statistical data collection and tabulation purposes only; their depiction and designation for statistical purposes does not constitute a determination of jurisdictional authority or rights of ownership or entitlement. U.S. DEPARTMENT OF COMMERCE Economics and Statistics Administration U.S. Census Bureau

P. L. 94-171 COUNTY BLOCK MAP (CENSUS 2000)

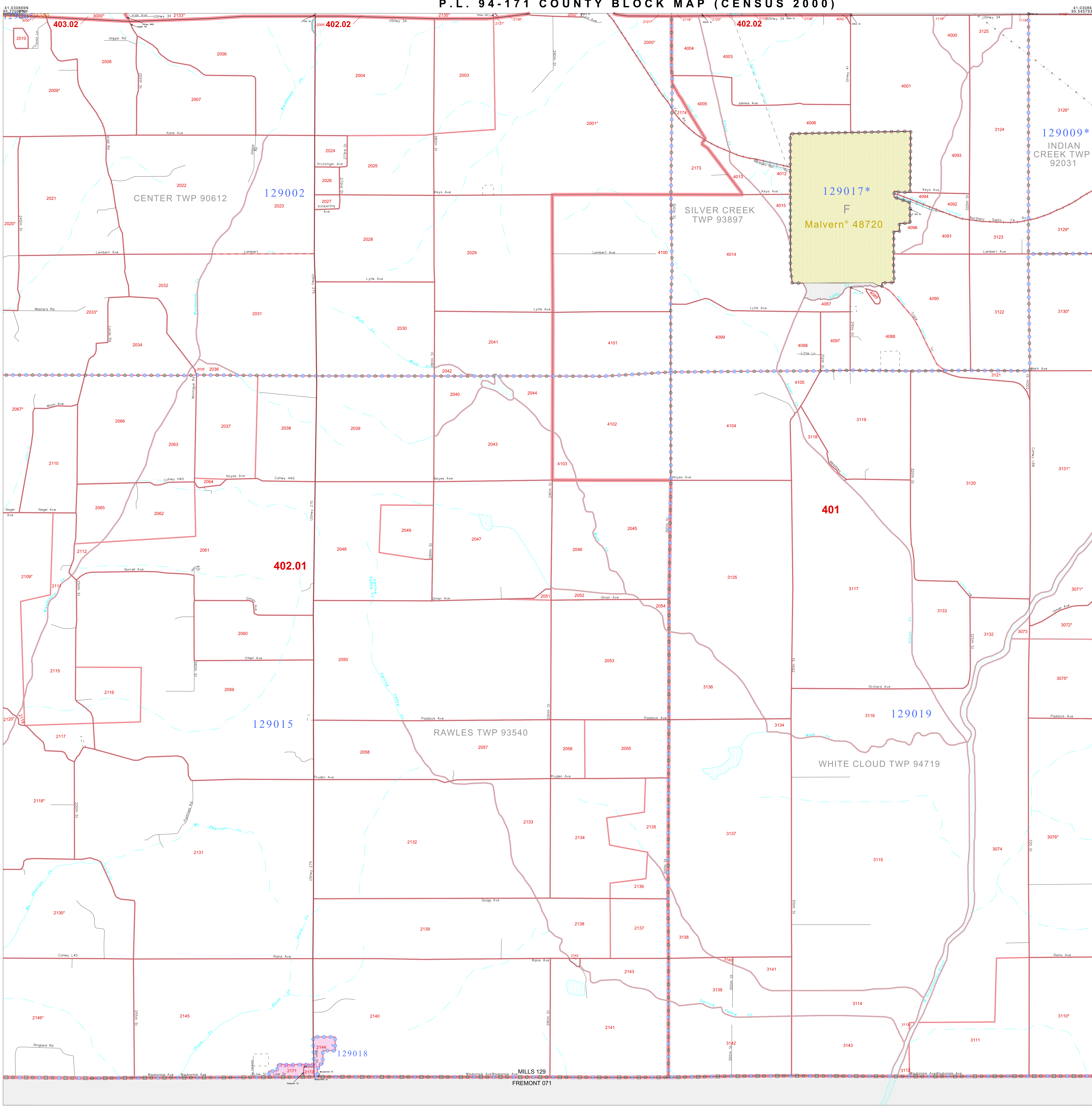

GEOGRAPHIC AREAS LEGEND

SYMBOL	NAME STYLE
*****	INTERNATIONAL
*****	AIR (FEDERAL)
*****	Trust Land
*****	STATE
*****	COUNTY
*****	MINOR CIVIL DIV ¹
*****	Incorporated Place ¹
*****	Census Designated Place ¹
*****	Corporate Offset Boundary
*****	Voting District ²
*****	Census Tract
*****	BLOCK ³

Abbreviation Reference: AIR = American Indian Reservation; Trust Land = Off-Reservation Trust Land

1 A * * following a place name indicates that the place is coterminous with a MCD. A * * indicates that the place differs from the place name.
 2 A * * following a VTD code indicates an actual voting district. Its absence indicates that the VTD is a pseudo voting district or no information is available as to its status.
 3 A * * following a block number indicates that the block number is repeated elsewhere in the block.

Inset Out Area

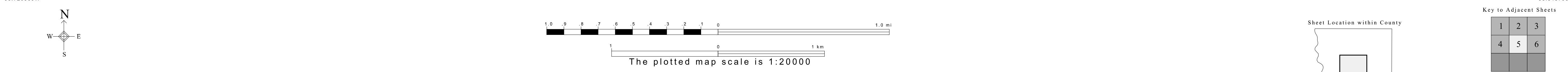

P.L. 94-171 COUNTY BLOCK MAP (CENSUS 2000)

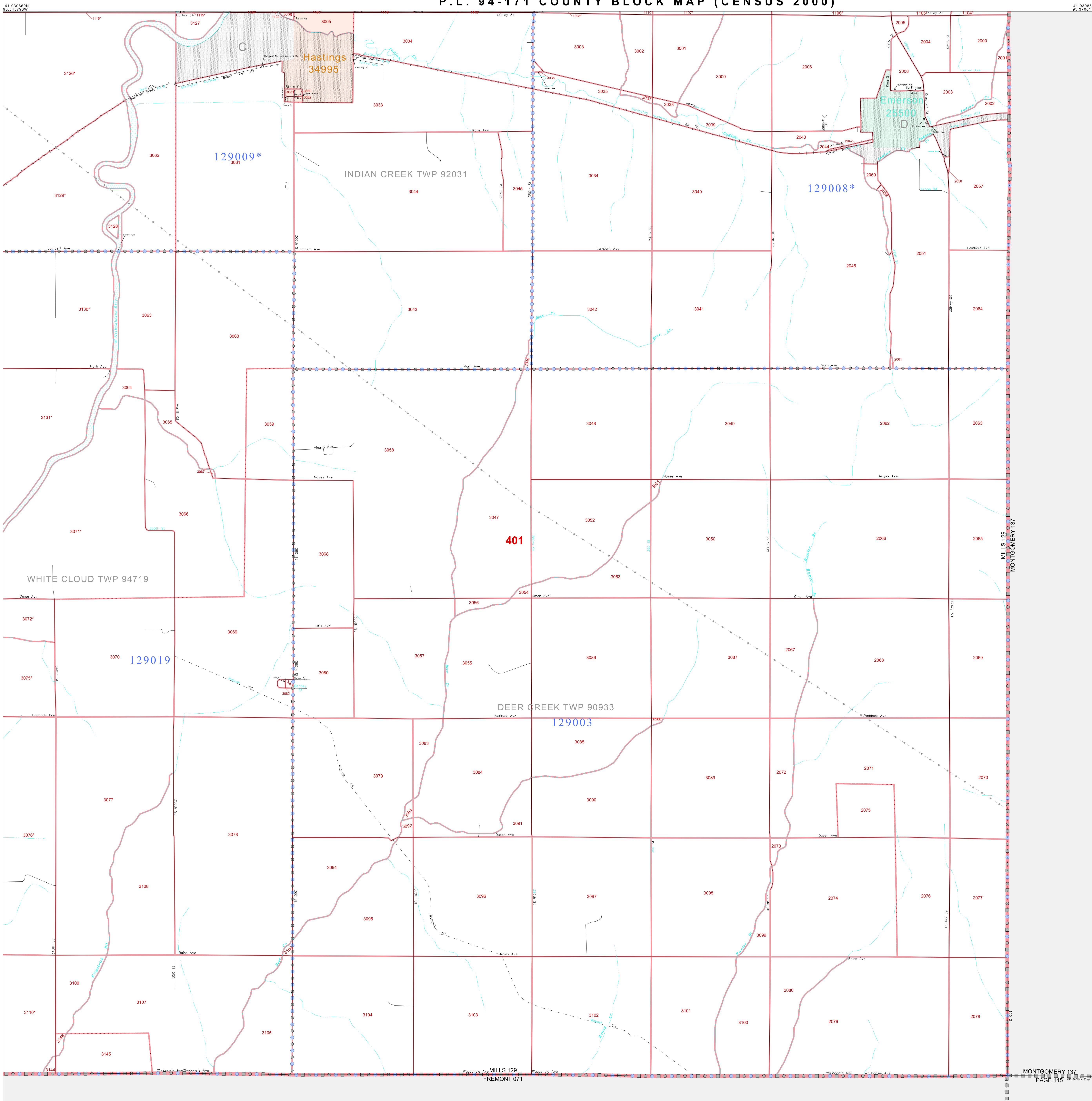

GEOGRAPHIC AREAS LEGEND

SYMBOL	NAME STYLE
*****	INTERNATIONAL
*****	AIR (FEDERAL)
*****	Trust Land
*****	STATE
*****	COUNTY
*****	MINOR CIVIL DIV.
*****	Incorporated Place ¹
*****	Census Designated Place ¹
*****	Corporate Offset Boundary
*****	Voting District ²
*****	Census Tract
*****	BLOCK ³

Abbreviation Reference: AIR = American Indian Reservation; Trust Land = Off-Reservation Trust Land

1 A * * * following a place name indicates that the place is coterminous with a MCD. A * * * indicates that the place is also a false MCD. In both cases, the MCD name is shown only when it differs from the place name.
 2 A * * * following a VTD code indicates an actual voting district. Its absence indicates that the VTD is a pseudo voting district or no information is available as to its status.
 3 A * * * following a block number indicates that the block number is repeated elsewhere in the block.

40 888212N 95.545193W

41 830869N 95.376617W

40 888212N 95.545193W

41 830869N 95.376617W

MILLS 129
FREMONT 071

MILLS 129
MONTGOMERY 137

PAGE 145

Key to Adjacent Sheets

2	3
5	6

Sheet Location within County

The plotted map scale is 1:20000

P. L. 94-171 COUNTY BLOCK MAP (CENSUS 2000)

GEOGRAPHIC AREAS LEGEND

SYMBOL	NAME STYLE
*****	INTERNATIONAL
*****	AIR (FEDERAL)
*****	Trust Land
///////	STATE
□□□□□	COUNTY
○ ○ ○ ○ ○	MINOR CIVIL DIV. ¹
■ ■ ■ ■ ■	Incorporated Place ¹
■ ■ ■ ■ ■	Census Designated Place ¹
.....	Corporate Offset Boundary
● ● ● ● ●	Voting District ²
— — — — —	Census Tract
— — — — —	BLOCK ³

Military Inset Out Area

Abbreviation Reference: AIR = American Indian Reservation; Trust Land = Off-Reservation Trust Land

1 A "*" following a place name indicates that the place is coterminous with a MCD. A "-" indicates that the place differs from the MCD. In both cases, the MCD name is shown only when it differs from the place name.

2 A "*" following a VTD code indicates an actual voting district. Its absence indicates that the VTD is a pseudo voting district or no information is available as to its status.

3 A "*" following a block number indicates that the block number is repeated elsewhere in the block.

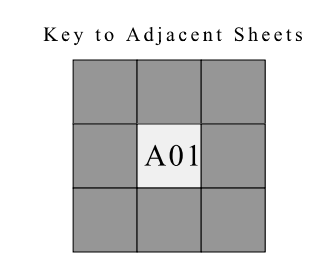
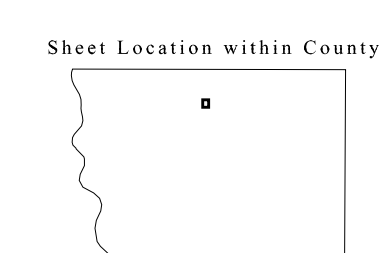
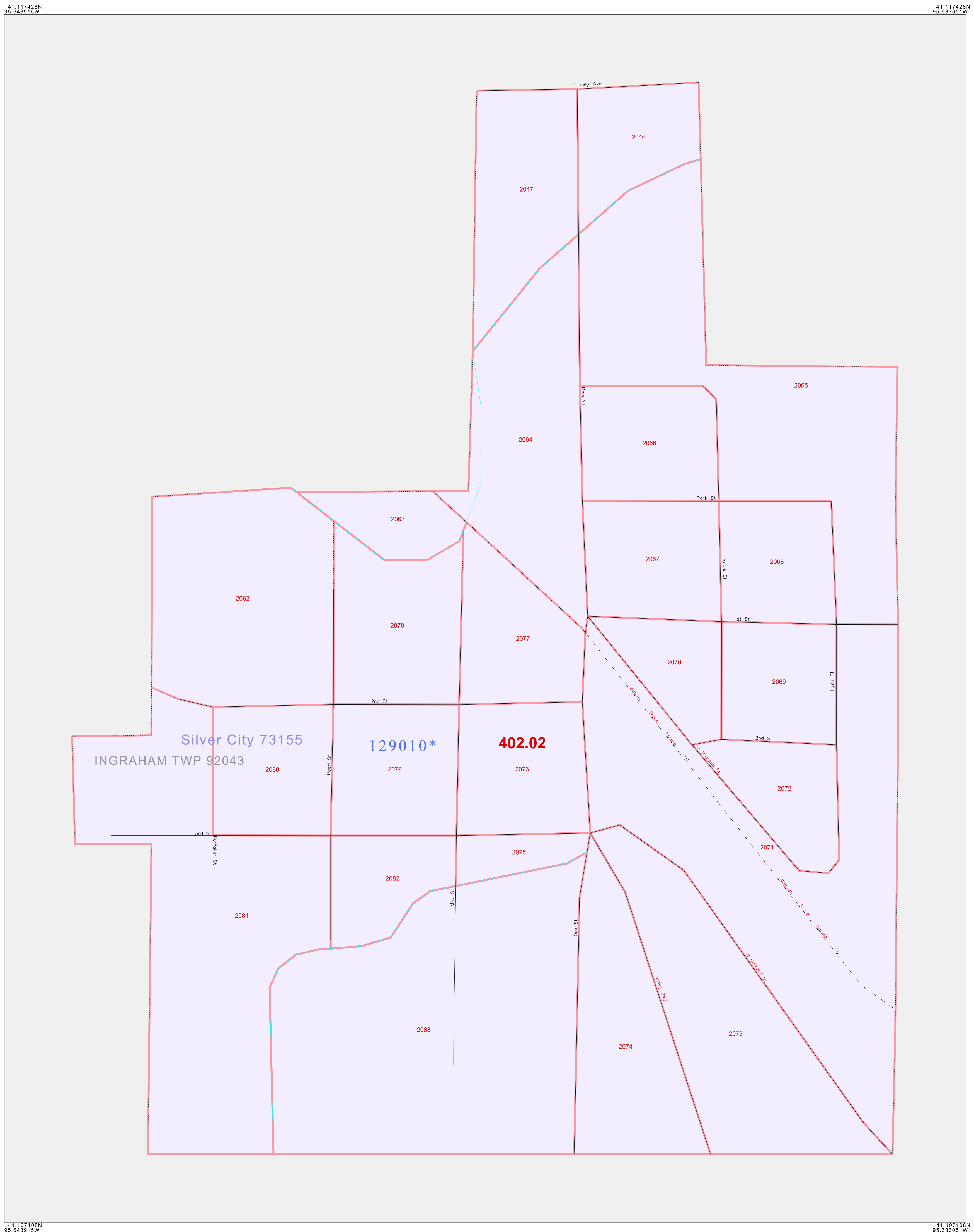

ST: Iowa (19)
 COU: Mills (129)
 INSET SHEET A01



All legal boundaries and names are as of January 1, 2000. The boundaries shown on this map are for Census Bureau statistical data collection and tabulation purposes only; their depiction and designation for statistical purposes does not constitute a determination of jurisdictional authority or rights of ownership or entitlement. U.S. DEPARTMENT OF COMMERCE Economics and Statistics Administration U.S. Census Bureau

P. L. 94-171 COUNTY BLOCK MAP (CENSUS 2000)

GEOGRAPHIC AREAS LEGEND

SYMBOL	NAME STYLE
*****	INTERNATIONAL
*****	AIR (FEDERAL)
*****	Trust Land
///////	STATE
	COUNTY
○○○○○	MINOR CIVIL DIV ¹
■ ■ ■ ■ ■	Incorporated Place ¹
■ ■ ■ ■ ■	Census Designated Place ¹
.....	Corporate Offset Boundary
.....	Voting District ²
.....	Census Tract
.....	BLOCK ³

Abbreviation Reference: AIR = American Indian Reservation; Trust Land = Off-Reservation Trust Land

1 A "*" following a place name indicates that the place is coterminous with a MCD. A "-" indicates that the place differs from the MCD. In both cases, the MCD name is shown only when it differs from the place name.

2 A "*" following a VTD code indicates an actual voting district. Its absence indicates that the VTD is a pseudo voting district or no information is available as to its status.

3 A "*" following a block number indicates that the block number is repeated elsewhere in the block.

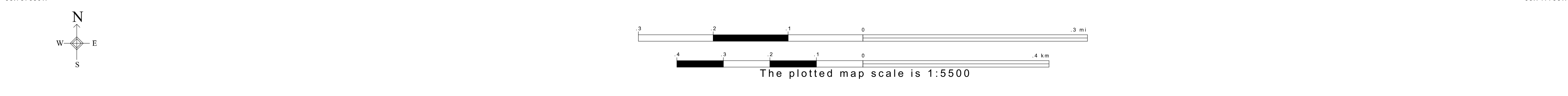

All legal boundaries and names are as of January 1, 2000. The boundaries shown on this map are for Census Bureau statistical data collection and tabulation purposes only; their depiction and designation for statistical purposes does not constitute a determination of jurisdictional authority or rights of ownership or entitlement. U.S. DEPARTMENT OF COMMERCE Economics and Statistics Administration U.S. Census Bureau

P. L. 94-171 COUNTY BLOCK MAP (CENSUS 2000)

GEOGRAPHIC AREAS LEGEND

SYMBOL	NAME STYLE
*****	INTERNATIONAL
*****	AIR (FEDERAL)
*****	Trust Land
//////	STATE
	COUNTY
o-o-o-o	MINOR CIVIL DIV. ¹
	Incorporated Place ¹
	Census Designated Place ¹
.....	Corporate Offset Boundary
o-o-o-o	Voting District ²
	Census Tract
	BLOCK ³

Military Inset Out Area

Abbreviation Reference: AIR = American Indian Reservation; Trust Land = Off-Reservation Trust Land

1 A "*" following a place name indicates that the place is coterminous with a MCD. A "-" indicates that the place differs from the MCD. In both cases, the MCD name is shown only when it differs from the place name.
 2 A "*" following a VTD code indicates an actual voting district. Its absence indicates that the VTD is a pseudo voting district or no information is available as to its status.
 3 A "*" following a block number indicates that the block number is repeated elsewhere in the block.

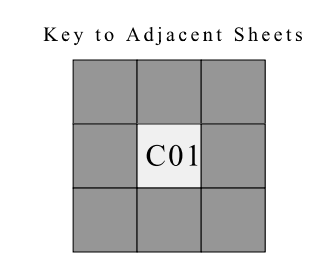
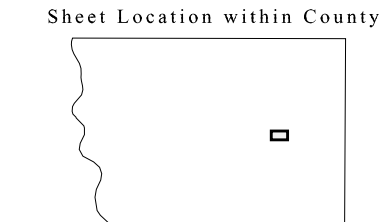
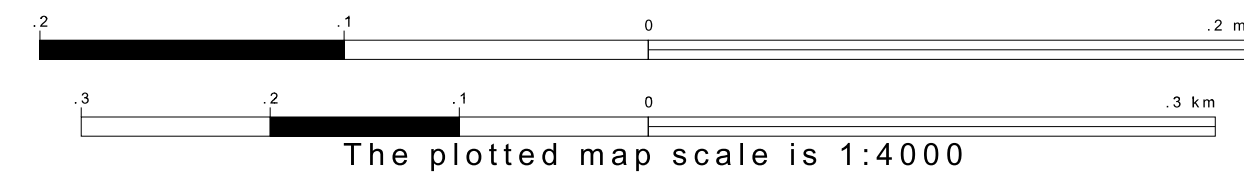
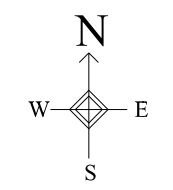
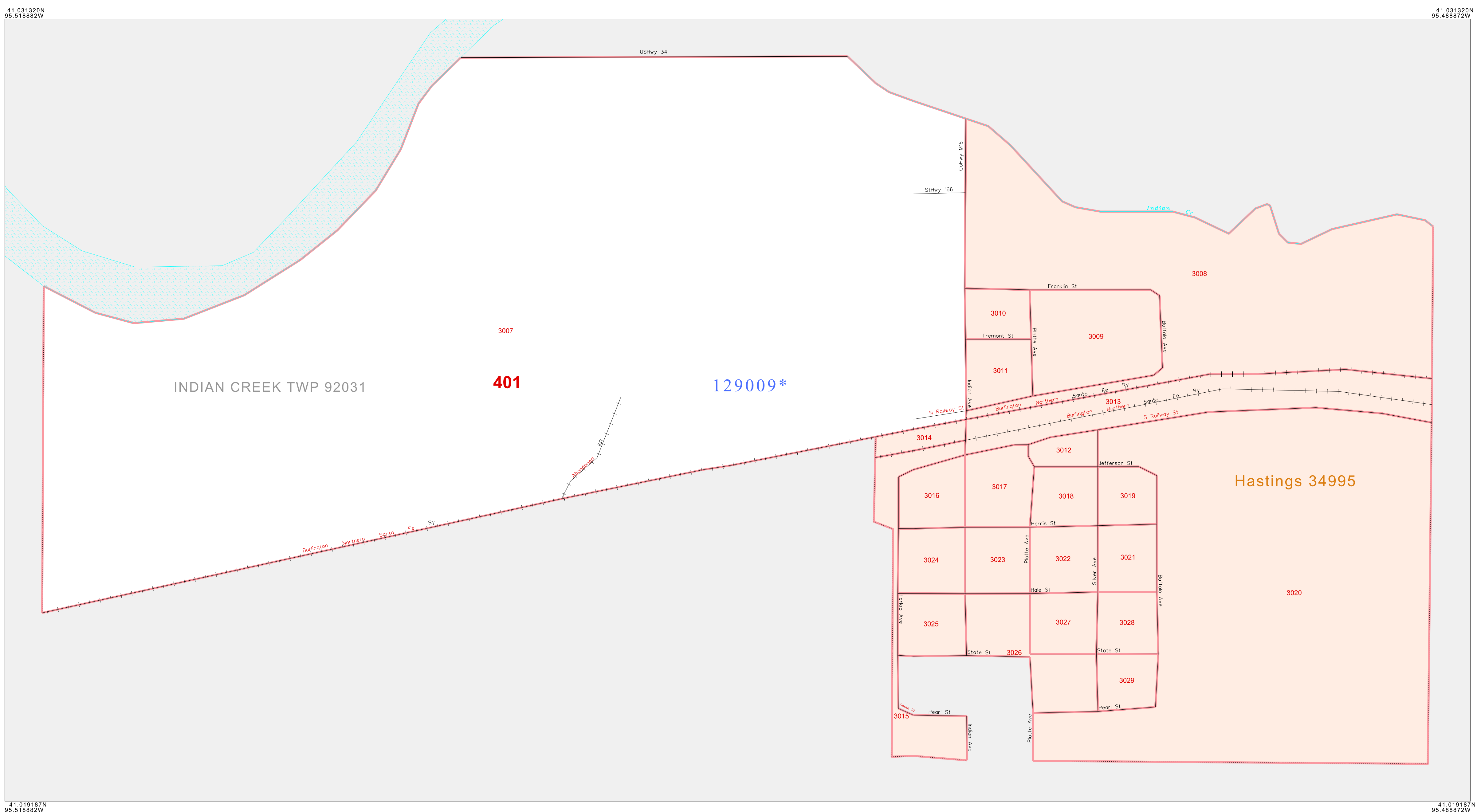

ST: Iowa (19)
 COU: Mills (129)
 INSET SHEET C01

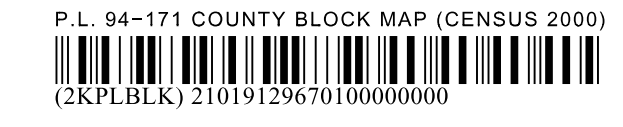

All legal boundaries and names are as of January 1, 2000.
 The boundaries shown on this map are for Census Bureau statistical data collection and tabulation purposes only; their depiction and designation for statistical purposes does not constitute a determination of jurisdictional authority or rights of ownership or entitlement.
 U.S. DEPARTMENT OF COMMERCE Economics and Statistics Administration U.S. Census Bureau

P. L. 94-171 COUNTY BLOCK MAP (CENSUS 2000)

GEOGRAPHIC AREAS LEGEND

SYMBOL	NAME STYLE
*****	INTERNATIONAL
*****	AIR (FEDERAL)
*****	Trust Land
//////	STATE
	COUNTY
o-o-o-o-o	MINOR CIVIL DIV ¹
Yellow/Pink	Incorporated Place ¹
Yellow/Pink	Census Designated Place ¹
.....	Corporate Offset Boundary
.....	Voting District ²
.....	Census Tract
.....	BLOCK ³

Military Inset Out Area

Abbreviation Reference: AIR = American Indian Reservation; Trust Land = Gift/Recreation Trust Land

1 A "*" following a place name indicates that the place is coterminous with a MCD. A "-" indicates that the place differs from the MCD. In both cases, the MCD name is shown only when it differs from the place name.
 2 A "*" following a VTD code indicates an actual voting district. Its absence indicates that the VTD is a pseudo voting district or no information is available as to its status.
 3 A "*" following a block number indicates that the block number is repeated elsewhere in the block.

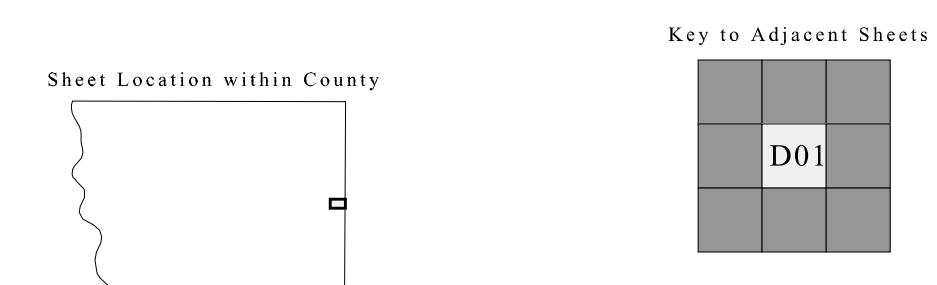
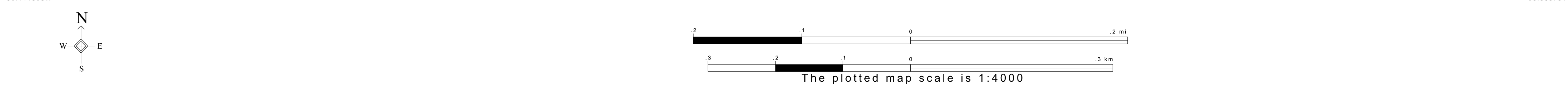
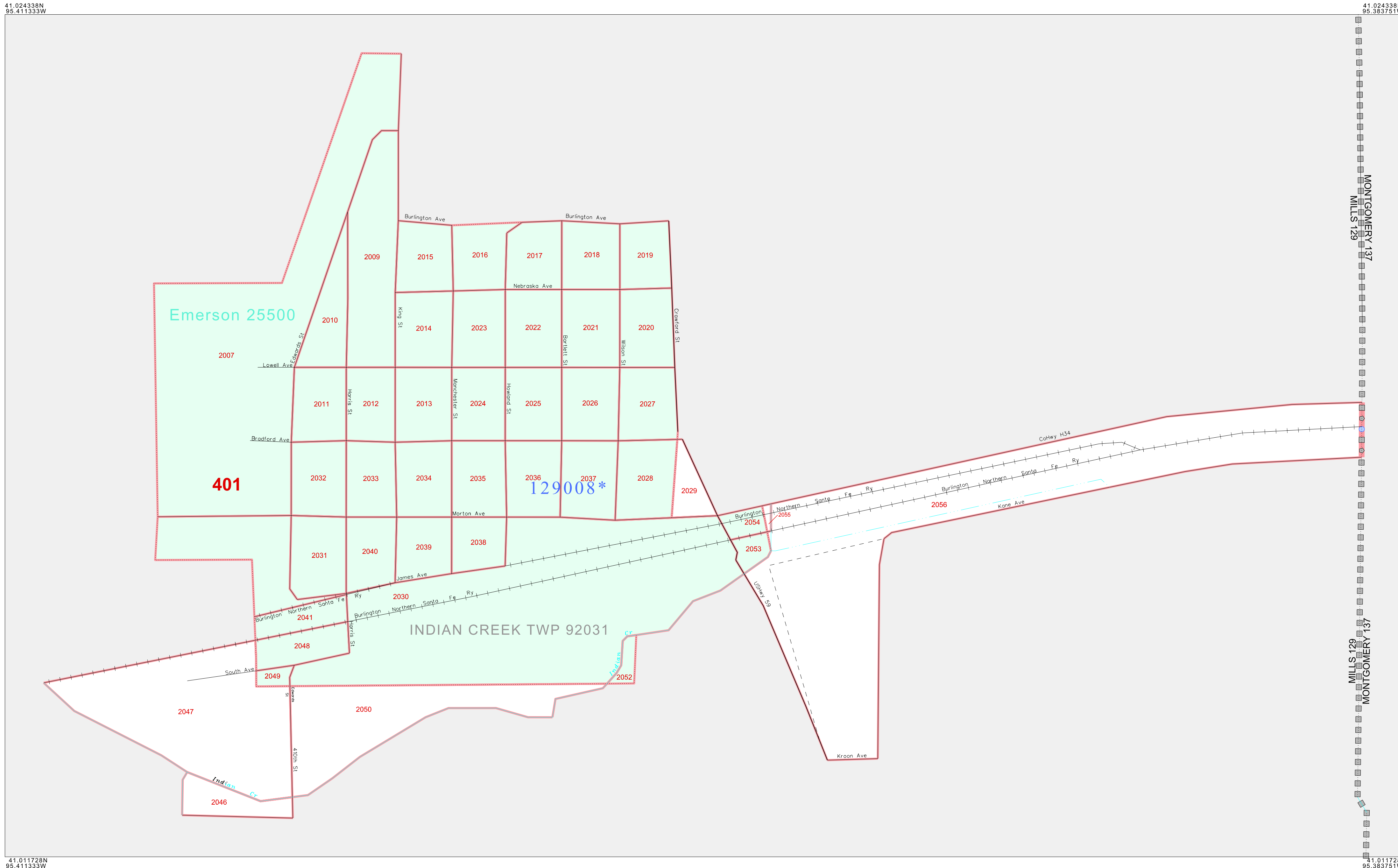

ST: Iowa (19)
 COU: Mills (129)
 INSET SHEET D01



All legal boundaries and names are as of January 1, 2000.
 The boundaries shown on this map are for Census Bureau statistical data collection and tabulation purposes only; their depiction and designation for statistical purposes does not constitute a determination of jurisdictional authority or rights of ownership or entitlement.
 U.S. DEPARTMENT OF COMMERCE Economics and Statistics Administration U.S. Census Bureau

P. L. 94-171 COUNTY BLOCK MAP (CENSUS 2000)

GEOGRAPHIC AREAS LEGEND

SYMBOL	NAME STYLE
*****	INTERNATIONAL
*****	AIR (FEDERAL)
*****	Trust Land
//////	STATE
	COUNTY
o-o-o-o-o	MINOR CIVIL DIV ¹
Yellow	Incorporated Place ¹
Light Green	Census Designated Place ¹
Red Dashed	Corporate Offset Boundary
Blue Dashed	Voting District ²
Red Solid	Census Tract
Blue Dashed	BLOCK ³

Military Inset Out Area

Abbreviation Reference: AIR = American Indian Reservation; Trust Land = Gift/Reservation Trust Land

1 A " " following a place name indicates that the place is coterminous with a MCD. A " " indicates that the place differs from the MCD. In both cases, the MCD name is shown only when it differs from the place name.
 2 A " " following a VTD code indicates an actual voting district. Its absence indicates that the VTD is a pseudo voting district or no information is available as to its status.
 3 A " " following a block number indicates that the block number is repeated elsewhere in the block.

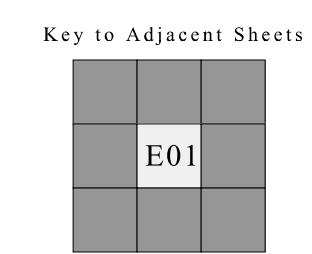
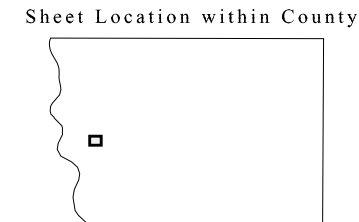
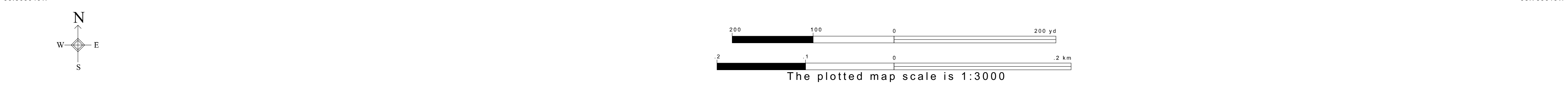
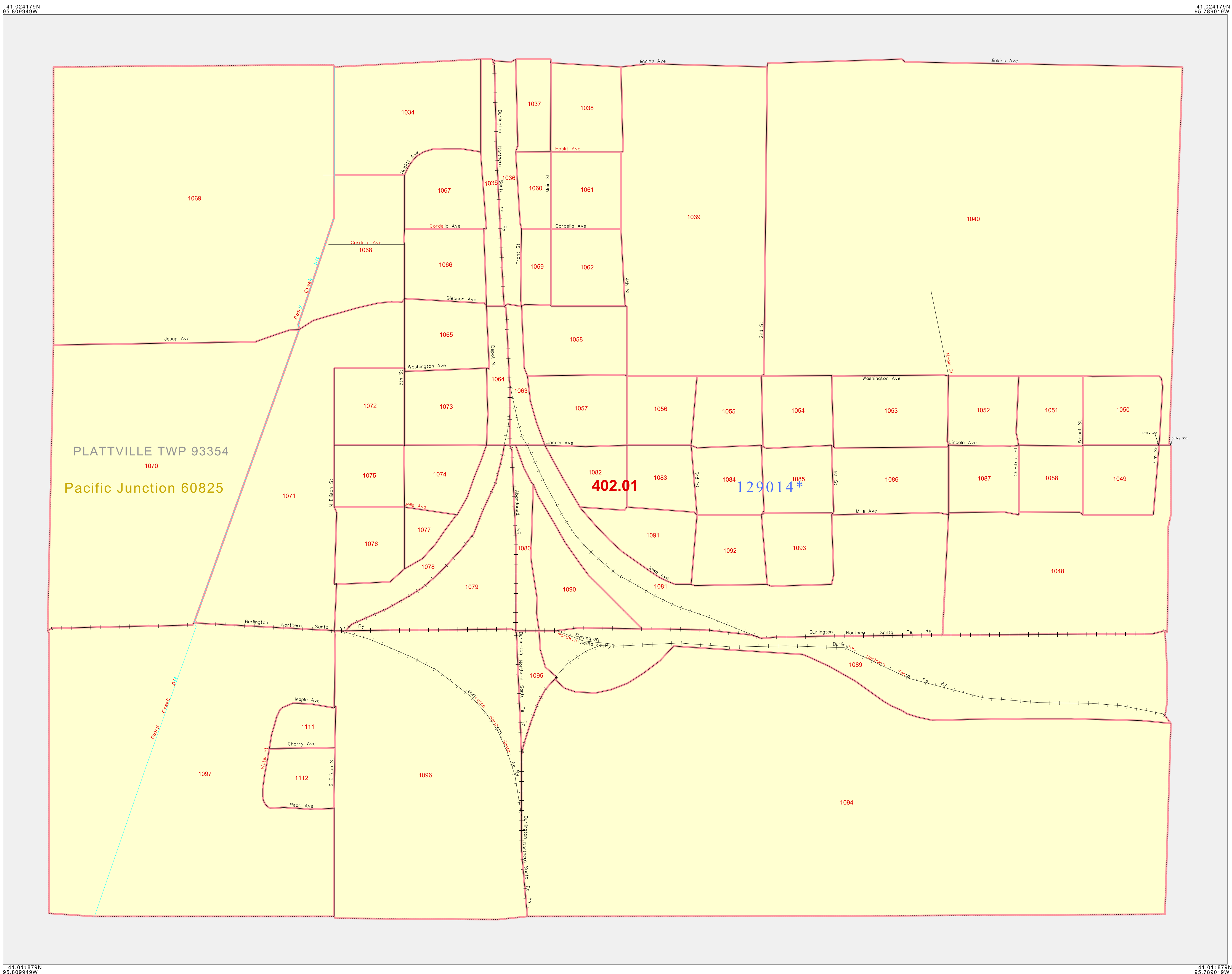

ST: Iowa (19)
 COU: Mills (129)
 INSET SHEET E01



All legal boundaries and names are as of January 1, 2000. The boundaries shown on this map are for Census Bureau statistical data collection and tabulation purposes only; their depiction and designation for statistical purposes does not constitute a determination of jurisdictional authority or rights of ownership or entitlement. U.S. DEPARTMENT OF COMMERCE Economics and Statistics Administration U.S. Census Bureau

P. L. 94-171 COUNTY BLOCK MAP (CENSUS 2000)

GEOGRAPHIC AREAS LEGEND

SYMBOL	NAME STYLE
*****	INTERNATIONAL
*****	AIR (FEDERAL)
*****	Trust Land
//////	STATE
	COUNTY
o-o-o-o-o	MINOR CIVIL DIV ¹
Yellow	Incorporated Place ¹
Light Yellow	Census Designated Place ¹
.....	Corporate Offset Boundary
.....	Voting District ²
.....	Census Tract
.....	BLOCK ³
.....	Military
.....	Inset
.....	Out Area

Abbreviation Reference: AIR = American Indian Reservation; Trust Land = Gift/Reservation Trust Land

1 A * * following a place name indicates that the place is consecutive with a MCD. A * * indicates that the place differs from the place name.
 2 A * * following a VTD code indicates an actual voting district. Its absence indicates that the VTD is a pseudo voting district or no information is available as to its status.
 3 A * * following a block number indicates that the block number is repeated elsewhere in the block.

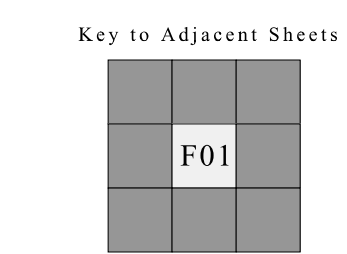
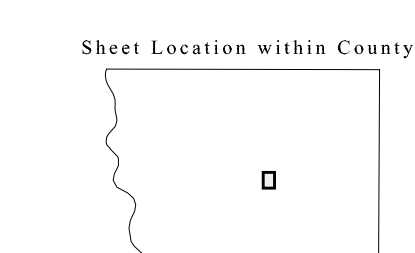
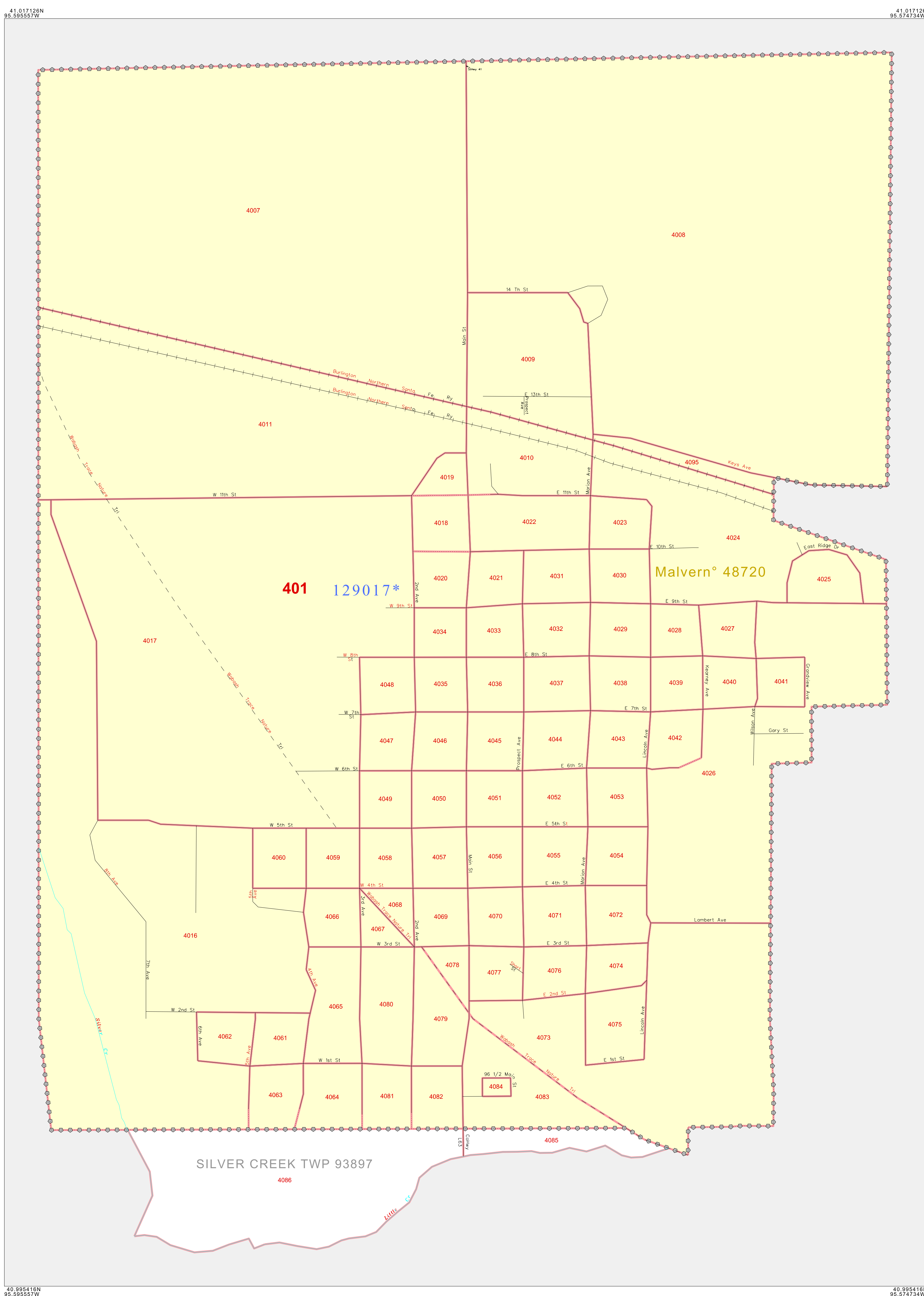

ST: Iowa (19)
 COU: Mills (129)
 INSET SHEET F01



All legal boundaries and names are as of January 1, 2000. The boundaries shown on this map are for Census Bureau statistical data collection and tabulation purposes only; their depiction and designation for statistical purposes does not constitute a determination of jurisdictional authority or rights of ownership or entitlement. U.S. DEPARTMENT OF COMMERCE Economics and Statistics Administration U.S. Census Bureau