

INDEX FOR P.L. 94-171 COUNTY BLOCK MAP (CENSUS 2000)

**INDEX MAP LEGEND**

SYMBOL	NAME STYLE
*****	INTERNATIONAL
-----	AIR (FEDERAL)
-----	Trust Land/HHL
-----	OTSA/ANVSA/TDSA
-----	TRIBAL SUBDIVISION
-----	AIR (State)
-----	SDA/SA
-----	ANRC
#####	STATE
#####	COUNTY
#####	MINOR CIVIL DIV.¹
#####	Consolidated City
#####	Incorporated Place¹
#####	Census Designated Place¹
[Inset]	Inset
[Out Area]	Out Area

Abbreviation Reference: AIR = American Indian Reservation; Trust Land = Off-Reservation Trust Land; ANRC = Alaska Native Regional Corporation; OTSA = Oklahoma Tribal Statistical Area; TDSA = Tribal Designated Statistical Area; SDA/SA = American Indian Tribal Subdivision; SDA/SA = State Designated American Indian Statistical Area; ANRC = Alaska Native Regional Corporation

¹ A " " following a place name indicates that the place is coextensive with a MCD. A " " indicates that the place is also a false MCD. In both cases, the MCD name is shown only when it differs from the place name.

**P.L. 94-171 COUNTY BLOCK MAP LEGEND (CENSUS 2000)**

SYMBOL DESCRIPTION	SYMBOL	NAME STYLE
International	*****	CANADA
American Indian Reservation (Federal)	*****	L'ANSE RES (1880)
Off-Reservation Trust Land, Hawaiian Home Land	*****	T1880
Oklahoma Tribal Statistical Area, Alaska Native Village Statistical Area, Tribal Designated Statistical Area	*****	KAW OTSA (5340)
American Indian Tribal Subdivision	*****	SHONTO (620)
American Indian Reservation (State)	*****	Tama Res (4125)
State Designated American Indian Statistical Area	*****	Lumbee (9815)
Alaska Native Regional Corporation	*****	NANA ANRC 52120
State or Statistically Equivalent Entity	#####	NEW YORK 36
County or Statistically Equivalent Entity	#####	ERIE 029
Minor Civil Division (MCD)¹	#####	PIKE TWP 59742
Census County Division (CCD)	#####	KULA CCD 91890
Consolidated City	#####	Milford 47500
Incorporated Place¹	#####	Rome 63418
Census Designated Place (CDP)¹	#####	Zena 84187
Corporate Offset Boundary	-----	
Voting District (VTD)²	-----	023*
Census Tract	-----	5702.01
Block³	-----	1320

FEATURE	SYMBOL	FEATURE	SYMBOL
Interstate or Other Highway	-----	Perennial Stream or Shoreline	Tumling Cr.
Secondary Road	-----	Intermittent Stream or Shoreline	Flowy Cr.
Jeep Trail, Walkway, Stairway, or Ferry	-----	Large River or Lake	Mountain Lake
Railroad	-----	Glacier	Bering Glacier
Pipelining or Power Line	-----	Military Installation	Fort Belvoir
Ridge, Fence, or Other Physical Feature	-----	Inset Area	A
Property Line or Fence Line	-----	Outside Subject Area	
Nonvisible Boundary or Feature Not Elsewhere Classified	-----		

Where international, state, and/or county boundaries coincide, the map shows the boundary symbol for only the highest-ranking of these boundaries.

¹ A " " following a place name indicates that the place is coextensive with a MCD. A " " following an incorporated place name indicates that the place is also a false MCD. In both cases, the MCD name is shown only when it differs from the place name.

² A " " following a VTD code indicates an actual voting district. Its absence indicates that the VTD is a pseudo voting district or no information is available as to its status.

³ A " " following a block number indicates that the block number is repeated elsewhere in the block.

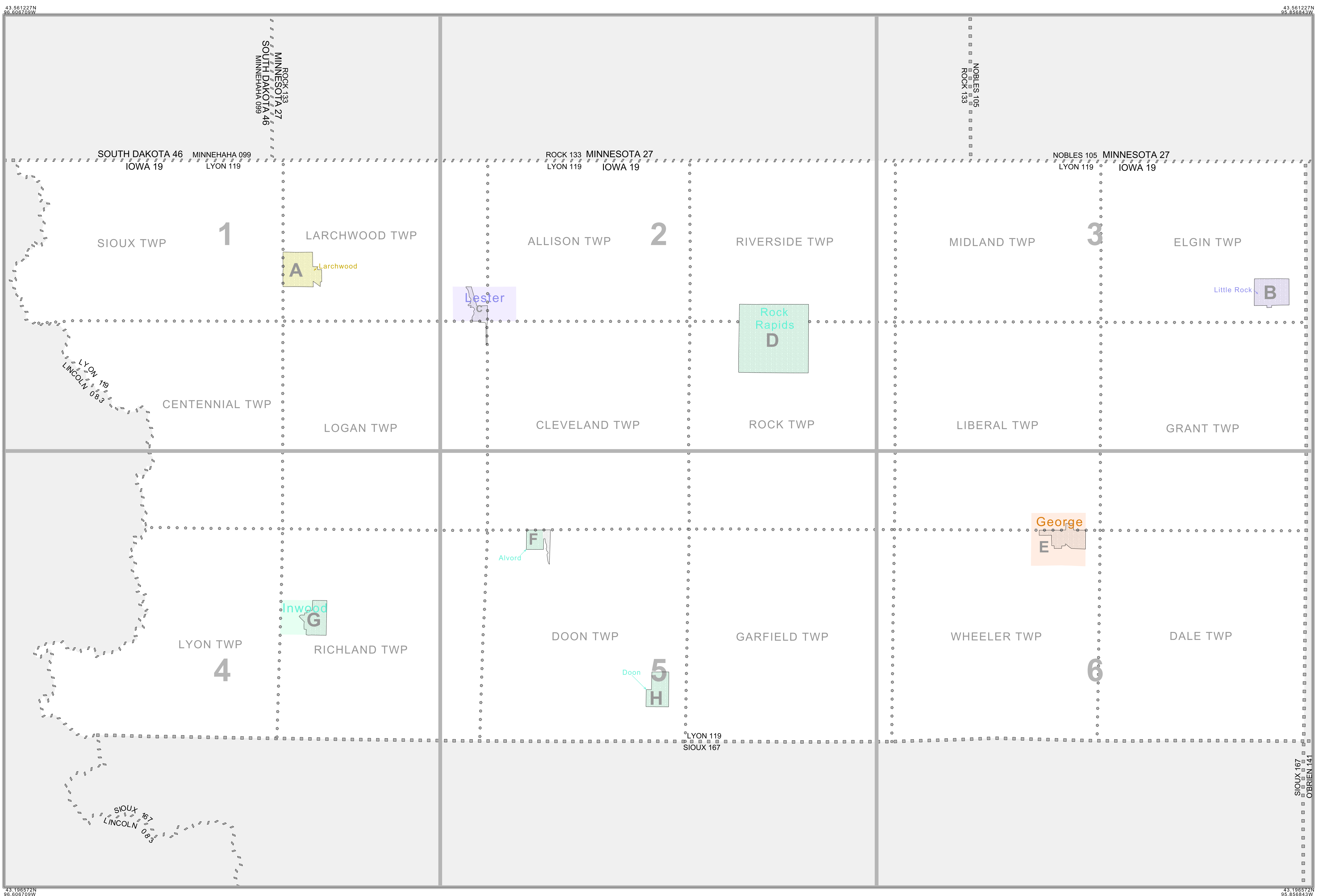

All legal boundaries and names are as of January 1, 2000. The boundaries shown on this map are for Census Bureau statistical data collection and tabulation purposes only; their depiction and designation for statistical purposes does not constitute a determination of jurisdictional authority or rights of ownership or entitlement. U.S. DEPARTMENT OF COMMERCE Economics and Statistics Administration U.S. Census Bureau

ST: Iowa (19)  
 COU: Lyon (119)  
 INDEX MAP (TOTAL PARENT SHEETS 6 TOTAL INSET SHEETS 8)

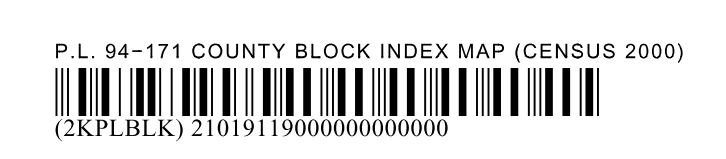

# P.L. 94-171 COUNTY BLOCK MAP LEGEND (CENSUS 2000)

<u>SYMBOL DESCRIPTION</u>	<u>SYMBOL</u>	<u>NAME STYLE</u>
International	☆☆☆☆☆☆	<b>CANADA</b>
American Indian Reservation (Federal)	☆☆☆☆☆☆	<b>L'ANSE RES (1880)</b>
Off-Reservation Trust Land, Hawaiian Home Land	☆☆☆☆☆☆	<b>T1880</b>
Oklahoma Tribal Statistical Area, Alaska Native Village Statistical Area, Tribal Designated Statistical Area	◆◆◆◆◆◆◆	<b>KAW OTSA (5340)</b>
American Indian Tribal Subdivision	◆◆◆◆◆◆◆	<b>SHONTO (620)</b>
American Indian Reservation (State)	// // // // // //	<b>Tama Res (4125)</b>
State Designated American Indian Statistical Area	◇◇◇◇◇◇◇	<b>Lumbee (9815)</b>
Alaska Native Regional Corporation	▽ ▲ ▽ ▲ ▽ ▲ ▽	<b>NANA ANRC 52120</b>
State or Statistically Equivalent Entity	// // // // // //	<b>NEW YORK 36</b>
County or Statistically Equivalent Entity	■ ■ ■ ■ ■ ■ ■	<b>ERIE 029</b>
Minor Civil Division (MCD) <sup>1</sup>	⬢ ⬢ ⬢ ⬢ ⬢ ⬢ ⬢	<b>PIKE TWP 59742</b>
Census County Division (CCD)	⬢ ⬢ ⬢ ⬢ ⬢ ⬢ ⬢	<b>KULA CCD 91890</b>
Consolidated City	○ ○ ○ ○ ○ ○ ○	<b>Milford 47500</b>
Incorporated Place <sup>1</sup>		<b>Rome 63418</b>
Census Designated Place (CDP) <sup>1</sup>		<b>Zena 84187</b>
Corporate Offset Boundary	.....	
Voting District (VTD) <sup>2</sup>	● ● ● ● ● ● ●	<b>023*</b>
Census Tract		<b>5702.01</b>
Block <sup>3</sup>		<b>1326</b>

<u>FEATURE</u>	<u>SYMBOL</u>	<u>FEATURE</u>	<u>SYMBOL</u>
Interstate or Other Highway		Perennial Stream or Shoreline	
Secondary Road		Intermittent Stream or Shoreline	
Jeep Trail, Walkway, Stairway, or Ferry		Large River or Lake	
Railroad		Glacier	
Pipeline or Power Line		Military Installation	
Ridge, Fence, or Other Physical Feature		Inset Area	
Property Line or Fence Line		Outside Subject Area	
Nonvisible Boundary or Feature Not Elsewhere Classified			

Where international, state, and/or county boundaries coincide, the map shows the boundary symbol for only the highest-ranking of these boundaries.

<sup>1</sup> A ' \* ' following a place name indicates that the place is coextensive with a MCD. A ' ° ' following an incorporated place name indicates that the place is also a false MCD. In both cases, the MCD name is shown only when it differs from the place name.

<sup>2</sup> A ' \* ' following a VTD code indicates an actual voting district. Its absence indicates that the VTD is a pseudo voting district or no information is available as to its status.

<sup>3</sup> A ' \* ' following a block number indicates that the block number is repeated elsewhere in the block.

P.L. 94-171 COUNTY BLOCK MAP (CENSUS 2000)

43 561229N  
96 606709W

43 561229N  
96 356753W

**GEOGRAPHIC AREAS LEGEND**

SYMBOL	NAME STYLE
*****	INTERNATIONAL
*****	AIR (FEDERAL)
*****	Trust Land
//////	STATE
	COUNTY
○○○○○	MINOR CIVIL DIV <sup>1</sup>
■■■■■	Incorporated Place <sup>1</sup>
■■■■■	Census Designated Place <sup>1</sup>
-----	Corporate Offset Boundary
●●●●●	Voting District <sup>2</sup>
—————	Census Tract
—————	BLOCK <sup>3</sup>

Military     Inset     Out Area

Abbreviation Reference: AIR = American Indian Reservation; Trust Land = Off-Reservation Trust Land

1 A " " following a place name indicates that the place is consecutive with a MCD. A " " indicates that the place is also a false MCD. In both cases, the MCD name is shown only when it differs from the place name.  
 2 A " " following a VTD code indicates an actual voting district. Its absence indicates that the VTD is a pseudo voting district or no information is available as to its status.  
 3 A " " following a block number indicates that the block number is repeated elsewhere in the block.

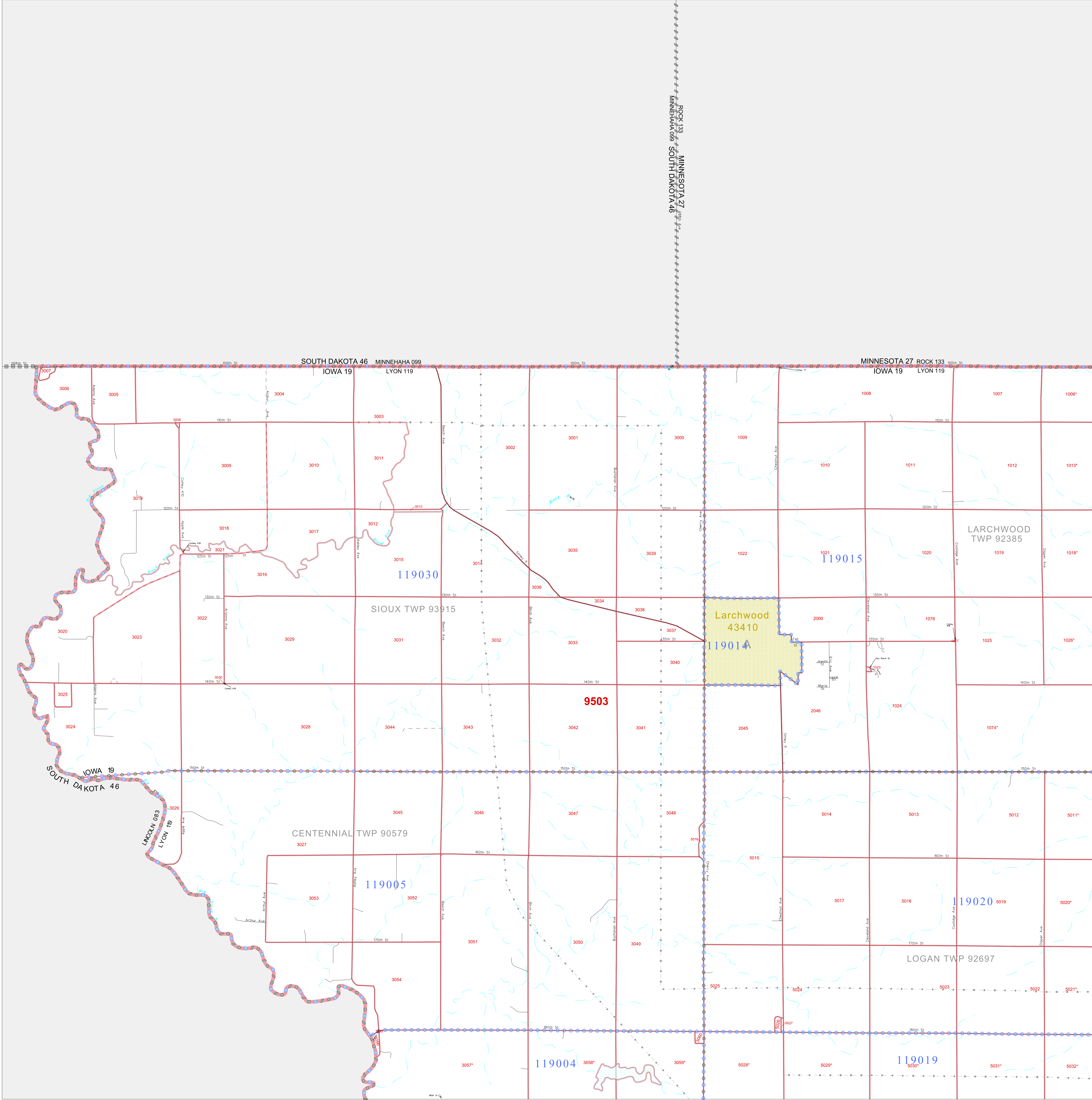

43 378900N  
96 606709W

43 378900N  
96 356753W

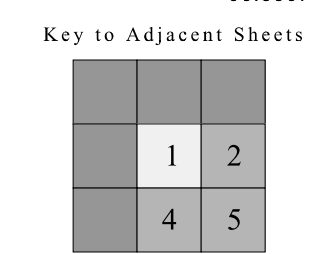
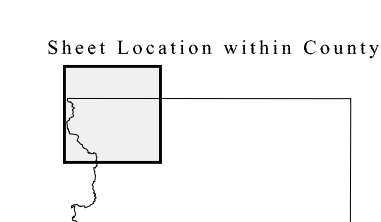
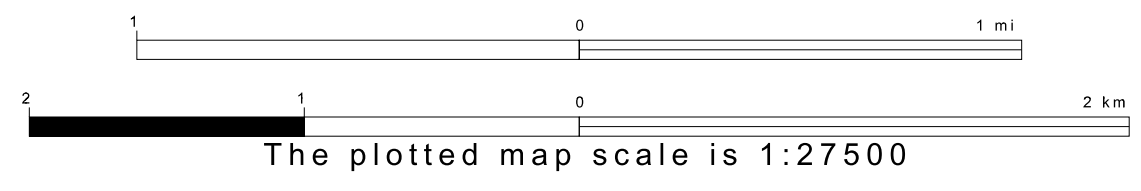
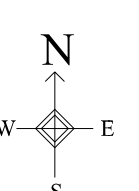

ST: Iowa (19)  
COU: Lyon (119)  
SHEET 1 OF 6 PARENT SHEETS



All legal boundaries and names are as of January 1, 2000. The boundaries shown on this map are for Census Bureau statistical data collection and tabulation purposes only; their depiction and designation for statistical purposes does not constitute a determination of jurisdictional authority or rights of ownership or entitlement. U.S. DEPARTMENT OF COMMERCE Economics and Statistics Administration U.S. Census Bureau

P. L. 94-171 COUNTY BLOCK MAP (CENSUS 2000)

43 561228N  
96 356753W

43 561228N  
96 106788W

**GEOGRAPHIC AREAS LEGEND**

SYMBOL	NAME STYLE
*****	INTERNATIONAL
*****	AIR (FEDERAL)
*****	Trust Land
*****	STATE
*****	COUNTY
*****	MINOR CIVIL DIV.
*****	Incorporated Place <sup>1</sup>
*****	Census Designated Place <sup>1</sup>
*****	Corporate Offset Boundary
*****	Voting District <sup>2</sup>
*****	Census Tract
*****	BLOCK <sup>3</sup>

Military     Inset     Out Area

Abbreviation Reference: AIR = American Indian Reservation; Trust Land = Off-Reservation Trust Land

1 A "\*" following a place name indicates that the place is coextensive with a MCD. A "-" indicates that the place differs from the MCD. In both cases, the MCD name is shown only when it differs from the place name.  
 2 A "\*" following a VTD code indicates an actual voting district. Its absence indicates that the VTD is a pseudo voting district or no information is available as to its status.  
 3 A "\*" following a block number indicates that the block number is repeated elsewhere in the block.

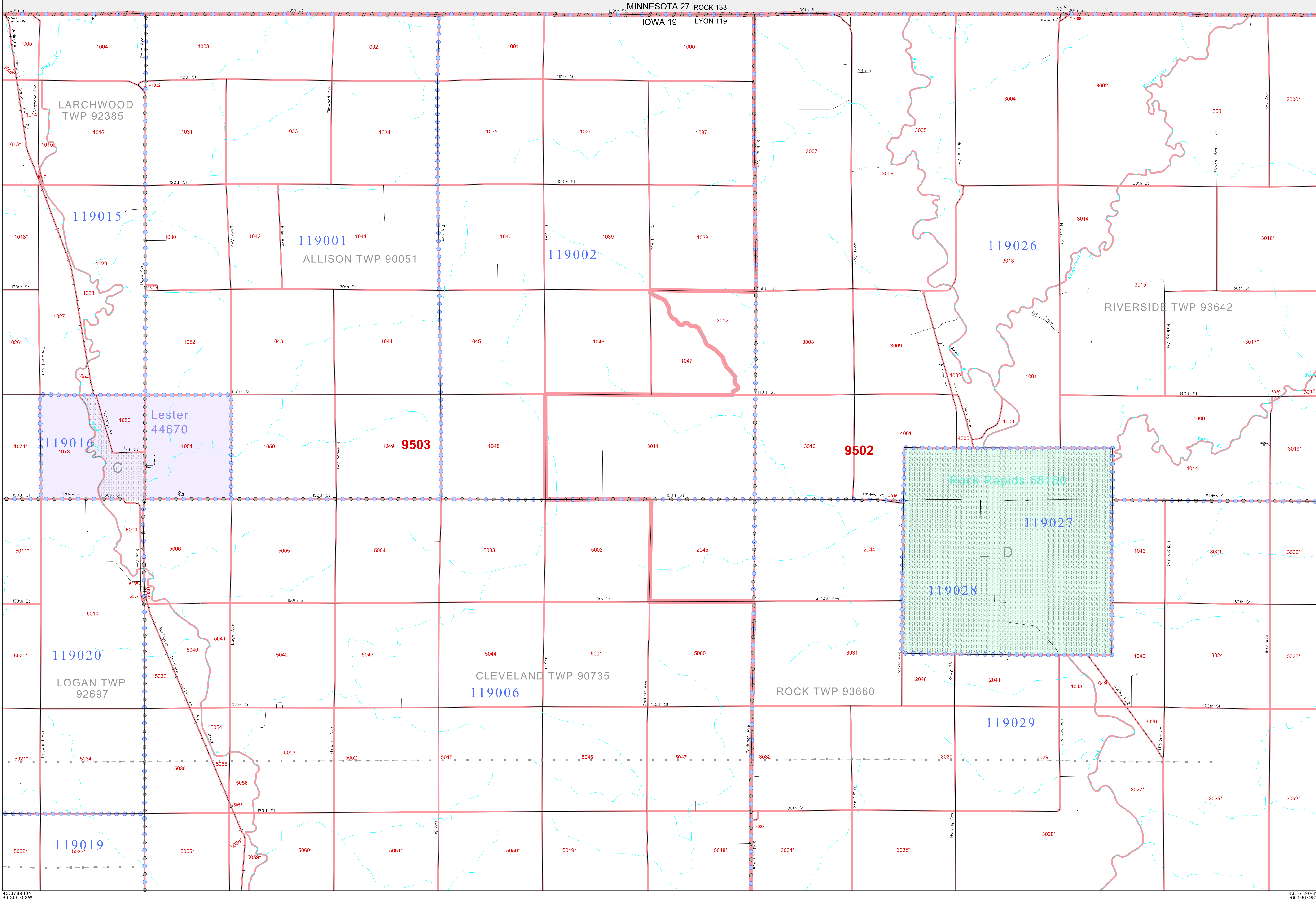

43 378900N  
96 356753W

43 378900N  
96 106788W

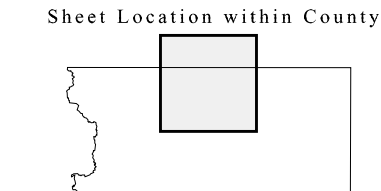
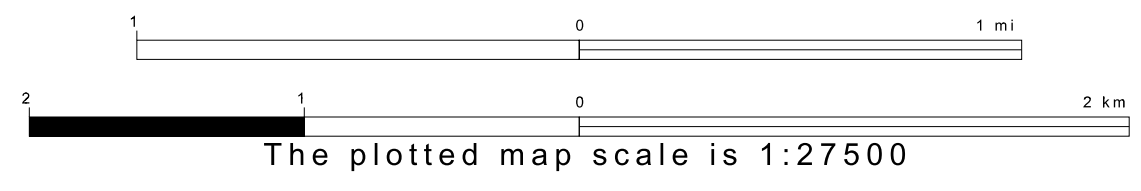
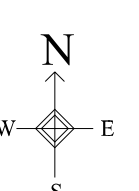

Key to Adjacent Sheets

1	2	3
4	5	6

ST: Iowa (19)  
 COU: Lyon (119)  
 SHEET 2 OF 6 PARENT SHEETS

All legal boundaries and names are as of January 1, 2000. The boundaries shown on this map are for Census Bureau statistical data collection and tabulation purposes only; their depiction and designation for statistical purposes does not constitute a determination of jurisdictional authority or rights of ownership or entitlement. U.S. DEPARTMENT OF COMMERCE Economics and Statistics Administration U.S. Census Bureau



P. L. 94-171 COUNTY BLOCK MAP (CENSUS 2000)

43 561228N  
96.106758W

43 561228N  
95.838842W

**GEOGRAPHIC AREAS LEGEND**

SYMBOL	NAME STYLE
*****	<b>INTERNATIONAL</b>
*****	<b>AIR (FEDERAL)</b>
*****	<b>Trust Land</b>
//////	<b>STATE</b>
	<b>COUNTY</b>
○○○○○	<b>MINOR CIVIL DIV<sup>1</sup></b>
■■■■■	<b>Incorporated Place<sup>1</sup></b>
■■■■■	<b>Census Designated Place<sup>1</sup></b>
.....	<b>Corporate Offset Boundary</b>
.....	<b>Voting District<sup>2</sup></b>
.....	<b>Census Tract</b>
.....	<b>BLOCK<sup>3</sup></b>

Military     Inset     Out Area

Abbreviation Reference: AIR = American Indian Reservation; Trust Land = Gift/Reservation Trust Land

1 A "\*" following a place name indicates that the place is coterminous with a MCD. A "-" indicates that the place differs from the place name.  
 2 A "\*" following a VTD code indicates an actual voting district. Its absence indicates that the VTD is a pseudo voting district or no information is available as to its status.  
 3 A "\*" following a block number indicates that the block number is repeated elsewhere in the block.

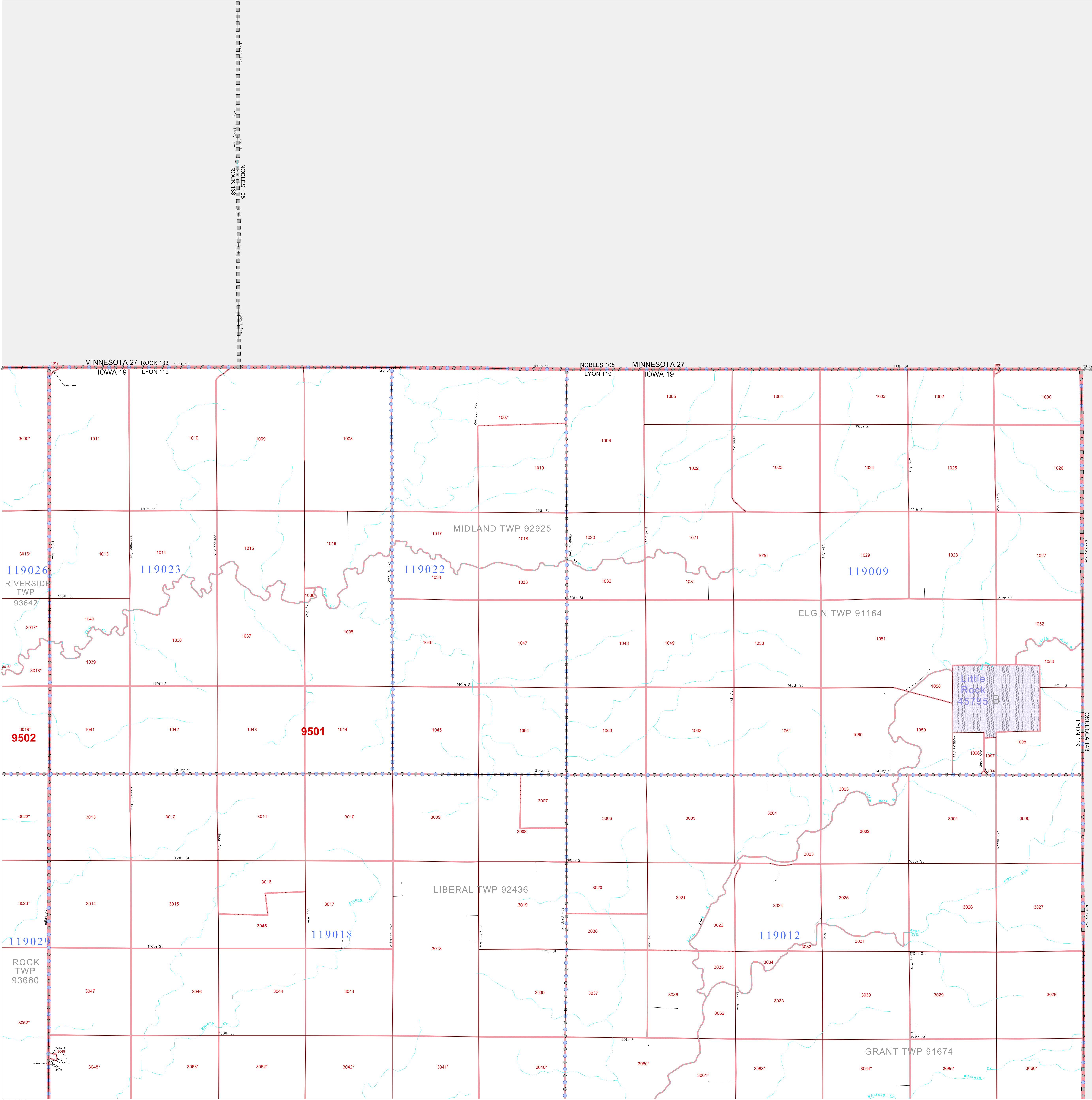

43 378900N  
96.106758W

43 378900N  
95.838842W

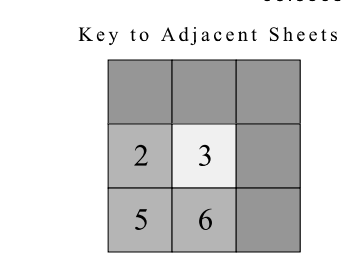
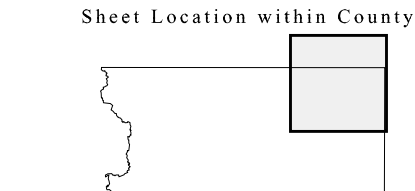
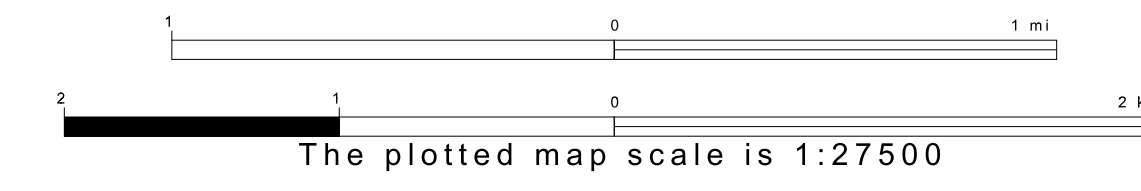
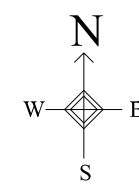

ST: Iowa (19)  
COU: Lyon (119)  
SHEET 3 OF 6 PARENT SHEETS

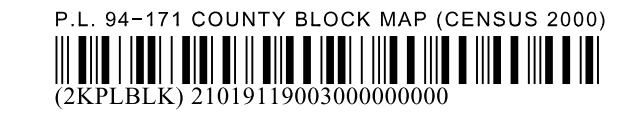

All legal boundaries and names are as of January 1, 2000. The boundaries shown on this map are for Census Bureau statistical data collection and tabulation purposes only; their depiction and designation for statistical purposes does not constitute a determination of jurisdictional authority or rights of ownership or entitlement. U.S. DEPARTMENT OF COMMERCE Economics and Statistics Administration U.S. Census Bureau

P.L. 94-171 COUNTY BLOCK MAP (CENSUS 2000)

43 378900N  
96.606709W

43 378900N  
96.606709W

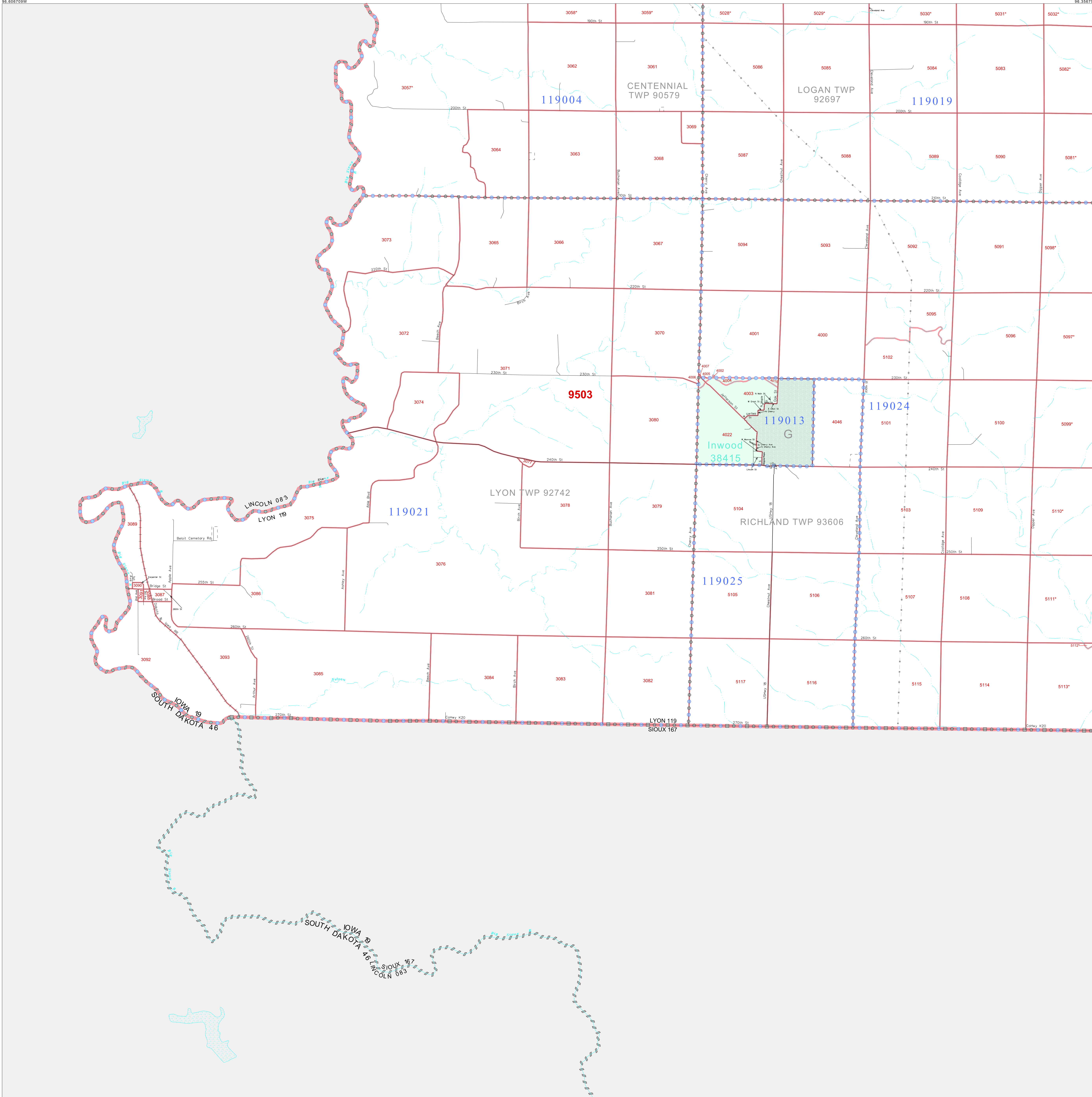

**GEOGRAPHIC AREAS LEGEND**

SYMBOL	NAME STYLE
*****	INTERNATIONAL
*****	AIR (FEDERAL)
*****	Trust Land
*****	STATE
*****	COUNTY
*****	MINOR CIVIL DIV.
*****	Incorporated Place <sup>1</sup>
*****	Census Designated Place <sup>1</sup>
*****	Corporate Offset Boundary
*****	Voting District <sup>2</sup>
*****	Census Tract
*****	BLOCK <sup>3</sup>

Military     Inset     Out Area

Abbreviation Reference: AIR = American Indian Reservation; Trust Land = Off-Reservation Trust Land

1 A " " following a place name indicates that the place is coterminous with a MCD. A " " indicates that the place differs from the MCD. In both cases, the MCD name is shown only when it differs from the place name.  
 2 A " " following a VTD code indicates an actual voting district. Its absence indicates that the VTD is a pseudo voting district or no information is available as to its status.  
 3 A " " following a block number indicates that the block number is repeated elsewhere in the block.

43 196572N  
96.606709W

43 196572N  
96.606709W

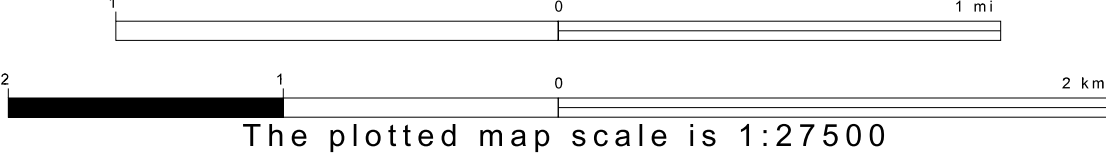
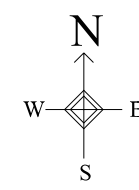

Sheet Location within County

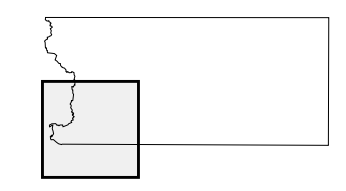

Key to Adjacent Sheets

1	2
4	5

ST: Iowa (19)  
COU: Lyon (119)  
SHEET 4 OF 6 PARENT SHEETS

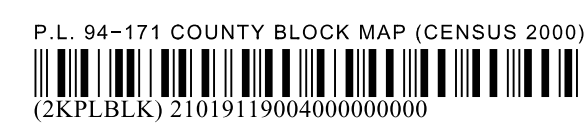

All legal boundaries and names are as of January 1, 2000. The boundaries shown on this map are for Census Bureau statistical data collection and tabulation purposes only; their depiction and designation for statistical purposes does not constitute a determination of jurisdictional authority or rights of ownership or entitlement. U.S. DEPARTMENT OF COMMERCE Economics and Statistics Administration U.S. Census Bureau

P. L. 94-171 COUNTY BLOCK MAP (CENSUS 2000)

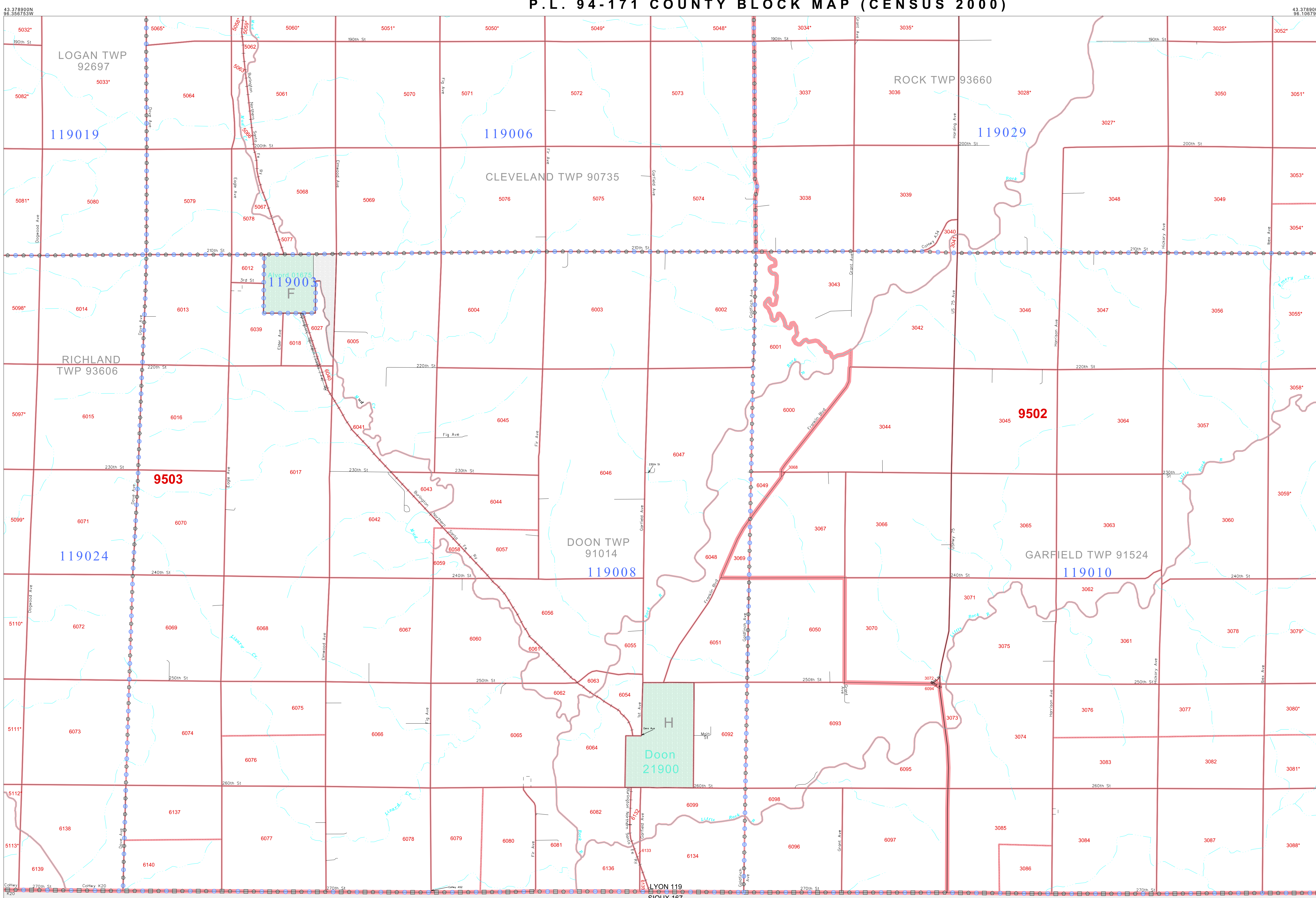

**GEOGRAPHIC AREAS LEGEND**

SYMBOL	NAME STYLE
*****	INTERNATIONAL
*****	AIR (FEDERAL)
*****	Trust Land
*****	State
*****	COUNTY
*****	MINOR CIVIL DIV.
*****	Incorporated Place <sup>1</sup>
*****	Census Designated Place <sup>2</sup>
*****	Corporate Offset Boundary
*****	Voting District <sup>3</sup>
*****	Census Tract
*****	BLOCK <sup>4</sup>

Military     Inset     Out Area

Abbreviation Reference: AIR = American Indian Reservation; Trust Land = Off-Reservation Trust Land

1 A "\*" following a place name indicates that the place is coterminous with a MCD. A "-" indicates that the place differs from the place name.  
 2 A "\*" following a CDP code indicates an actual voting district. Its absence indicates that the VTD is a pseudo voting district or no information is available as to its status.  
 3 A "\*" following a block number indicates that the block number is repeated elsewhere in the block.

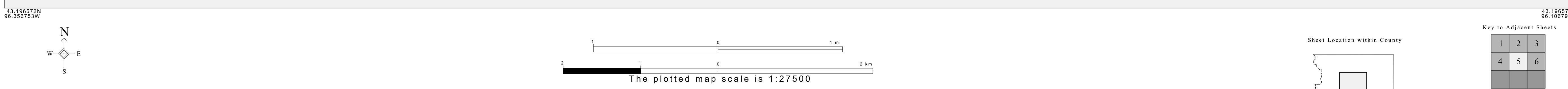

P. L. 94-171 COUNTY BLOCK MAP (CENSUS 2000)

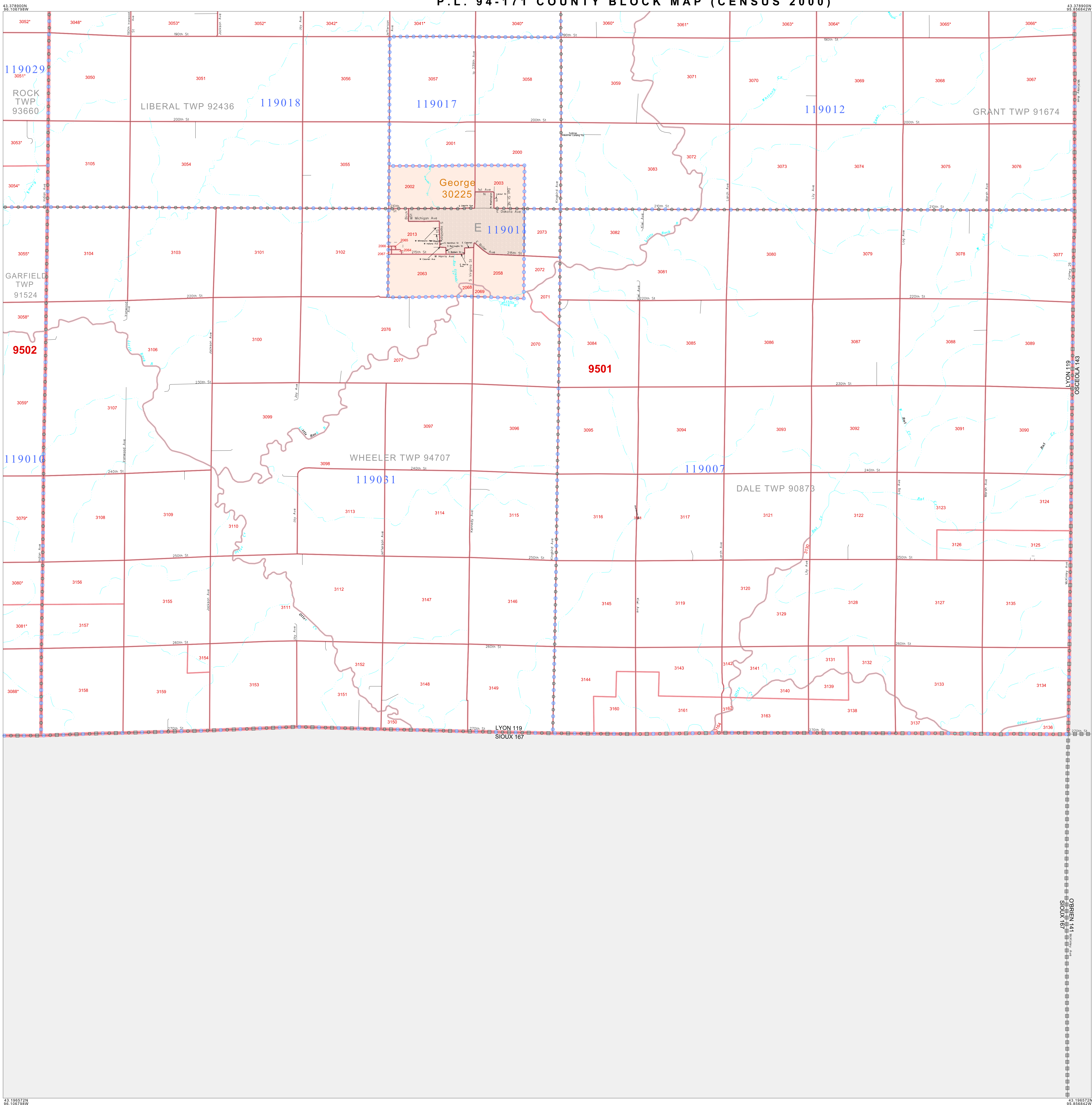

**GEOGRAPHIC AREAS LEGEND**

SYMBOL	NAME STYLE
*****	INTERNATIONAL
*****	AIR (FEDERAL)
*****	Trust Land
*****	STATE
*****	COUNTY
*****	MINOR CIVIL DIV.
*****	Incorporated Place <sup>1</sup>
*****	Census Designated Place <sup>2</sup>
*****	Corporate Offset Boundary
*****	Voting District <sup>3</sup>
*****	Census Tract

Military     Inset     Out Area  
 Abbreviation Reference: AIR = American Indian Reservation; Trust Land = Off-Reservation Trust Land  
 1 A "\*" following a place name indicates that the place is coterminous with a MCD. A "-" indicates that the place differs from the MCD. In both cases, the MCD name is shown only when it differs from the place name.  
 2 A "\*" following a CTD code indicates an actual voting district. Its absence indicates that the VTD is a pseudo voting district or no information is available as to its status.  
 3 A "\*" following a block number indicates that the block number is repeated elsewhere in the block.

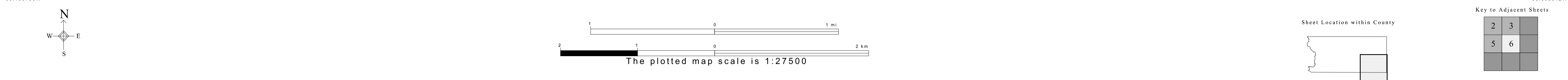

All legal boundaries and names are as of January 1, 2000. The boundaries shown on this map are for Census Bureau statistical data collection and tabulation purposes only; their depiction and designation for statistical purposes does not constitute a determination of jurisdictional authority or rights of ownership or entitlement. U.S. DEPARTMENT OF COMMERCE Economics and Statistics Administration U.S. Census Bureau



P. L. 94-171 COUNTY BLOCK MAP (CENSUS 2000)

**GEOGRAPHIC AREAS LEGEND**

SYMBOL	NAME STYLE
*****	<b>INTERNATIONAL</b>
*****	<b>AIR (FEDERAL)</b>
*****	<b>Trust Land</b>
//////	<b>STATE</b>
	<b>COUNTY</b>
○○○○○	<b>MINOR CIVIL DIV.</b>
■■■■■	<b>Incorporated Place<sup>1</sup></b>
■■■■■	<b>Census Designated Place<sup>1</sup></b>
.....	<b>Corporate Offset Boundary</b>
●●●●●	<b>Voting District<sup>2</sup></b>
—————	<b>Census Tract</b>
—————	<b>BLOCK<sup>3</sup></b>

Military     Inset     Out Area

Abbreviation Reference: AIR = American Indian Reservation; Trust Land = Gift/Recreation Trust Land

1 A " " following a place name indicates that the place is coterminous with a MCD. A " " indicates that the place differs from the MCD. In both cases, the MCD name is shown only when it differs from the place name.  
 2 A " " following a VTD code indicates an actual voting district. Its absence indicates that the VTD is a pseudo voting district or no information is available as to its status.  
 3 A " " following a block number indicates that the block number is repeated elsewhere in the block.

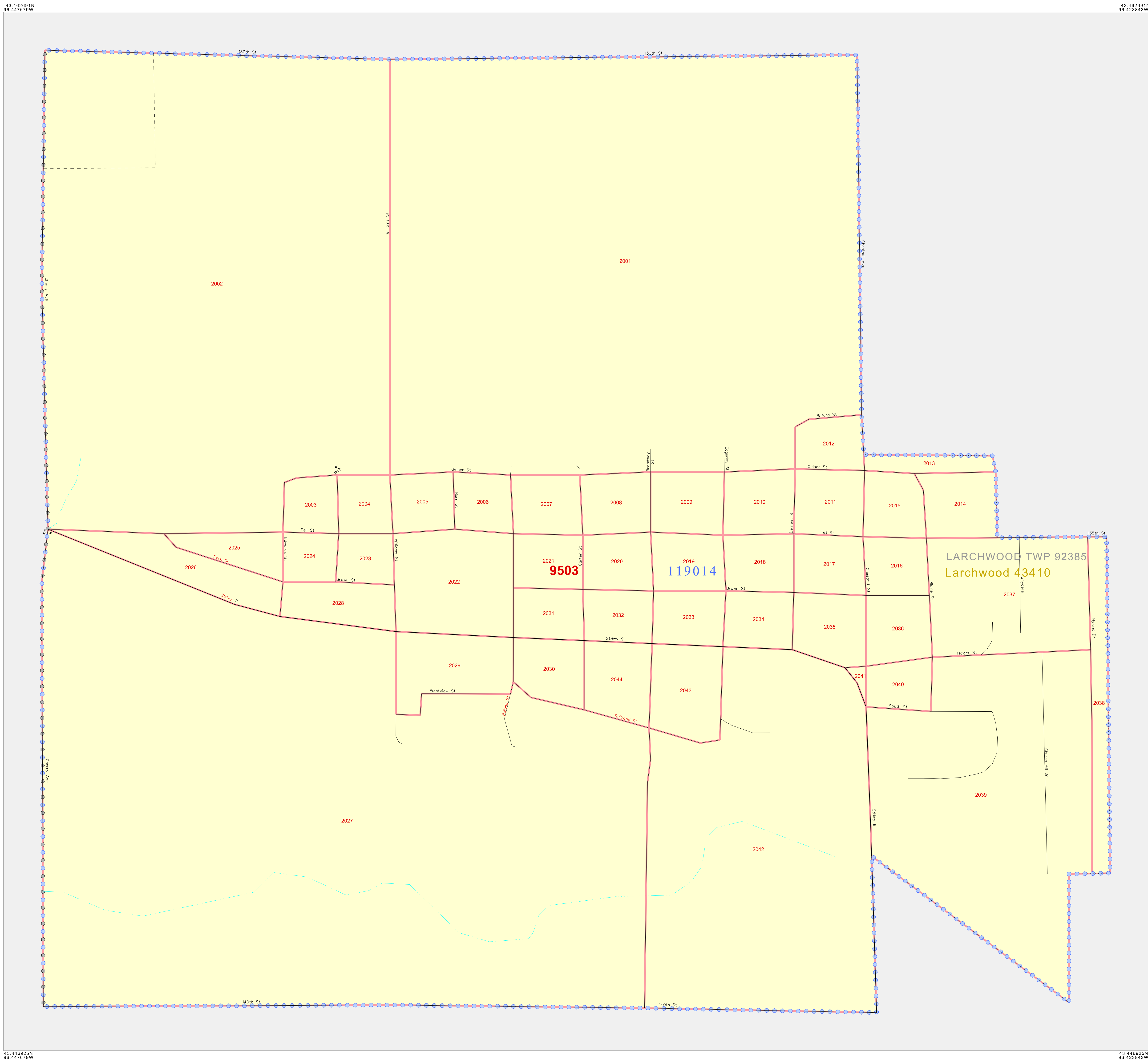

43 448925N 96 447679W    43 462891N 96 423643W    43 448925N 96 423643W

N  
 W — E  
 S

0 100 200 300 ft  
 0 1 2 km  
 The plotted map scale is 1:3000

Sheet Location within County

Key to Adjacent Sheets

A01

ST: Iowa (19)  
 COU: Lyon (119)  
 INSET SHEET A01

All legal boundaries and names are as of January 1, 2000.  
 The boundaries shown on this map are for Census Bureau statistical data collection and tabulation purposes only; their depiction and designation for statistical purposes does not constitute a determination of jurisdictional authority or rights of ownership or entitlement.  
 U.S. DEPARTMENT OF COMMERCE Economics and Statistics Administration U.S. Census Bureau

P. L. 94-171 COUNTY BLOCK MAP (CENSUS 2000)

**GEOGRAPHIC AREAS LEGEND**

SYMBOL	NAME STYLE
*****	INTERNATIONAL
*****	AIR (FEDERAL)
*****	Trust Land
///////	STATE
	COUNTY
○○○○○	MINOR CIVIL DIV <sup>1</sup>
■■■■■	Incorporated Place <sup>1</sup>
■■■■■	Census Designated Place <sup>1</sup>
.....	Corporate Offset Boundary
.....	Voting District <sup>2</sup>
.....	Census Tract
.....	BLOCK <sup>3</sup>

Military  Inset  Out Area

Abbreviation Reference: AIR = American Indian Reservation; Trust Land = Off-Reservation Trust Land

1 A "\*" following a place name indicates that the place is coterminous with a MCD. A "-" indicates that the place differs from the MCD. In both cases, the MCD name is shown only when it differs from the place name.  
 2 A "\*" following a VTD code indicates an actual voting district. Its absence indicates that the VTD is a pseudo voting district or no information is available as to its status.  
 3 A "\*" following a block number indicates that the block number is repeated elsewhere in the block.

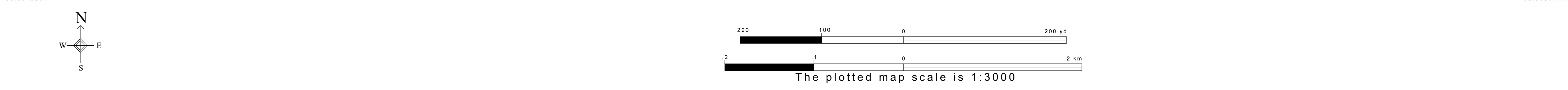
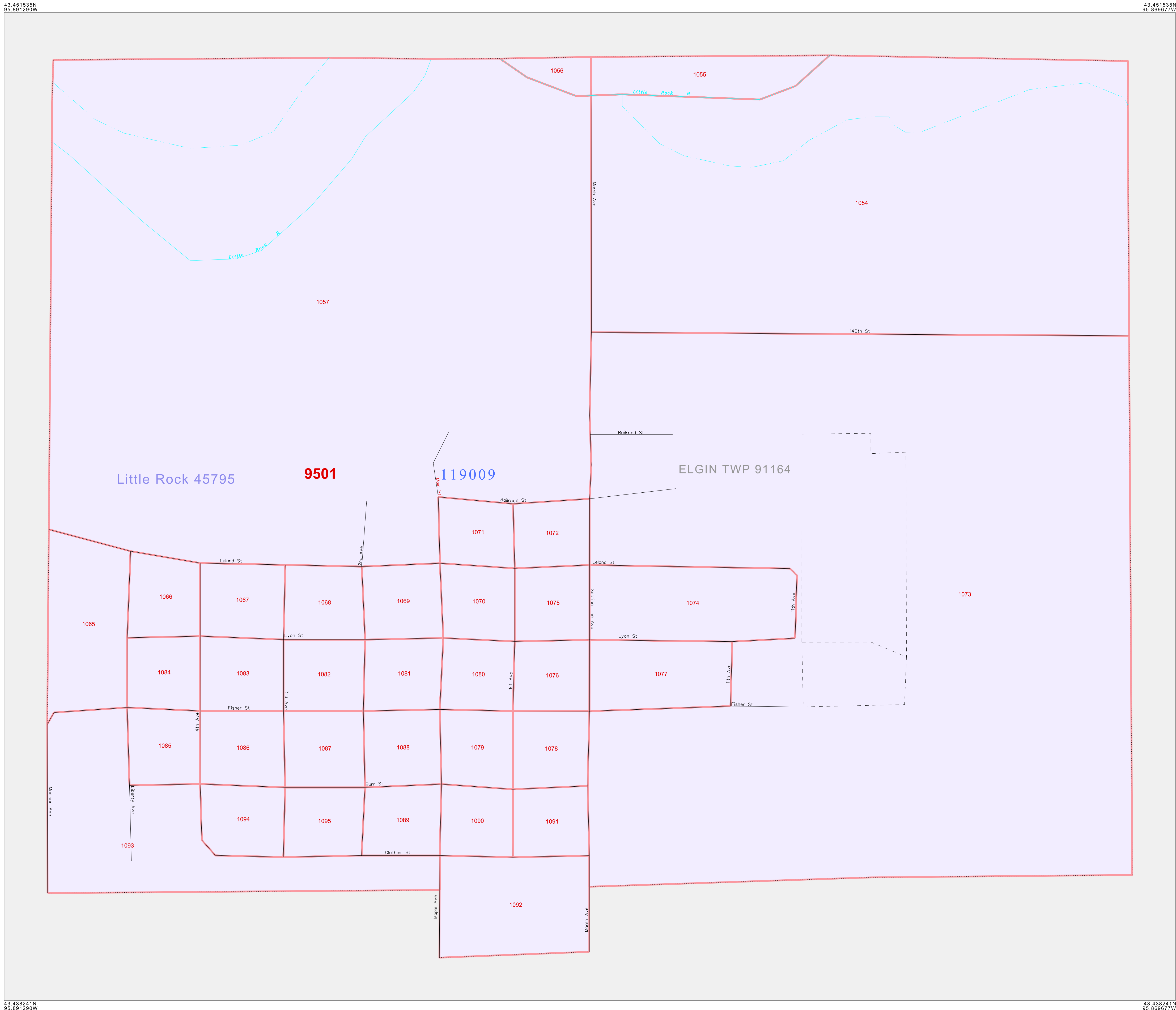

Sheet Location within County

Key to Adjacent Sheets

	<b>B01</b>	

ST: Iowa (19)  
 COU: Lyon (119)  
 INSET SHEET B01

P.L. 94-171 COUNTY BLOCK MAP (CENSUS 2000)  
 (CKPLBLK)210191366010000000

All legal boundaries and names are as of January 1, 2000. The boundaries shown on this map are for Census Bureau statistical data collection and tabulation purposes only; their depiction and designation for statistical purposes does not constitute a determination of jurisdictional authority or rights of ownership or entitlement. U.S. DEPARTMENT OF COMMERCE Economics and Statistics Administration U.S. Census Bureau

P.L. 94-171 COUNTY BLOCK MAP (CENSUS 2000)

**GEOGRAPHIC AREAS LEGEND**

SYMBOL	NAME STYLE
*****	INTERNATIONAL
*****	AIR (FEDERAL)
*****	Trust Land
//////	STATE
□□□□	COUNTY
○	MINOR CIVIL DIV. <sup>1</sup>
■	Incorporated Place <sup>1</sup>
■	Census Designated Place <sup>1</sup>
.....	Corporate Offset Boundary
●●●●	Voting District <sup>2</sup>
—	Census Tract
—	BLOCK <sup>3</sup>

Military     Inset     Out Area

Abbreviation Reference: AIR = American Indian Reservation; Trust Land = Off-Reservation Trust Land

1 A "\*" following a place name indicates that the place is coterminous with a MCD. A "-" indicates that the place differs from the MCD. In both cases, the MCD name is shown only when it differs from the place name.  
 2 A "\*" following a VTD code indicates an actual voting district. Its absence indicates that the VTD is a pseudo voting district or no information is available as to its status.  
 3 A "\*" following a block number indicates that the block number is repeated elsewhere in the block.

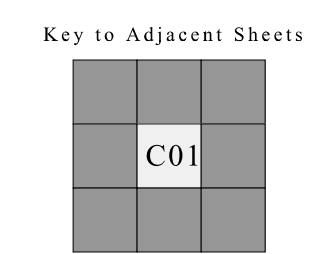
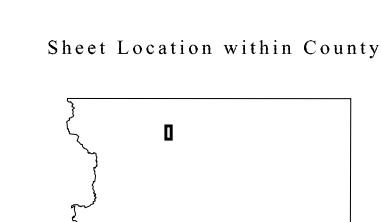
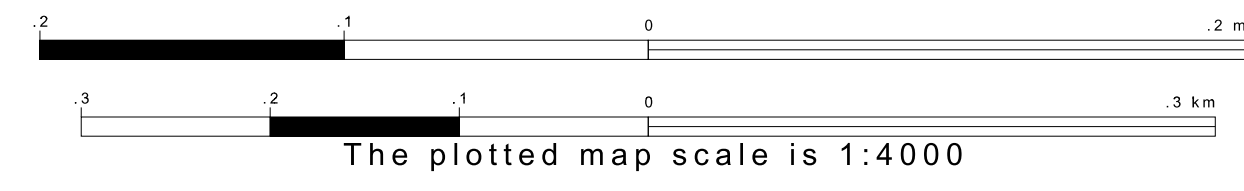
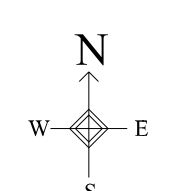
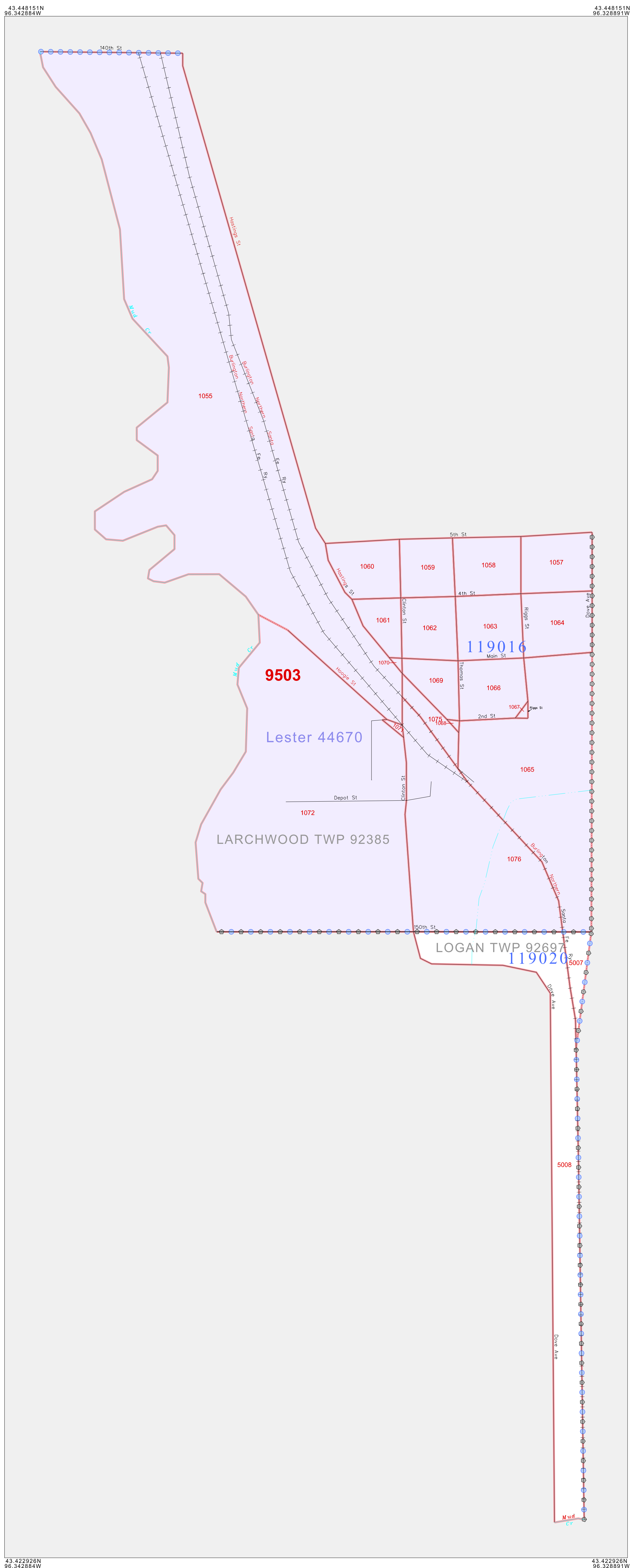

ST: Iowa (19)  
 COU: Lyon (119)  
 INSET SHEET C01

All legal boundaries and names are as of January 1, 2000. The boundaries shown on this map are for Census Bureau statistical data collection and tabulation purposes only; their depiction and designation for statistical purposes does not constitute a determination of jurisdictional authority or rights of ownership or entitlement. U.S. DEPARTMENT OF COMMERCE Economics and Statistics Administration U.S. Census Bureau



P. L. 94-171 COUNTY BLOCK MAP (CENSUS 2000)

**GEOGRAPHIC AREAS LEGEND**

SYMBOL	NAME STYLE
*****	INTERNATIONAL
*****	AIR (FEDERAL)
*****	Trust Land
///////	STATE
	COUNTY
o-o-o-o-o	MINOR CIVIL DIV <sup>1</sup>
■ ■ ■ ■ ■	Incorporated Place <sup>1</sup>
■ ■ ■ ■ ■	Census Designated Place <sup>1</sup>
.....	Corporate Offset Boundary
.....	Voting District <sup>2</sup>
.....	Census Tract
.....	BLOCK <sup>3</sup>
.....	Military
.....	Inset
.....	Out Area

Abbreviation Reference: AIR = American Indian Reservation; Trust Land = Off-Reservation Trust Land

1 A "\*" following a place name indicates that the place is coterminous with a MCD. A "-" indicates that the place differs from the MCD. In both cases, the MCD name is shown only when it differs from the place name.

2 A "\*" following a VTD code indicates an actual voting district. Its absence indicates that the VTD is a pseudo voting district or no information is available as to its status.

3 A "\*" following a block number indicates that the block number is repeated elsewhere in the block.

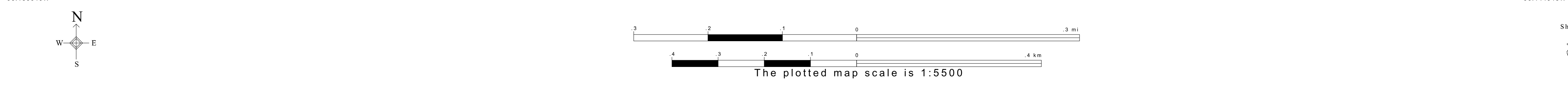
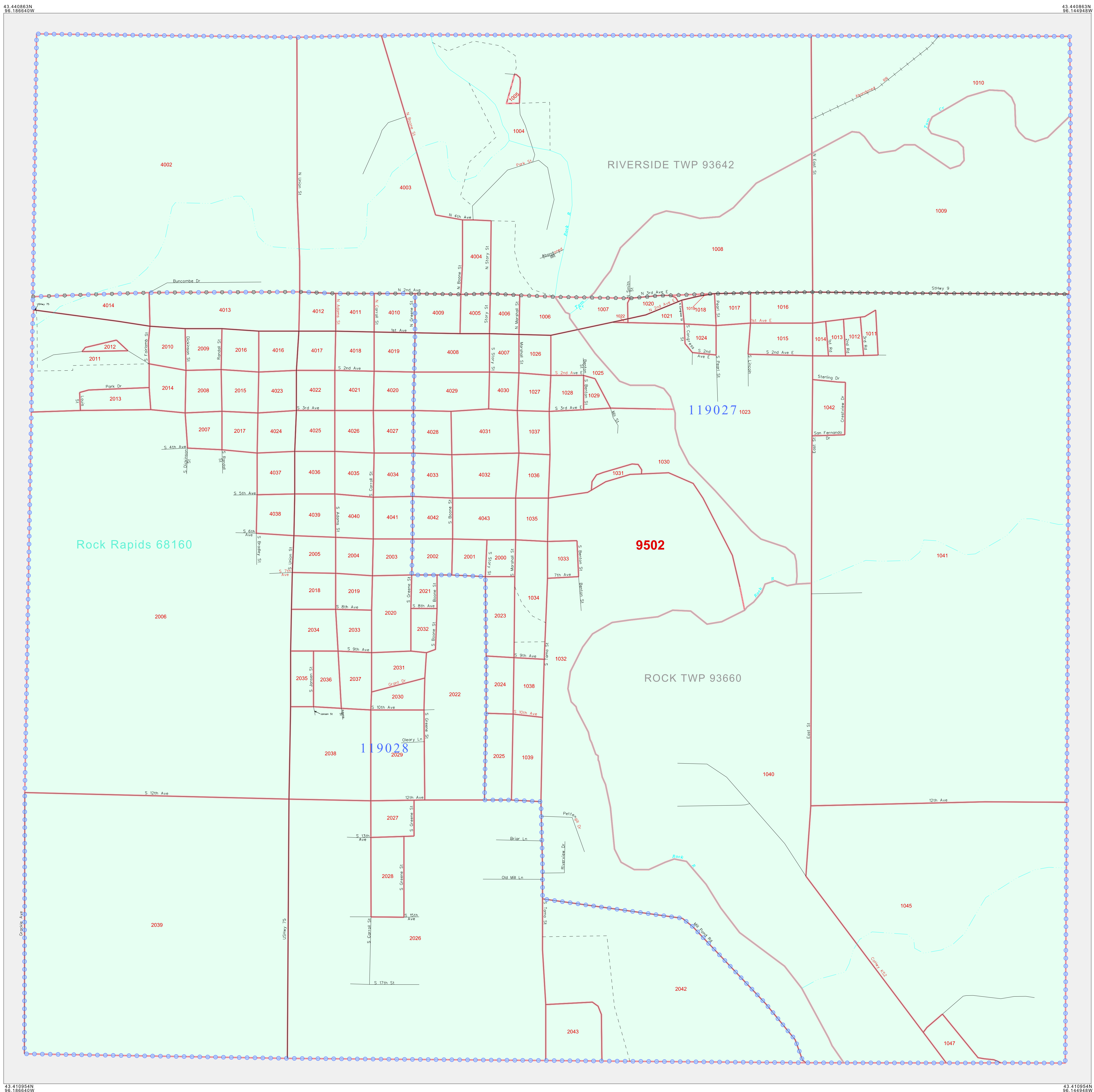

Sheet Location within County: [Map of Lyon County with sheet D01 highlighted]

Key to Adjacent Sheets: [Grid showing D01 in the center]

ST: Iowa (19)  
 COU: Lyon (119)  
 INSET SHEET D01

All legal boundaries and names are as of January 1, 2000. The boundaries shown on this map are for Census Bureau statistical data collection and tabulation purposes only; their depiction and designation for statistical purposes does not constitute a determination of jurisdictional authority or rights of ownership or entitlement. U.S. DEPARTMENT OF COMMERCE Economics and Statistics Administration U.S. Census Bureau

P. L. 94-171 COUNTY BLOCK MAP (CENSUS 2000)

**GEOGRAPHIC AREAS LEGEND**

SYMBOL	NAME STYLE
*****	INTERNATIONAL
*****	AIR (FEDERAL)
*****	Trust Land
//////	STATE
	COUNTY
o-o-o-o-o	MINOR CIVIL DIV <sup>1</sup>
Yellow	Incorporated Place <sup>1</sup>
Light Blue	Census Designated Place <sup>1</sup>
Red Dotted	Corporate Offset Boundary
Blue Dotted	Voting District <sup>2</sup>
Red	Census Tract
Red	BLOCK <sup>3</sup>

Military  Inset  Out Area

Abbreviation Reference: AIR = American Indian Reservation; Trust Land = Gift/Reservation Trust Land

1 A " " following a place name indicates that the place is coterminous with a MCD. A " " indicates that the place differs from the MCD. In both cases, the MCD name is shown only when it differs from the place name.  
 2 A " " following a VTD code indicates an actual voting district. Its absence indicates that the VTD is a pseudo voting district or no information is available as to its status.  
 3 A " " following a block number indicates that the block number is repeated elsewhere in the block.

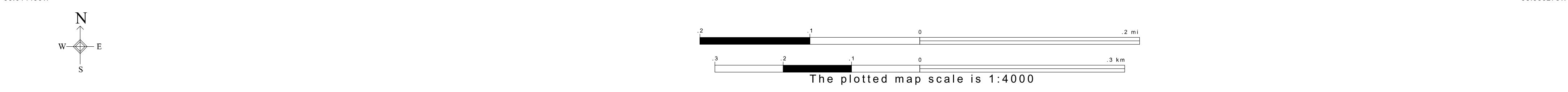
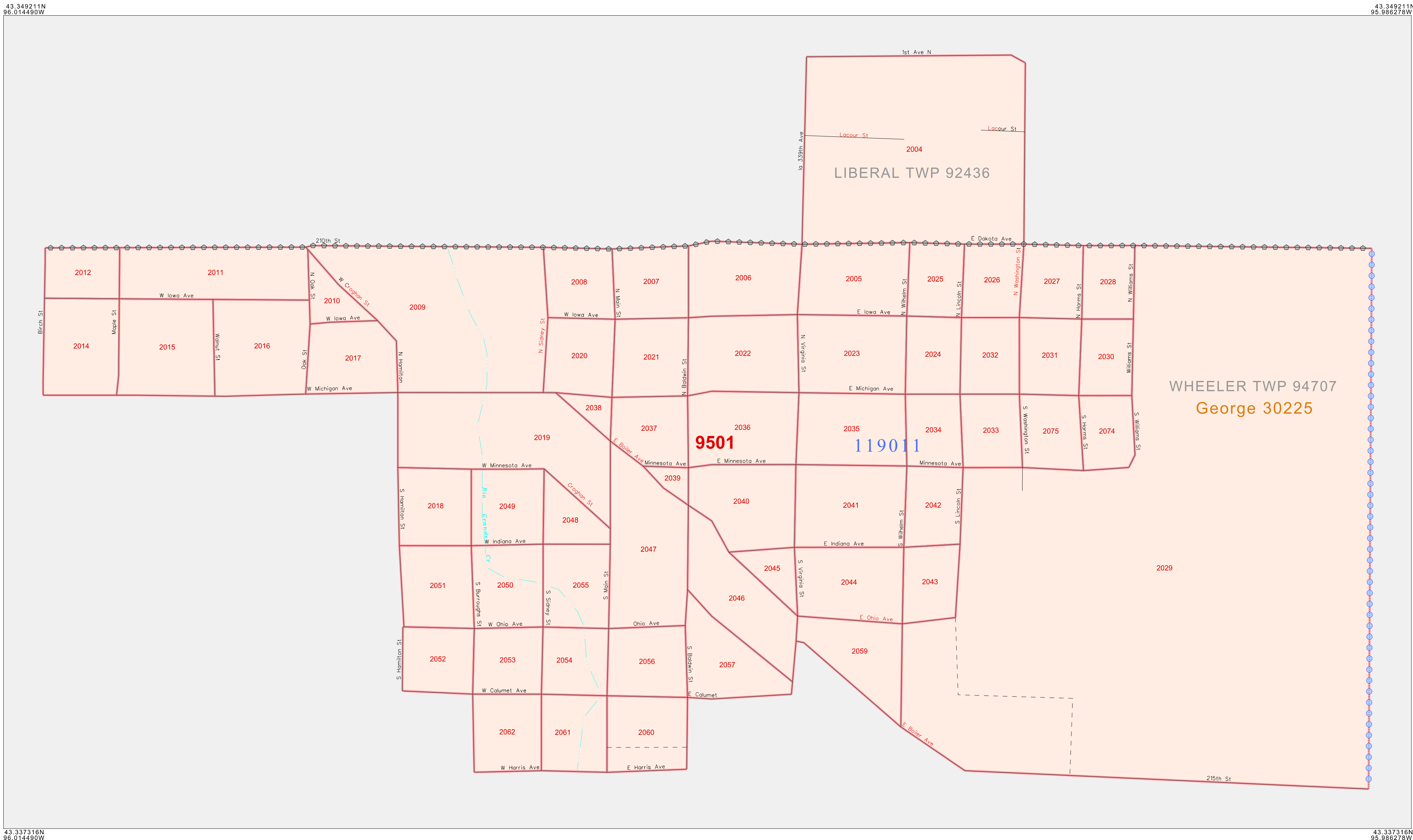

All legal boundaries and names are as of January 1, 2000. The boundaries shown on this map are for Census Bureau statistical data collection and tabulation purposes only; their depiction and designation for statistical purposes does not constitute a determination of jurisdictional authority or rights of ownership or entitlement. U.S. DEPARTMENT OF COMMERCE Economics and Statistics Administration U.S. Census Bureau

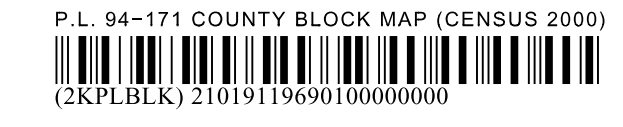

P.L. 94-171 COUNTY BLOCK MAP (CENSUS 2000)

**GEOGRAPHIC AREAS LEGEND**

SYMBOL	NAME STYLE
*****	INTERNATIONAL
*****	AIR (FEDERAL)
*****	Trust Land
//////	STATE
	COUNTY
o-o-o-o	MINOR CIVIL DIV.
Yellow	Incorporated Place <sup>1</sup>
Light Green	Census Designated Place <sup>1</sup>
Red Dashed	Corporate Offset Boundary
Blue Dotted	Voting District <sup>2</sup>
Red Solid	Census Tract
Blue Dotted	BLOCK <sup>3</sup>

Military     Inset     Out Area

Abbreviation Reference: AIR = American Indian Reservation; Trust Land = Gift/Reservation Trust Land

1 A "\*" following a place name indicates that the place is coterminous with a MCD. A "-" indicates that the place differs from the MCD. In both cases, the MCD name is shown only when it differs from the place name.

2 A "\*" following a VTD code indicates an actual voting district. Its absence indicates that the VTD is a pseudo voting district or no information is available as to its status.

3 A "\*" following a block number indicates that the block number is repeated elsewhere in the block.

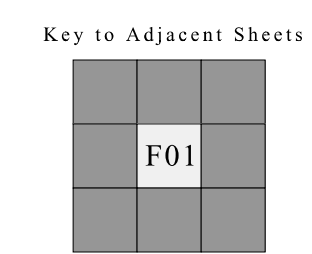
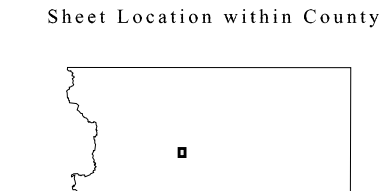
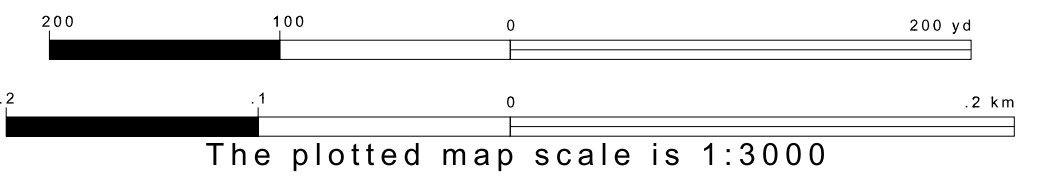
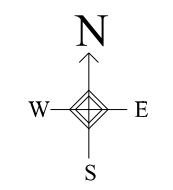
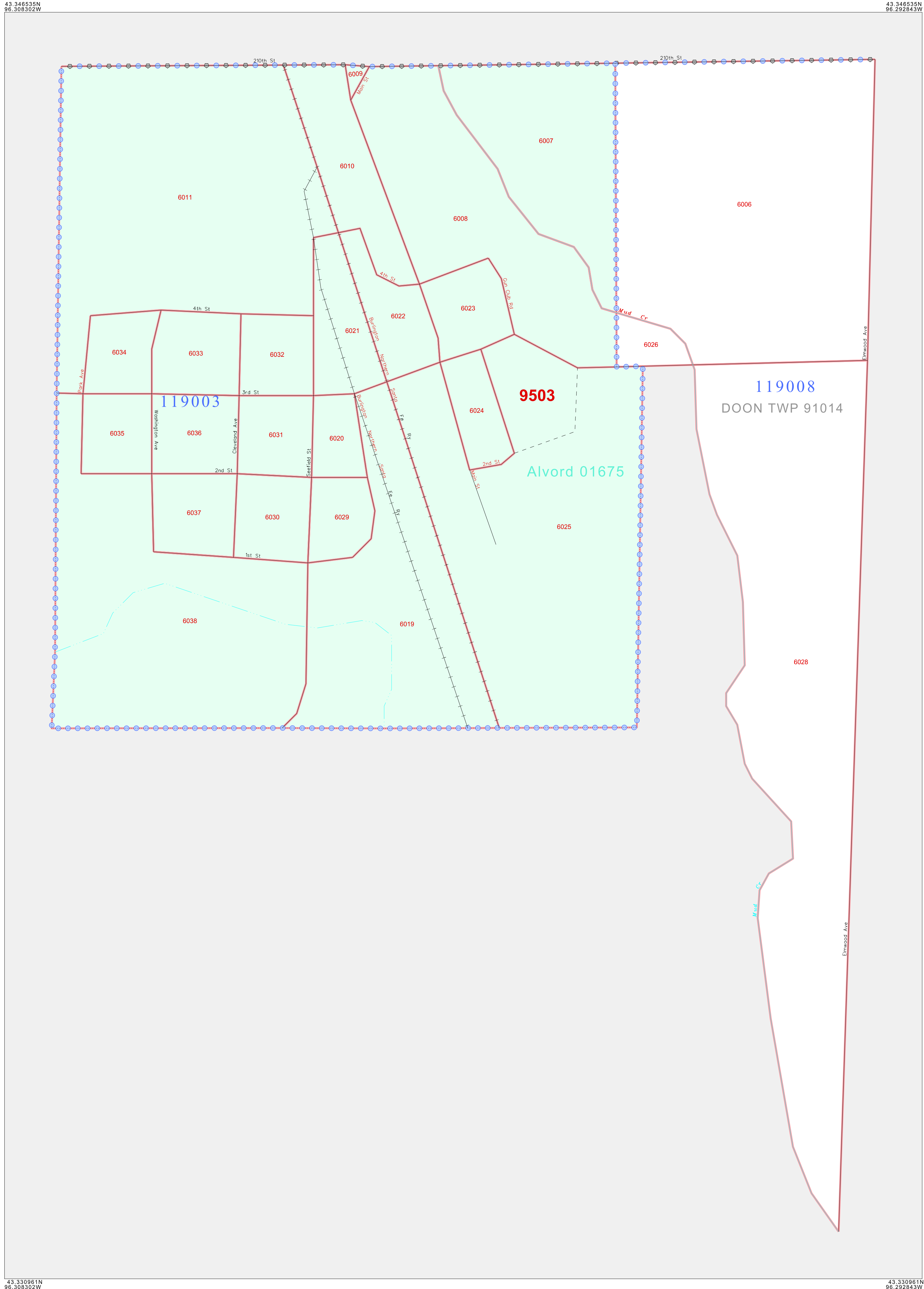

ST: Iowa (19)  
 COU: Lyon (119)  
 INSET SHEET F01

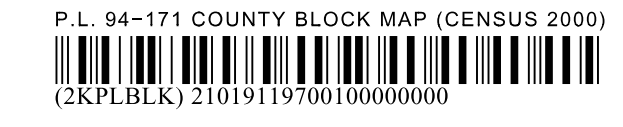

All legal boundaries and names are as of January 1, 2000. The boundaries shown on this map are for Census Bureau statistical data collection and tabulation purposes only; their depiction and designation for statistical purposes does not constitute a determination of jurisdictional authority or rights of ownership or entitlement. U.S. DEPARTMENT OF COMMERCE Economics and Statistics Administration U.S. Census Bureau

P. L. 94-171 COUNTY BLOCK MAP (CENSUS 2000)

**GEOGRAPHIC AREAS LEGEND**

SYMBOL	NAME STYLE
*****	INTERNATIONAL
*****	AIR (FEDERAL)
*****	Trust Land
///////	STATE
	COUNTY
○○○○○	MINOR CIVIL DIV. <sup>1</sup>
■■■■■	Incorporated Place <sup>1</sup>
■■■■■	Census Designated Place <sup>1</sup>
.....	Corporate Offset Boundary
.....	Voting District <sup>2</sup>
.....	Census Tract
.....	BLOCK <sup>3</sup>

Military     Inset     Out Area

Abbreviation Reference: AIR = American Indian Reservation; Trust Land = Gift/Preservation Trust Land

1 A " " following a place name indicates that the place is consecutive with a MCD. A " " indicates that the place is after a false MCD. In both cases, the MCD name is shown only when it differs from the place name.  
 2 A " " following a VTD code indicates an actual voting district. Its absence indicates that the VTD is a pseudo voting district or no information is available as to its status.  
 3 A " " following a block number indicates that the block number is repeated elsewhere in the block.

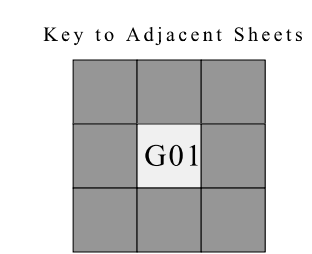
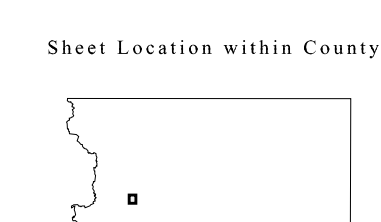
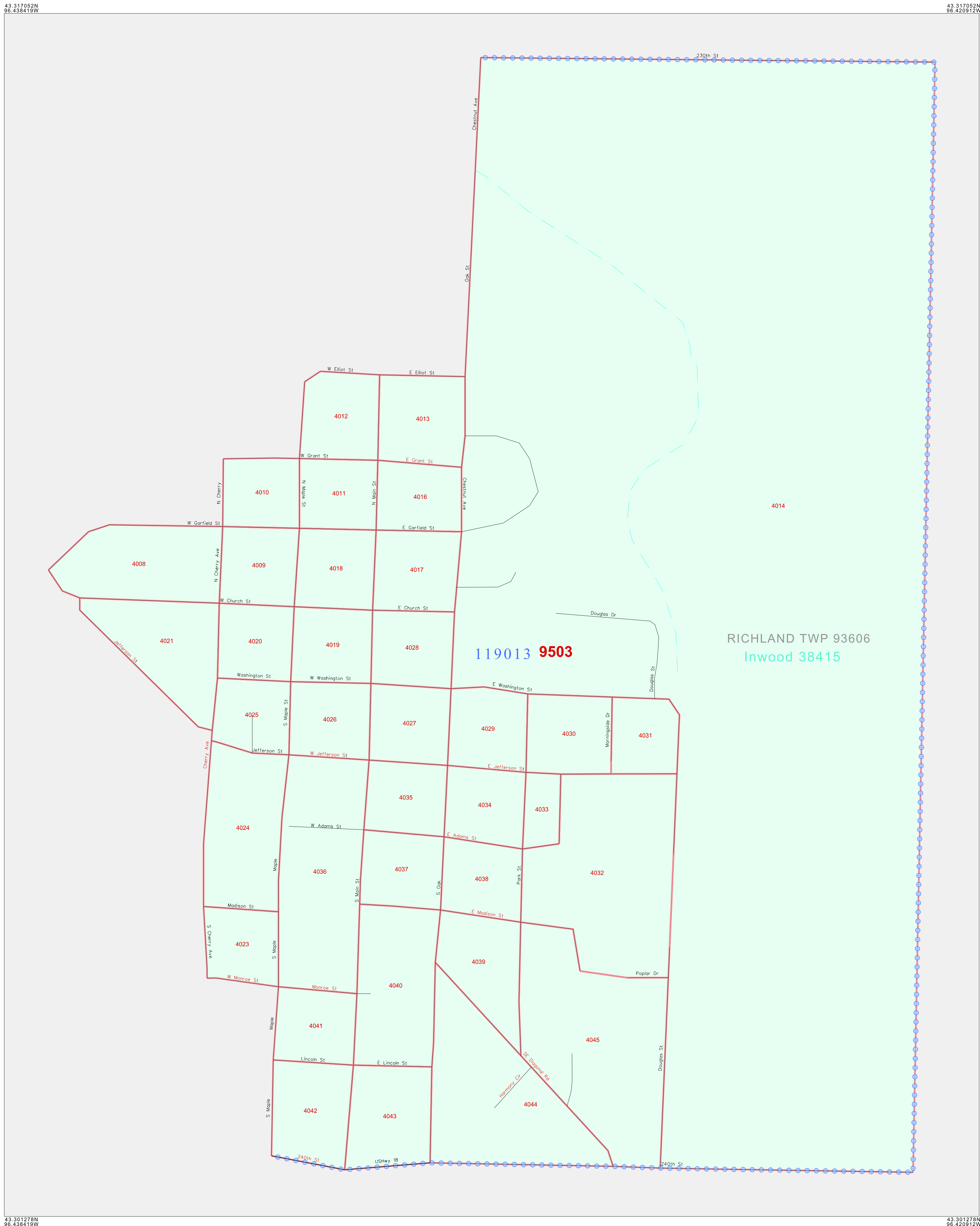

ST: Iowa (19)  
 COU: Lyon (119)  
 INSET SHEET G01



All legal boundaries and names are as of January 1, 2000.  
 The boundaries shown on this map are for Census Bureau statistical data collection and tabulation purposes only; their depiction and designation for statistical purposes does not constitute a determination of jurisdictional authority or rights of ownership or entitlement.  
 U.S. DEPARTMENT OF COMMERCE Economics and Statistics Administration U.S. Census Bureau

P. L. 94-171 COUNTY BLOCK MAP (CENSUS 2000)

**GEOGRAPHIC AREAS LEGEND**

SYMBOL	NAME STYLE
*****	INTERNATIONAL
*****	AIR (FEDERAL)
*****	Trust Land
//////	STATE
	COUNTY
o-o-o-o-o	MINOR CIVIL DIV <sup>1</sup>
-----	Incorporated Place <sup>1</sup>
-----	Census Designated Place <sup>1</sup>
-----	Corporate Offset Boundary
o-o-o-o-o	Voting District <sup>2</sup>
-----	Census Tract
-----	BLOCK <sup>3</sup>

Military     Inset     Out Area

Abbreviation Reference: AIR = American Indian Reservation; Trust Land = Gift/Reservation Trust Land

1 A "\*" following a place name indicates that the place is coterminous with a MCD. A "-" indicates that the place differs from the MCD. In both cases, the MCD name is shown only when it differs from the place name.  
 2 A "\*" following a VTD code indicates an actual voting district. Its absence indicates that the VTD is a pseudo voting district or no information is available as to its status.  
 3 A "\*" following a block number indicates that the block number is repeated elsewhere in the block.

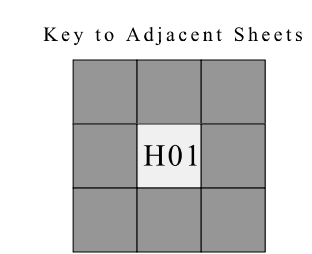
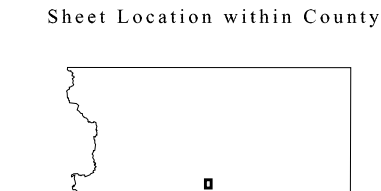
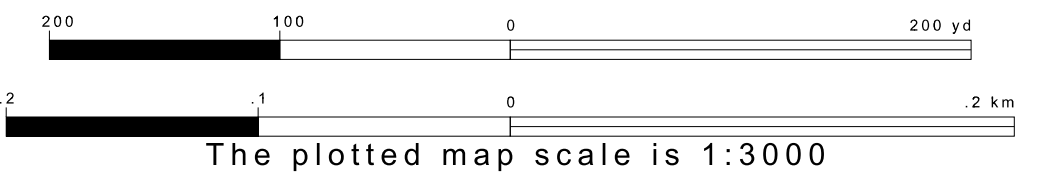
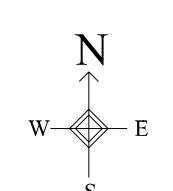
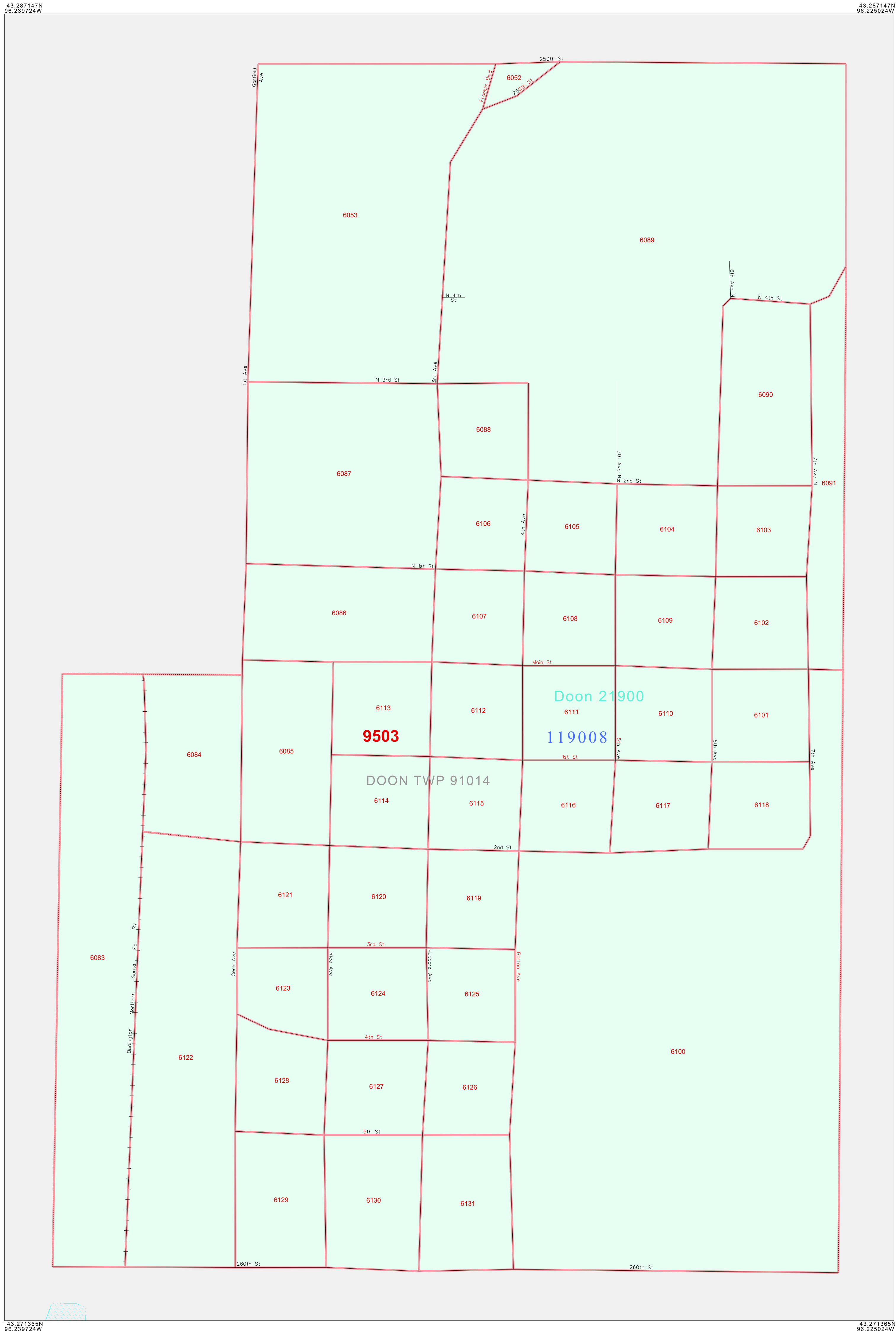

ST: Iowa (19)  
 COU: Lyon (119)  
 INSET SHEET H01



All legal boundaries and names are as of January 1, 2000.  
 The boundaries shown on this map are for Census Bureau statistical data collection and tabulation purposes only; their depiction and designation for statistical purposes does not constitute a determination of jurisdictional authority or rights of ownership or entitlement.  
 U.S. DEPARTMENT OF COMMERCE Economics and Statistics Administration U.S. Census Bureau